

HTE# 06-5-14573

IMPROVEMENT PERMIT 22887

Be it ordained by the Harnett County Board of Health as follows: Section III, Item B. "No person shall begin construction of any building at which a septic tank system is to be used for disposal of sewage without first obtaining a written permit from the Harnett County Health Department."

Name: (owner) CMA Builders LLC New Installation Septic Tank Repair

Property Location: SR# 1403 Harnett Central Nitrification Line Expansion

Subdivision PEARL MEADOW Lot # 21

Tax ID# _____ Quadrant # _____

Number of Bedrooms Proposed: 3 BRN 360 690 Lot Size: .347

Basement with Plumbing: Garage:

Water Supply: Well Public Community

Distance From Well: 50' ft.

Following is the minimum specifications for sewage disposal system on above captioned property. Subject to final approval.

Type of system: Conventional Other 25% Reduction System

Size of tank: Septic Tank: 1000 gallons Pump Tank: _____ gallons

Subsurface No. of exact length width of depth of
Drainage Field ditches 4 ft. of each ditch 75 ft. ditches 3 ft. ditches 30-18 in.

French Drain Required: - Linear feet

Date: 4-21-06

This permit is subject to revocation if site plans or intended use change.

PERMIT EXPIRES 5 YEARS FROM ABOVE DATE

*Lot is VERY TIGHT, 97' along BACK P/L - 10' off each LINE leaves 77' of AVAILABLE space TAKE NOTE Before installation

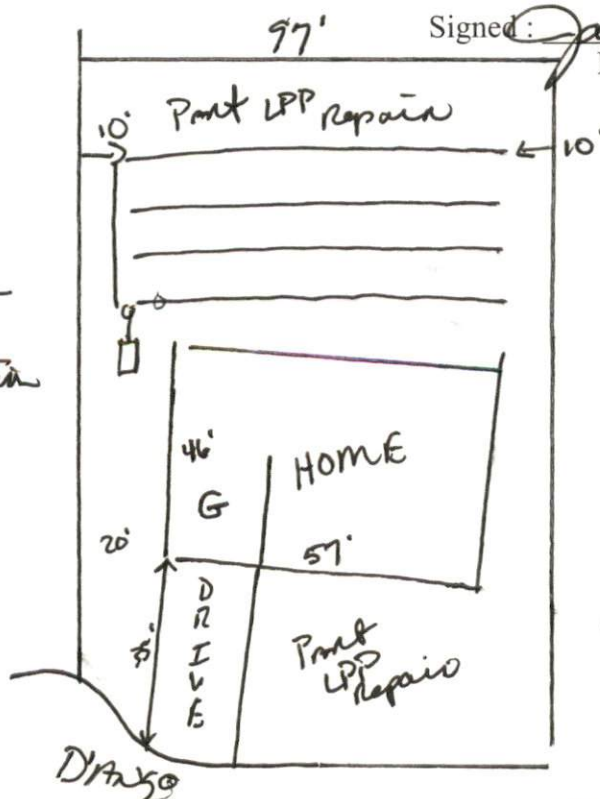

Signed: James E. Montano
Environmental Health Specialist

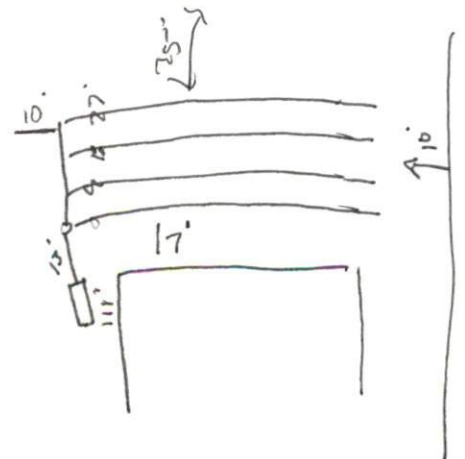

HARNETT COUNTY DEPARTMENT OF PUBLIC HEALTH AUTHORIZATION TO CONSTRUCT

Authorization is hereby given to construct a wastewater system to the specifications described by Harnett County Department of Public Health, Improvement Permit # 22887. This authorization shall be valid for a period not to exceed five (5) years from the date of issuance.

This authorization will be invalid if ownership, site plans, or intended use change.

Name CMA Builders LLC Telephone # 910-893-8858

Address 5780 McArthur Rd Broadway N.C. 27505

Property Location SR# 1403 Road Name Harnett Central

Subdivision Pine Meadow Lot # 21 # Bedrooms Proposed 3000 3606PD Lot Size 347

TYPE OF SYSTEM

New Installation Repair Septic Tank Nitrification Lines

Conventional Other 25% Reduction System

Basement With Plumbing Without Plumbing

Water Supply: Well Public Water Supply Minimum Well Setback: _____ Ft.

Septic Tank 1000 gal Pump Chamber _____ gal

NITRIFICATION FIELD SPECIFICATIONS

Number of fields 2 # of lines per field 4 Length of lines 75 Ft.

Width of ditches 3 ft. Depth of ditches 30-71/8 inches

French Drain: Linear feet required - Depth of gravel -

No wastewater system shall be covered or placed into use by any person until an inspection by the Harnett County Health Department has determined that the system has been installed according to the conditions of the Improvement Permit and that a valid Operations Permit has been issued.

James E. Mansour
Signature of Authorized Agent for Harnett County

4-21-06
Date