

HTE# 06-5-14511

IMPROVEMENT PERMIT 22889

Be it ordained by the Harnett County Board of Health as follows: Section III, Item B. "No person shall begin construction of any building at which a septic tank system is to be used for disposal of sewage without first obtaining a written permit from the Harnett County Health Department."

Name: (owner) RAYNOR BUILDERS INC New Installation Septic Tank Repair
 Property Location: SR# 1429 Chalybeate Nitrification Line Expansion
 Subdivision DEXTERFIELD Lot # 15
 Tax ID# _____ Quadrant # _____
 Number of Bedrooms Proposed: 3 Bdrm 360 GPD Lot Size: .423

Basement with Plumbing: Garage:
 Water Supply: Well Public Community
 Distance From Well: 50 ft.

Following is the minimum specifications for sewage disposal system on above captioned property.
Subject to final approval.

Type of system: Conventional Other 25% Reduction System

Size of tank: Septic Tank: 1000 gallons Pump Tank: _____ gallons

Subsurface No. of exact length width of depth of
 Drainage Field ditches 3 ft. of each ditch 80 ft. ditches 3 ft. ditches 30" x 18" in.

French Drain Required: _____ Linear feet

Date: 4-21-06

This permit is subject to revocation if site plans or intended use change.

PERMIT EXPIRES 5 YEARS FROM ABOVE DATE

Signed: James E. Montfortone
 Environmental Health Specialist

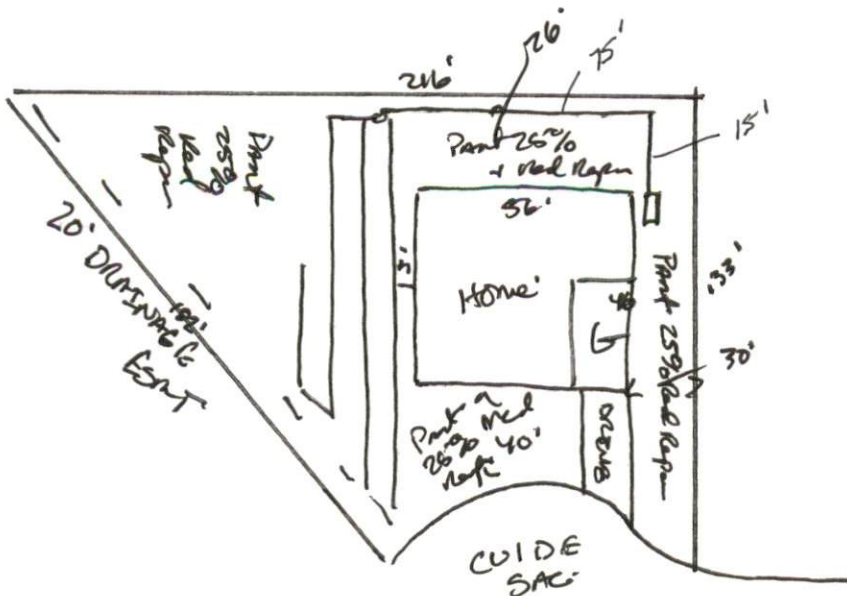

HARNETT COUNTY DEPARTMENT OF PUBLIC HEALTH AUTHORIZATION TO CONSTRUCT

Authorization is hereby given to construct a wastewater system to the specifications described by Harnett County Department of Public Health, Improvement Permit # 22889. This authorization shall be valid for a period not to exceed five (5) years from the date of issuance. *This authorization will be invalid if ownership, site plans, or intended use change.*

Name Raynor Builders Inc Telephone # 919-639-2011

Address 1281 Jackson King RD Wallowa Springs N.C. 27592

Property Location SR# 1429 Road Name Chalkhate

Subdivision Dexter Pkwy Lot # 15 # Bedrooms Proposed 3 Bm 360 GPD Lot Size 1423

TYPE OF SYSTEM

New Installation Repair Septic Tank Nitrification Lines

Conventional Other 25% Red Syst

Basement With Plumbing Without Plumbing

Water Supply: Well Public Water Supply Minimum Well Setback: _____ Ft.

Septic Tank 1600 gal Pump Chamber _____ gal

NITRIFICATION FIELD SPECIFICATIONS

Number of fields 2 # of lines per field 3 Length of lines 80 Ft.

Width of ditches 3 ft. Depth of ditches 30-318 inches

French Drain: Linear feet required _____ Depth of gravel _____

No wastewater system shall be covered or placed into use by any person until an inspection by the Harnett County Health Department has determined that the system has been installed according to the conditions of the Improvement Permit and that a valid Operations Permit has been issued.

James E. Montano
Signature of Authorized Agent for Harnett County

4-24-06
Date