

IMPROVEMENT PERMIT 22620

Be it ordained by the Harnett County Board of Health as follows: Section III, Item B. "No person shall begin construction of any building at which a septic tank system is to be used for disposal of sewage without first obtaining a written permit from the Harnett County Health Department."

Name: (owner) H&H Construction New Installation Septic Tank Repair
 Property Location: SR# 1125 Nitrification Line Expansion
 Subdivision FOREST OAKS Lot # 94
 Tax ID# 3 Quadrant #
 Number of Bedrooms Proposed: 3 (50x40) 360 sq ft Lot Size: 0.35 AC
 Basement with Plumbing: Garage:
 Water Supply: Well Public Community
 Distance From Well: 50 ft.

Following is the minimum specifications for sewage disposal system on above captioned property. Subject to final approval.

Type of system: Conventional Other Pump to 25% Reduction system

Size of tank: Septic Tank: 1000 gallons Pump Tank: 1000 gallons

Subsurface No. of exact length width of depth of
 Drainage Field ditches 3 ft. of each ditch 60 ft. ditches 3 ft. ditches 18 1/4 in.
of 25% Reduction System

French Drain Required: Linear feet

Date: 06-06-06

This permit is subject to revocation if site plans or intended use change.

PERMIT EXPIRES 5 YEARS FROM ABOVE DATE

Signed: [Signature]
171 Environmental Health Specialist

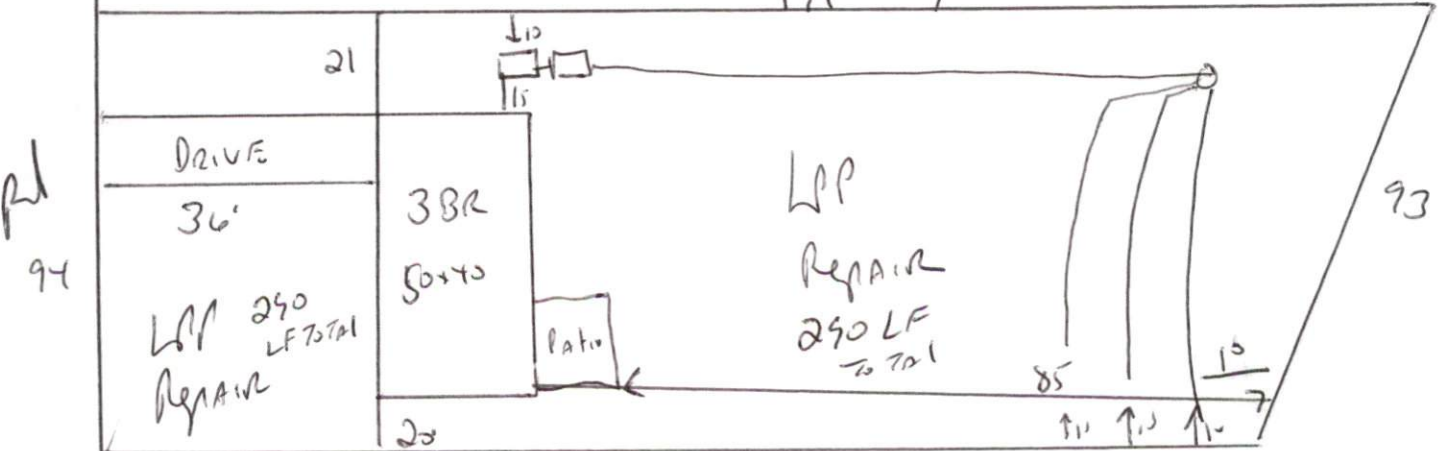

Maintain All set Backs
Meet onsite if questions arise.

HARNETT COUNTY DEPARTMENT OF PUBLIC HEALTH AUTHORIZATION TO CONSTRUCT

Authorization is hereby given to construct a wastewater system to the specifications described by Harnett County Department of Public Health, Improvement Permit # 22620. This authorization shall be valid for a period not to exceed five (5) years from the date of issuance. *This authorization will be invalid if ownership, site plans, or intended use change.*

H&H Construction
Name _____ Telephone # _____

Address _____

1125
Property Location SR# _____ Road Name _____

Fontonah 94 3(50x40) 360 sq ft 35 AC
Subdivision Lot # # Bedrooms Proposed Lot Size

TYPE OF SYSTEM

- New Installation Repair Septic Tank Nitrification Lines
 Conventional Other Pump to 25% Reduction SYSTEM
 Basement With Plumbing Without Plumbing

Water Supply: Well Public Water Supply Minimum Well Setback: _____ Ft.

Septic Tank 1000 gal Pump Chamber 1000 gal

NITRIFICATION FIELD SPECIFICATIONS

Number of fields 1 # of lines per field 3 Length of lines 60 Ft.
 Width of ditches 3 ft. Depth of ditches 18.24 inches OF 25% Reduction SYSTEM
 French Drain: Linear feet required _____ Depth of gravel _____

No wastewater system shall be covered or placed into use by any person until an inspection by the Harnett County Health Department has determined that the system has been installed according to the conditions of the Improvement Permit and that a valid Operations Permit has been issued.

Jerry L. ...
Signature of Authorized Agent for Harnett County

04.06.05
Date