

HTE # 0650014437A

NETT COUNTY HEALTH DEPARTMENT
ENVIRONMENTAL HEALTH SECTION

18610

OPERATIONS PERMIT

Name: (owner) HEH New Installation Septic Tank Repair

Property Location: SR# 1125 Nitrification Line Expansion
Subdivision Fornitook Lot # 27 Tax ID # _____ Quadrant # _____

Contractor: O. Mickland Registration # _____

Basement with Plumbing: Garage:

Water Supply: Well Public Community

Distance From Well: 50 ft.

Following are the specifications for the sewage disposal system on above captioned property.

Type of system: Conventional Other 25% Reduction system 22 Fbw

Size of tank: Septic Tank: 1000 gallons Pump Tank: _____ gallons

Subsurface Drainage Field No. of ditches 1 exact length of each ditch 180 ft. width of ditches 3 ft. depth of ditches 18-24 in.

French Drain Required: _____ Linear feet 11-2 Fbw Date: 10-23-06

PERMIT NO. 23028

Inspected by: J. W. [Signature]

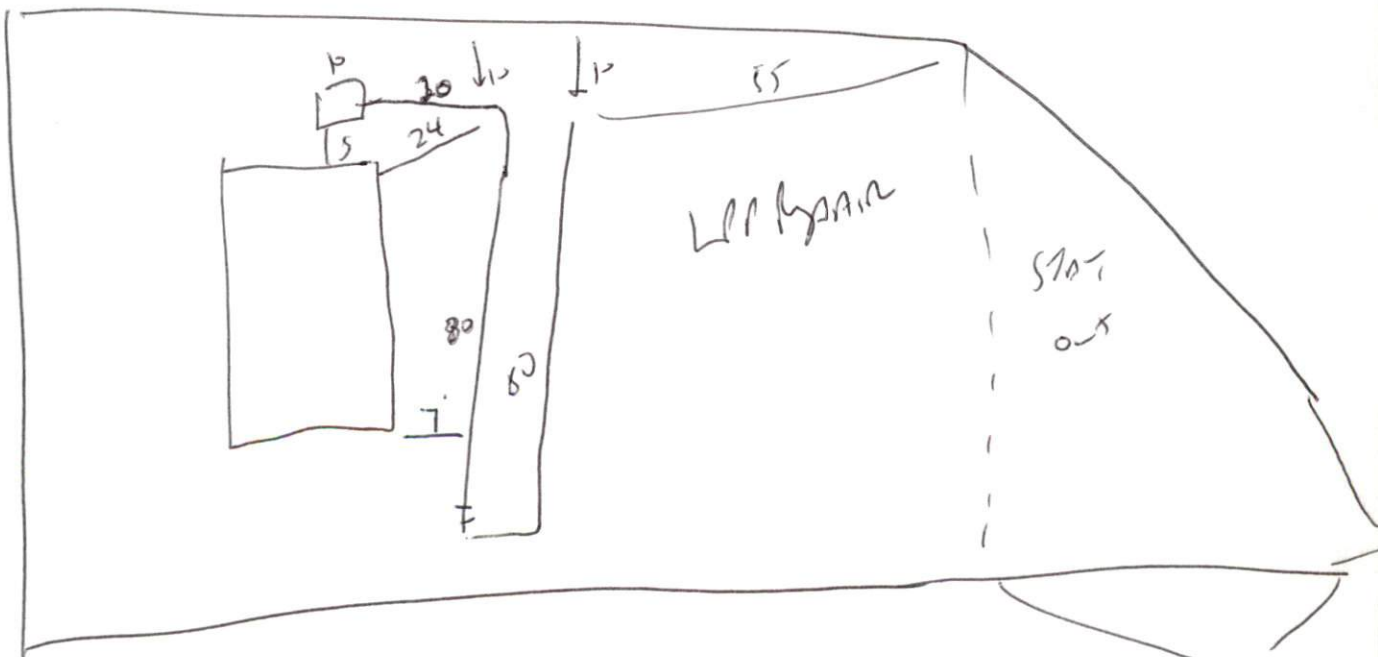

McP. 1000
579 814
8-2-06