

4-12-06

*JW*

Applicatio 20-50014409 R  
1176337

Application Date: 3/28/06

COUNTY OF HARNETT LAND USE APPLICATION  
Phone: (910) 893-4759 Fax: (910) 893-2793

www.harnett.org

Central Permitting

102 E. Front Street, Lillington, NC 27546

LANDOWNER: James D. Siler

Mailing Address: PO Box 1874

City: Sanford

State: NC

Zip: 27330

Phone #: \_\_\_\_\_

APPLICANT: Lynn Builders, Inc.

Mailing Address: 289 Greenlinks Dr.

State: NC

Zip: 27326

Phone #: (919) 498-2074

PROPERTY LOCATION: SR #:

SR Name: \_\_\_\_\_

PIN: 9556-89-8702.000

Parcel: 099567000651

Lot #: 2-13

Lot Size: .104

Zoning: R300R Subdivision: Carolina Seasons

Deed Book/Page: 01536/090

Plat Book/Page: 2

Flood Plain: X Panel: 7E Watershed: N/A

DIRECTIONS TO THE PROPERTY FROM LILLINGTON: take 27W, Turn Right in front of Johnsonville School, take R at Stop sign onto Ponderosa Road then L into Carolina Seasons, Lot is on the corner of Fern Ridge Drive & Ponderosa Trail

PROPOSED USE:

- SFD (Size 160 x 552) # Bedrooms 3 # Baths 2 Basement (w/wo bath) \_\_\_\_\_
- Multi-Family Dwelling No. Units \_\_\_\_\_ No. Bedrooms/Unit \_\_\_\_\_
- Manufactured Home (Size \_\_\_\_\_ x \_\_\_\_\_) # of Bedrooms \_\_\_\_\_ Garage \_\_\_\_\_ Deck \_\_\_\_\_
- Number of persons per household Spec
- Business Sq. Ft. Retail Space \_\_\_\_\_
- Industry Sq. Ft. \_\_\_\_\_
- Church Seating Capacity \_\_\_\_\_ Kitchen \_\_\_\_\_
- Home Occupation (Size \_\_\_\_\_ x \_\_\_\_\_) # Rooms \_\_\_\_\_ Use \_\_\_\_\_
- Additional Information: \_\_\_\_\_
- Accessory Building (Size \_\_\_\_\_ x \_\_\_\_\_) Use \_\_\_\_\_
- Addition to Existing Building (Size \_\_\_\_\_ x \_\_\_\_\_) Use \_\_\_\_\_
- Other \_\_\_\_\_

Garage 2 Deck 1 Crawl Space / Slab

*Note: EH denied because prop. lines/corner not marked or labeled - see 4-5-06 ltr. from EH SR*

*also, house being moved. SR*

Environmental Health Site Visit Date: \_\_\_\_\_

Water Supply:  County  Well (No. dwellings \_\_\_\_\_)  Other \_\_\_\_\_

Sewage Supply:  New Septic Tank  Existing Septic Tank  County Sewer  Other \_\_\_\_\_

Erosion & Sedimentation Control Plan Required? YES  NO

Property owner of this tract of land own land that contains a manufactured home w/in five hundred feet (500') of tract listed above? YES  NO

Structures on this tract of land: Single family dwellings 1 Manufactured homes \_\_\_\_\_ Other (specify) \_\_\_\_\_

Required Residential Property Line Setbacks:

	Minimum	Actual
Front	35	<del>60</del> 50'
Rear	25	25 85' 2.5'
Side	10	40 20 55' / 78'
Corner	20	40'
Nearest Building	10	N/A

If permits are granted I agree to conform to all ordinances and the laws of the State of North Carolina regulating such work and the specifications or submitted. I hereby swear that the foregoing statements are accurate and correct to the best of my knowledge.

Lynn K. Lynn  
for Owner's Agent

3-27-06  
Date

\*\*This application expires 6 months from the initial date if no permits have been issued\*\*  
COPY PLAT AND RECORDED DEED ARE REQUIRED WHEN APPLYING FOR A LAND USE APPLICATION

Please use Blue or Black Ink ONLY

4/13 S 08/05







Initial Application Date: 3/28/06

Application # 00-50014409  
1168774

**COUNTY OF HARNETT LAND USE APPLICATION**

Central Permitting 102 E. Front Street, Lillington, NC 27546 Phone: (910) 893-4759 Fax: (910) 893-2793 www.harnett.org

LANDOWNER: James D. Siler Mailing Address: PO Box 1874  
City: Sanford State: NC Zip: 27330 Phone#: \_\_\_\_\_

APPLICANT: Lyon Builders, Inc. Mailing Address: 289 Greenlinks Dr.  
City: Camden State: NC Zip: 28326 Phone #: (919) 498-2074

PROPERTY LOCATION: SR #: \_\_\_\_\_ SR Name: \_\_\_\_\_  
Parcel: 099561000651 PIN: 9556-89-8702.000

Zoning: R300R Subdivision: Carolina Seasons Lot #: 2-13 Lot Size: .104  
Flood Plain: X Panel: 7E Watershed: N/A Deed Book/Page: 01536/090 Plat Book/Page: #2 P# E/A/C

DIRECTIONS TO THE PROPERTY FROM LILLINGTON: Take 27W, Turn Right in front of Johnsonville School, take R at Stop sign onto Ponderosa Road then L into Carolina Seasons, Lot is on the corner of Fern Ridge Drive & Ponderosa Trail

**PROPOSED USE:**

- SFD (Size 1616 x 552) # Bedrooms 3 # Baths 2 Basement (w/wo bath) None Garage 2 Deck 1 Crawl Space / Slab
- Multi-Family Dwelling No. Units \_\_\_\_\_ No. Bedrooms/Unit \_\_\_\_\_
- Manufactured Home (Size \_\_\_\_\_ x \_\_\_\_\_) # of Bedrooms \_\_\_\_\_ Garage \_\_\_\_\_ Deck \_\_\_\_\_
- Number of persons per household Spec
- Business Sq. Ft. Retail Space \_\_\_\_\_ Type \_\_\_\_\_
- Industry Sq. Ft. \_\_\_\_\_ Type \_\_\_\_\_
- Church Seating Capacity \_\_\_\_\_ Kitchen \_\_\_\_\_
- Home Occupation (Size \_\_\_\_\_ x \_\_\_\_\_) # Rooms \_\_\_\_\_ Use \_\_\_\_\_
- Additional Information: \_\_\_\_\_
- Accessory Building (Size \_\_\_\_\_ x \_\_\_\_\_) Use \_\_\_\_\_
- Addition to Existing Building (Size \_\_\_\_\_ x \_\_\_\_\_) Use \_\_\_\_\_
- Other \_\_\_\_\_

Additional Information: \_\_\_\_\_

Water Supply:  County  Well (No. dwellings \_\_\_\_\_)  Other \_\_\_\_\_ Environmental Health Site Visit Date: \_\_\_\_\_

Sewage Supply:  New Septic Tank  Existing Septic Tank  County Sewer  Other \_\_\_\_\_

Erosion & Sedimentation Control Plan Required? YES NO

Property owner of this tract of land own land that contains a manufactured home w/in five hundred feet (500') of tract listed above? YES NO

Structures on this tract of land: Single family dwellings 1 Manufactured homes \_\_\_\_\_ Other (specify) \_\_\_\_\_

Required Residential Property Line Setbacks:

	Minimum	Actual
Front	35	60
Rear	25	25 85'
Side	10	40 26'
Corner	20	40'
Nearest Building	10	N/A

If permits are granted I agree to conform to all ordinances and the laws of the State of North Carolina regulating such work and the specifications or plans submitted. I hereby swear that the foregoing statements are accurate and correct to the best of my knowledge.

Angel P. Lyon  
Signature of Owner or Owner's Agent

3-27-06  
Date

\*\*This application expires 6 months from the initial date if no permits have been issued\*\*

**A RECORDED SURVEY PLAT AND RECORDED DEED ARE REQUIRED WHEN APPLYING FOR A LAND USE APPLICATION**

Please use Blue or Black Ink ONLY

08/05

3/31/06 (S)



SITE PLAN APPROVAL

DISTRICT RASOR USE SFD

ROOMS 3

3/28/02

A. Diogus  
Zoning Administrator

Angeliza

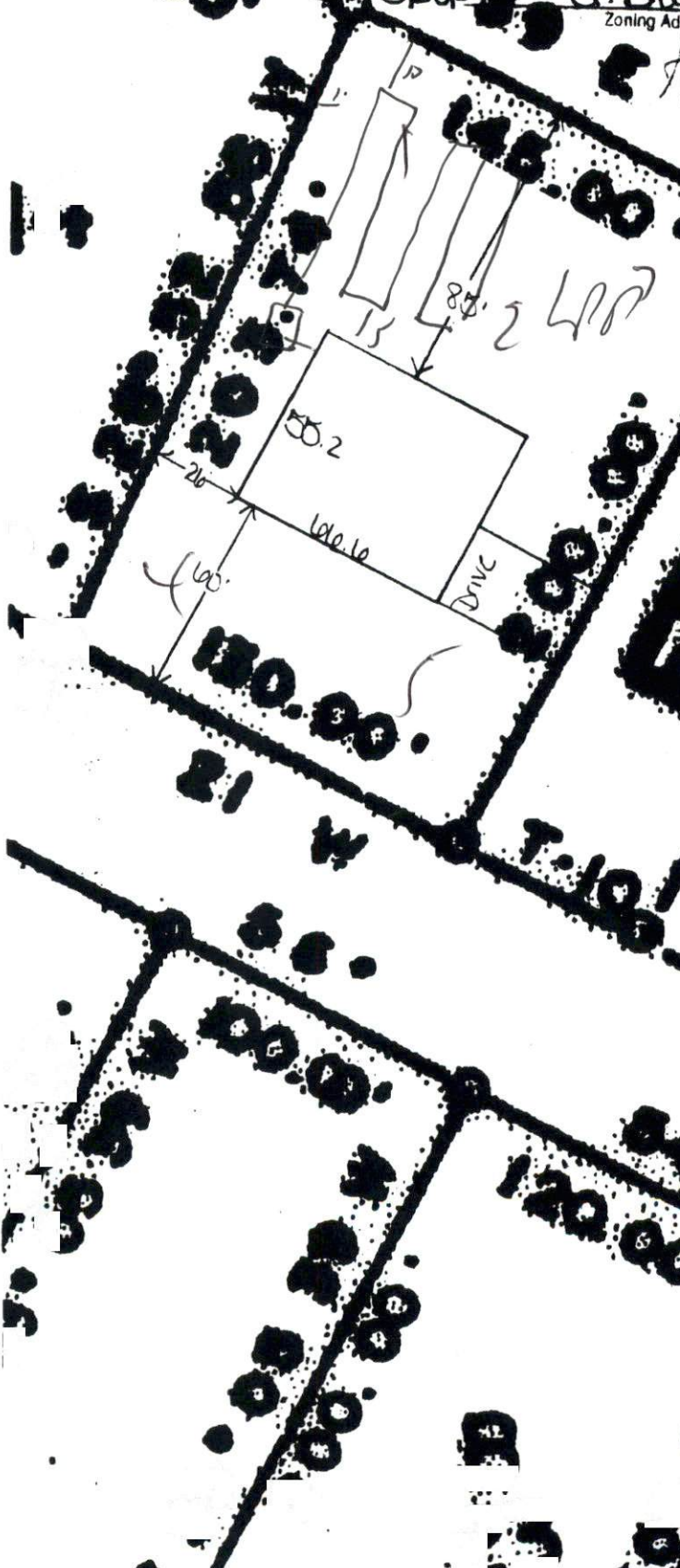

**FERN RIDGE**

**12**