

HARNETT COUNTY HEALTH DEPARTMENT

HTE# 06-5-14392

IMPROVEMENT PERMIT 22874

Be it ordained by the Harnett County Board of Health as follows: Section III, Item B. "No person shall begin construction of any building at which a septic tank system is to be used for disposal of sewage without first obtaining a written permit from the Harnett County Health Department."

Name: (owner) CURRIEN BUILDERS INC New Installation Septic Tank Repair

Property Location: SR# 1478 Chalybeate RD Nitrification Line Expansion

Subdivision DEXTER FELD Lot # 63

Tax ID# _____ Quadrant # _____

Number of Bedrooms Proposed: 3 OR 360 GPD Lot Size: -401

Basement with Plumbing: Garage:

Water Supply: Well Public Community

Distance From Well: 50' ft.

Following is the minimum specifications for sewage disposal system on above captioned property. Subject to final approval.

Type of system: Conventional Other 25% Reduction System

Size of tank: Septic Tank: 1000 gallons Pump Tank: _____ gallons

Subsurface No. of exact length width of depth of
Drainage Field ditches 2 ft. of each ditch 120 ft. ditches 3 ft. ditches 26-18 in.

French Drain Required: - Linear feet

Date: 4-5-06
PERMIT EXPIRES 5 YEARS FROM ABOVE DATE

This permit is subject to revocation if site plans or intended use change.

Signed James E. Markham
Environmental Health Specialist

*STEP-DOWN'S WELL
BB NEEDED.

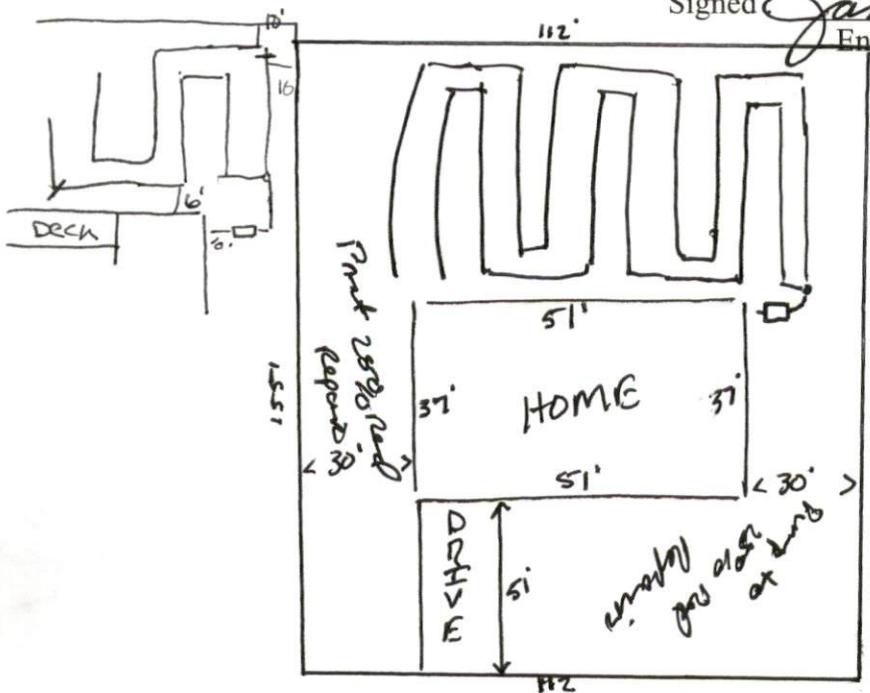

DEXTER FELD DR

HARNETT COUNTY DEPARTMENT OF PUBLIC HEALTH AUTHORIZATION TO CONSTRUCT

Authorization is hereby given to construct a wastewater system to the specifications described by Harnett County Department of Public Health, Improvement Permit # 22874. This authorization shall be valid for a period not to exceed five (5) years from the date of issuance. *This authorization will be invalid if ownership, site plans, or intended use change.*

CURRIN Builders INC 919-639-6989
Name Telephone #

6390 Wintberry RD Weldon Springs N.C. 27592
Address

1429 Chalybeate
Property Location SR# Road Name

DEPTON FLD 63 3BR 360 GPD .401
Subdivision Lot # # Bedrooms Proposed Lot Size

TYPE OF SYSTEM

- New Installation Repair Septic Tank Nitrification Lines
- Conventional Other 25% Reduction System
- Basement With Plumbing Without Plumbing
- Water Supply: Well Public Water Supply Minimum Well Setback: _____ Ft.
- Septic Tank 1000 gal Pump Chamber _____ gal

NITRIFICATION FIELD SPECIFICATIONS

Number of fields 2 # of lines per field 2 Length of lines 120 Ft.
 Width of ditches 3 ft. Depth of ditches 26-318 inches
 French Drain: Linear feet required - Depth of gravel -

No wastewater system shall be covered or placed into use by any person until an inspection by the Harnett County Health Department has determined that the system has been installed according to the conditions of the Improvement Permit and that a valid Operations Permit has been issued.

James E. Montant 4-5-06
Signature of Authorized Agent for Harnett County Date