

HTE# 06-5-14372

IMPROVEMENT PERMIT 22879

Be it ordained by the Harnett County Board of Health as follows: Section III, Item B. "No person shall begin construction of any building at which a septic tank system is to be used for disposal of sewage without first obtaining a written permit from the Harnett County Health Department."

Name: (owner) Keith Bullock - Atkins Place New Installation Septic Tank Repair
Property Location: SR# 1429 Chalybeate RD Nitrification Line Expansion
Subdivision DEXTERVILLE Lot # 12
Tax ID# _____ Quadrant # _____
Number of Bedrooms Proposed: 3BR 3606PD Lot Size: 1,345

Basement with Plumbing: Garage:
Water Supply: Well Public Community
Distance From Well: 50' ft.

Following is the minimum specifications for sewage disposal system on above captioned property. Subject to final approval.

Type of system: Conventional Other 25% Reduction System

Size of tank: Septic Tank: 1000 gallons Pump Tank: _____ gallons

Subsurface No. of exact length width of depth of
Drainage Field ditches 3 ft. of each ditch 80 ft. ditches 3 ft. ditches 30 → 18 in.

French Drain Required: - Linear feet

Date: 4-11-06
PERMIT EXPIRES 5 YEARS FROM ABOVE DATE

This permit is subject to revocation if site plans or intended use change.

Signed James E. Mantel
Environmental Health Specialist

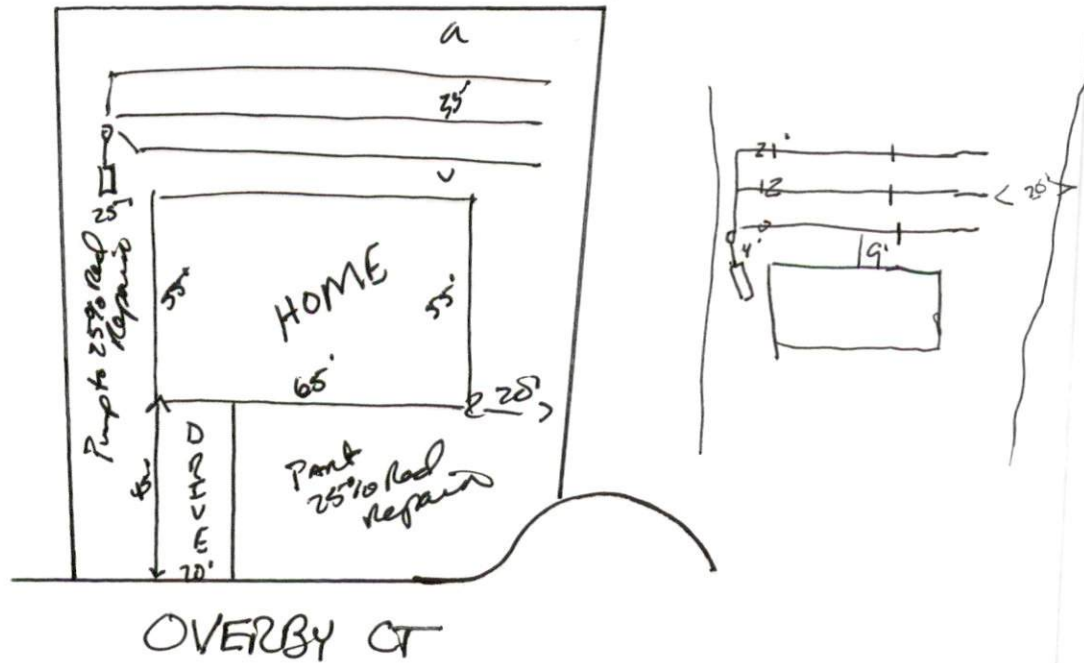

HARNETT COUNTY DEPARTMENT OF PUBLIC HEALTH AUTHORIZATION TO CONSTRUCT

Authorization is hereby given to construct a wastewater system to the specifications described by Harnett County Department of Public Health, Improvement Permit # 22879. This authorization shall be valid for a period not to exceed five (5) years from the date of issuance. *This authorization will be invalid if ownership, site plans, or intended use change.*

Name Keith Bullock - Atkins Place Telephone # 919-427-4628

Address 72 Overlook Ct Angier N.C. 27501

Property Location SR# 1425 Road Name Chalybeate

Subdivision DEXTERFIELD Lot # 12 # Bedrooms Proposed 3BA 3606PD Lot Size 1.345

TYPE OF SYSTEM

- New Installation Repair Septic Tank Nitrification Lines
- Conventional Other 25% Reduction system
- Basement With Plumbing Without Plumbing

Water Supply: Well Public Water Supply Minimum Well Setback: _____ Ft.

Septic Tank 1000 gal Pump Chamber _____ gal

NITRIFICATION FIELD SPECIFICATIONS

Number of fields 2 # of lines per field 3 Length of lines 80 Ft.

Width of ditches 3 ft. Depth of ditches 30 → 18 inches

French Drain: Linear feet required - Depth of gravel -

No wastewater system shall be covered or placed into use by any person until an inspection by the Harnett County Health Department has determined that the system has been installed according to the conditions of the Improvement Permit and that a valid Operations Permit has been issued.

James L. Montanaro
Signature of Authorized Agent for Harnett County

4-11-06
Date