

HTE # 06-500 14339

HARNET COUNTY HEALTH DEPARTMENT
ENVIRONMENTAL HEALTH SECTION

18512

OPERATIONS PERMIT

Name: (owner) Moss Builders New Installation Septic Tank Repair

Property Location: SR# BARNES AVE Nitrification Line Expansion
Subdivision Brenda Hill Lot # 21 Tax ID # _____ Quadrant # _____

Contractor: L. Johnson Registration # _____

Basement with Plumbing: Garage:

Water Supply: Well Public Community

Distance From Well: 50 ft.

Following are the specifications for the sewage disposal system on above captioned property.

Type of system: Conventional Other 25% Reduction System E-2-Flow

Size of tank: Septic Tank: 1000 gallons Pump Tank: _____ gallons

Subsurface Drainage Field No. of ditches 1 exact length of each ditch 150 ft. width of ditches 3 ft. depth of ditches 18.24 in.

French Drain Required: _____ Linear feet Date: 04-15-06

PERMIT NO. 22602 Inspected by: J. W. [Signature]

07/1/00
5/5/03
6-12-06

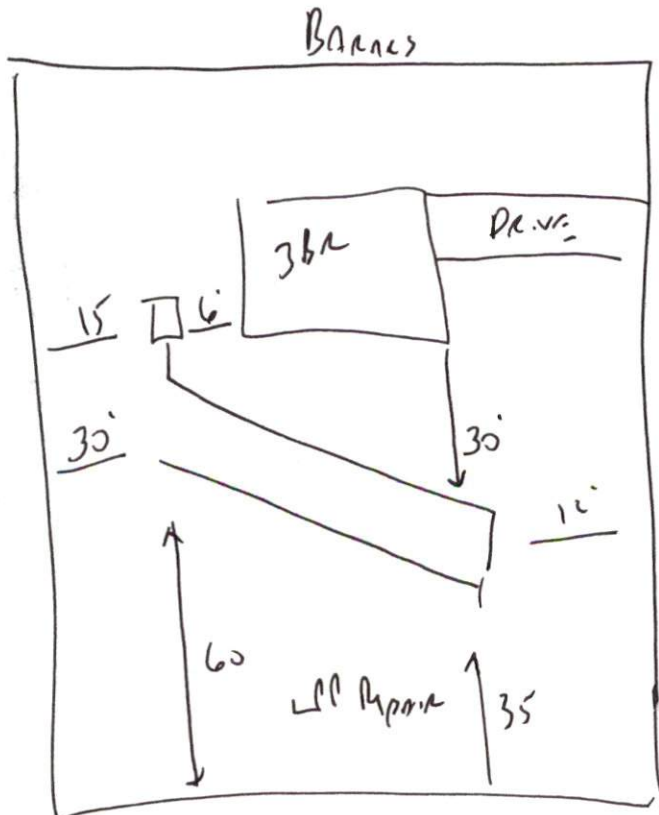

Morgan Drive