

03-5-4150

IMPROVEMENT PERMIT

Be it ordained by the Harnett County Board of Health as follows: Section III, Item B. "No Person shall begin construction of any building at which a septic tank system is to be used for disposal of sewage without first obtaining a written permit from the Harnett County Health Department."

Name: (owner) William E. Pullen New Installation Septic Tank
Property Location: SR# 1403 Cokesbury Rd Repairs Nitrification Line

Subdivision Cokesbury Park Lot # 9

Tax ID # _____ Quadrant # _____

Number of Bedrooms Proposed: 3 Lot Size: _____

Basement with Plumbing: Garage:

Water Supply: Well Public Community

Distance From Well: 50 min ft.

Void

Following is the minimum specifications for sewage disposal system on above captioned property. Subject to final approval.

Type of system: Conventional Other Pump to Conventional

Size of tank: Septic Tank: 1000 gallons Pump Tank: 1000 gallons

Subsurface Drainage Field No. of ditches 6 exact length of each ditch 70 ft. width of ditches 3 ft. depth of ditches 12 in. MAX
6 in of cover required

French Drain Required: _____ Linear feet

Date: 1/16/2003
Signed: Bryan McSwain R.S. POND
Environmental Health Specialist

This permit is subject to revocation if site plans or intended use change.

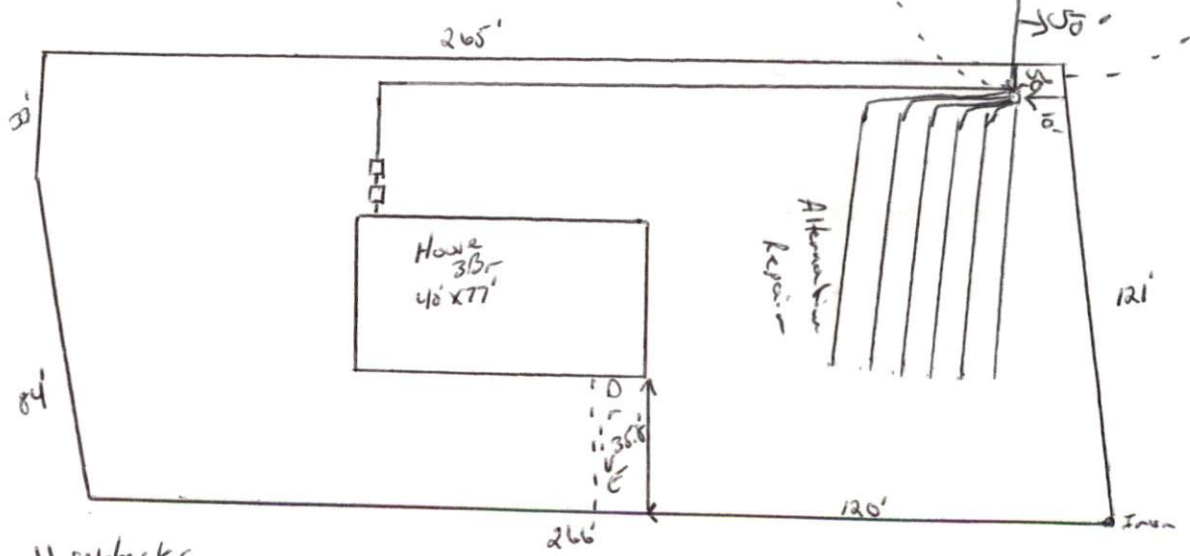

- * Maintain all setbacks
- * Run ditches on contour + NO DEGREE flar 12 inches
- * 6 inches of cover required over system
- * All parts of system must be 50 ft. off pond

**HARNETT COUNTY HEALTH DEPARTMENT
AUTHORIZATION TO CONSTRUCT**

Authorization is hereby given to construct a wastewater system to the specifications described by Harnett County Health Department, Improvement Permit # 19735. This authorization shall be valid for a period not to exceed five (5) years from the date of issuance. *This authorization will be invalid if ownership, site plans, or intended use change.*

Name William E. Pullen Telephone# 919 557-8004

Address P.O. Box 128 Fugate Village, N.C. 27526

Property Location SR# 1403 Road Name Cokerbury

Subdivision Cokerbury Park Lot # 9 # Bedrooms Proposed 3

Void due to issuing permit # 19743 2/6/2003 BM

TYPE OF SYSTEM

- New Installation Repair Septic Tank Nitrification Lines
- Conventional Other Pump to shallow Conventional
- Basement With Plumbing Without Plumbing

Water Supply: Well Public Water Supply Minimum Well Setback: 50 Ft.

Septic Tank 1000 gal Pump Chamber 1000 gal

NITRIFICATION FIELD SPECIFICATIONS

Number of fields 1 # of lines per field 6 Length of lines 70 Ft.

Width of ditches 3 ft. Depth of ditches 12 inches *MAX 6 inches of cover*

French Drain: Linear feet required _____ Depth of gravel _____

No wastewater system shall be covered or placed into use by any person until an inspection by the Harnett County Health Department has determined that the system has been installed according to the conditions of the Improvement Permit and that a valid Operations Permit has been issued.

Bryan M. Lewis, L.S.
Signature of Authorized Agent for Harnett County of Harnett

11/16/2002
Date