

HARNETT COUNTY HEALTH DEPARTMENT

HTE# 06-5-14063

IMPROVEMENT PERMIT 22388

Be it ordained by the Harnett County Board of Health as follows: Section III, Item B. "No person shall begin construction of any building at which a septic tank system is to be used for disposal of sewage without first obtaining a written permit from the Harnett County Health Department."

Name: (owner) Comfort Homes Inc New Installation  Septic Tank  Repair

Property Location: SR# 1412 Christina Light Nitrification Line  Expansion

Subdivision Forest Trails Lot # 51

Tax ID# \_\_\_\_\_ Quadrant # \_\_\_\_\_

Number of Bedrooms Proposed: 3 3606PD Lot Size: .461

Basement with Plumbing:  Garage:

Water Supply:  Well  Public  Community

Distance From Well: 50 ft.

Following is the minimum specifications for sewage disposal system on above captioned property. Subject to final approval.

Type of system:  Conventional  Other 25% Reduction Syst - Manette

Size of tank: Septic Tank: 1000 gallons Pump Tank: 1000 gallons

Subsurface Drainage Field No. of ditches 4 ft. exact length of each ditch 80 ft. width of ditches 3 ft. depth of ditches 22-18 in.

French Drain Required: - Linear feet

Date: 2-28-06

PERMIT EXPIRES 5 YEARS FROM ABOVE DATE

This permit is subject to revocation if site plans or intended use change.

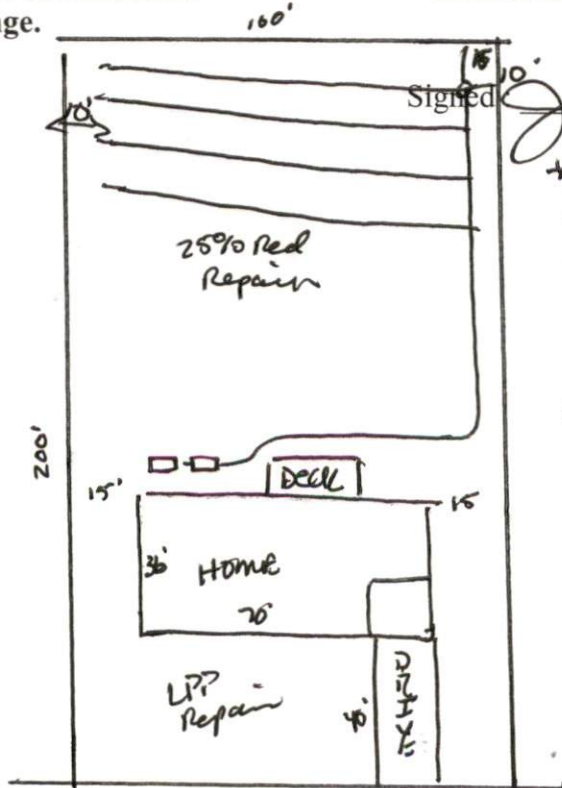

Signed James E. Mantel  
Environmental Health Specialist

\* MANETTE SPEC'S

4-3/4" SCH 40 TAPS

4' OF RISE "ELEVATION"

\* 160' of Supply

ROCKY POINT CT

# HARNETT COUNTY DEPARTMENT OF PUBLIC HEALTH AUTHORIZATION TO CONSTRUCT

Authorization is hereby given to construct a wastewater system to the specifications described by Harnett County Department of Public Health, Improvement Permit # 22388. This authorization shall be valid for a period not to exceed five (5) years from the date of issuance. *This authorization will be invalid if ownership, site plans, or intended use change.*

Comfort Homes INC Name 919-553-3242 Telephone #

P.O. Box 369 Clayton N.C. 27528 Address

1412 Property Location SR# Christina Light RD Road Name

Forest Trails Subdivision 51 Lot # 3 3606PD # Bedrooms Proposed .461 ac Lot Size

### TYPE OF SYSTEM

New Installation  Repair  Septic Tank  Nitrification Lines

Conventional  Other 25% Red syst MANAGE

Basement  With Plumbing  Without Plumbing

Water Supply:  Well  Public Water Supply Minimum Well Setback: \_\_\_\_\_ Ft.

Septic Tank 1000 gal Pump Chamber 1000 gal

### NITRIFICATION FIELD SPECIFICATIONS

Number of fields 2 # of lines per field 4 Length of lines 80 Ft.

Width of ditches 3 ft. Depth of ditches 22-28 inches

French Drain: Linear feet required — Depth of gravel —

No wastewater system shall be covered or placed into use by any person until an inspection by the Harnett County Health Department has determined that the system has been installed according to the conditions of the Improvement Permit and that a valid Operations Permit has been issued.

James E. Montan  
Signature of Authorized Agent for Harnett County

2-28-06  
Date