

HTE# 0650013917R

# IMPROVEMENT PERMIT 22517

Be it ordained by the Harnett County Board of Health as follows: Section III, Item B. "No person shall begin construction of any building at which a septic tank system is to be used for disposal of sewage without first obtaining a written permit from the Harnett County Health Department."

Name: (owner) Bill Clark Homes New Installation  Septic Tank  Repair

Property Location: SR# 1139 Tingen Rd Nitrification Line  Expansion

Subdivision Patton's Point Lot # 2

Tax ID# \_\_\_\_\_ Quadrant # \_\_\_\_\_

Number of Bedrooms Proposed: 3 (62x48) 360 sqd Lot Size: .347 Ac

Basement with Plumbing:  Garage:

Water Supply:  Well  Public  Community

Distance From Well: 50 ft.

Following is the minimum specifications for sewage disposal system on above captioned property. Subject to final approval.

Type of system:  Conventional  Other \_\_\_\_\_

Size of tank: Septic Tank: 1000 gallons Pump Tank: \_\_\_\_\_ gallons

Subsurface Drainage Field No. of ditches 1 exact length of each ditch 200 ft. width of ditches 3 ft. depth of ditches 18-24 in.

French Drain Required: \_\_\_\_\_ Linear feet

Date: 02 17-06

This permit is subject to revocation if site plans or intended use change.

PERMIT EXPIRES 5 YEARS FROM ABOVE DATE

*Meet onsite - STUB out plumbing shallow At Ground level or higher where shown*

Signed: [Signature]  
Environmental Health Specialist

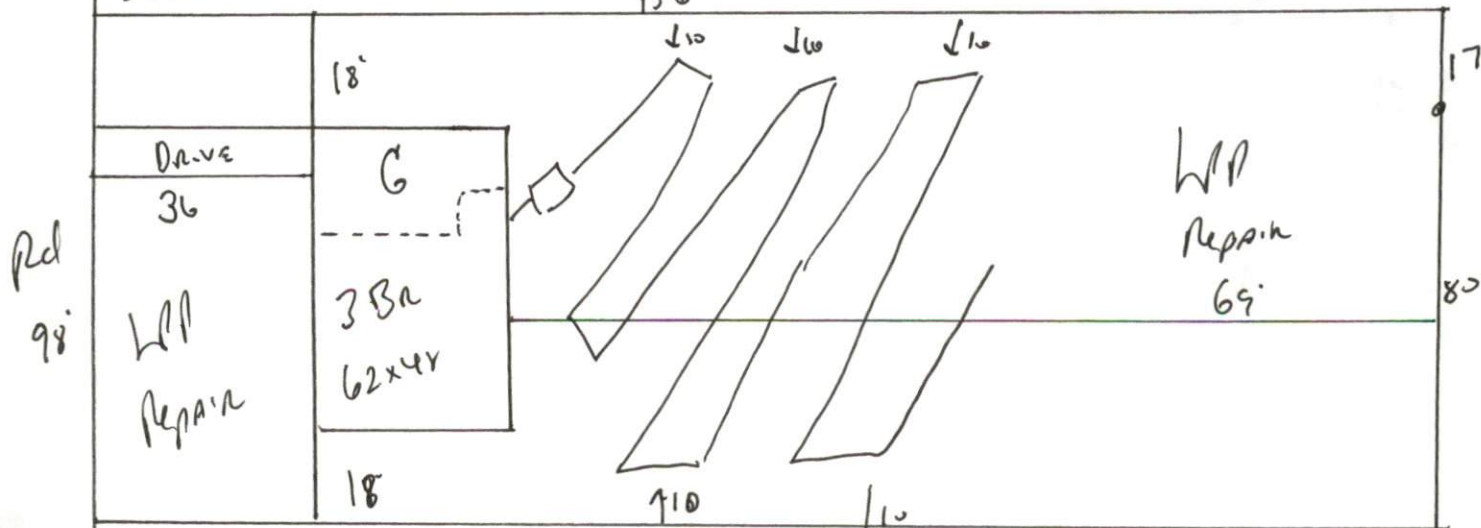

*Meet onsite STUB out plumbing shallow (Ground level or higher) where shown MAINTAIN ALL SET BACKS -*

HARNETT COUNTY DEPARTMENT OF PUBLIC HEALTH  
AUTHORIZATION TO CONSTRUCT

Authorization is hereby given to construct a wastewater system to the specifications described by Harnett County Department of Public Health, Improvement Permit # 22517. This authorization shall be valid for a period not to exceed five (5) years from the date of issuance. *This authorization will be invalid if ownership, site plans, or intended use change.*

Name Bill Clark Home Telephone # \_\_\_\_\_

Address \_\_\_\_\_

Property Location SR# 1139 Road Name \_\_\_\_\_

Subdivision Patton's Point Lot # 2 # Bedrooms Proposed 3 (62x48) 360 sq ft Lot Size 347 ac

**TYPE OF SYSTEM**

- New Installation [ ] Repair  Septic Tank  Nitrification Lines  
 Conventional [ ] Other \_\_\_\_\_  
[ ] Basement [ ] With Plumbing [ ] Without Plumbing

Water Supply: [ ] Well  Public Water Supply Minimum Well Setback: 50 Ft.

Septic Tank 1000 gal Pump Chamber \_\_\_\_\_ gal

**NITRIFICATION FIELD SPECIFICATIONS**

Number of fields 1 # of lines per field 1 Length of lines 20 Ft.

Width of ditches 3 ft. Depth of ditches 18.24 inches

French Drain: Linear feet required \_\_\_\_\_ Depth of gravel \_\_\_\_\_

No wastewater system shall be covered or placed into use by any person until an inspection by the Harnett County Health Department has determined that the system has been installed according to the conditions of the Improvement Permit and that a valid Operations Permit has been issued.

Signature of Authorized Agent for Harnett County Jon West RS

Date 02-13-06