

HTE# 05-5-13663

# IMPROVEMENT PERMIT 22286

Be it ordained by the Harnett County Board of Health as follows: Section III, Item B. "No person shall begin construction of any building at which a septic tank system is to be used for disposal of sewage without first obtaining a written permit from the Harnett County Health Department."

Name: (owner) Comfort Home, Inc. New Installation  Septic Tank  Repair

Property Location: SR# 1412 Christian Light Rd Nitrification Line  Expansion

Subdivision Forest Trails Lot # 1

Tax ID# \_\_\_\_\_ Quadrant # \_\_\_\_\_

Number of Bedrooms Proposed: 3 (360 sq ft) Lot Size: .469 Ac

Basement with Plumbing:  Garage:

Water Supply:  Well  Public  Community

Distance From Well: 50 ft.

**Following is the minimum specifications for sewage disposal system on above captioned property. Subject to final approval.**

Type of system:  Conventional  Other Pump to 25% reduction system

Size of tank: Septic Tank: 1000 gallons Pump Tank: 1000 gallons

Subsurface No. of exact length width of depth of  
Drainage Field ditches 1 of each ditch 300 ft. ditches 3 ft. ditches 18-20 in.

French Drain Required: \_\_\_\_\_ Linear feet

Date: 6/19/2006  
PERMIT EXPIRES 5 YEARS FROM ABOVE DATE

**This permit is subject to revocation if site plans or intended use change.**

Signed: [Signature]  
Environmental Health Specialist

\* Maintain all setbacks  
\* Run ditch on contour

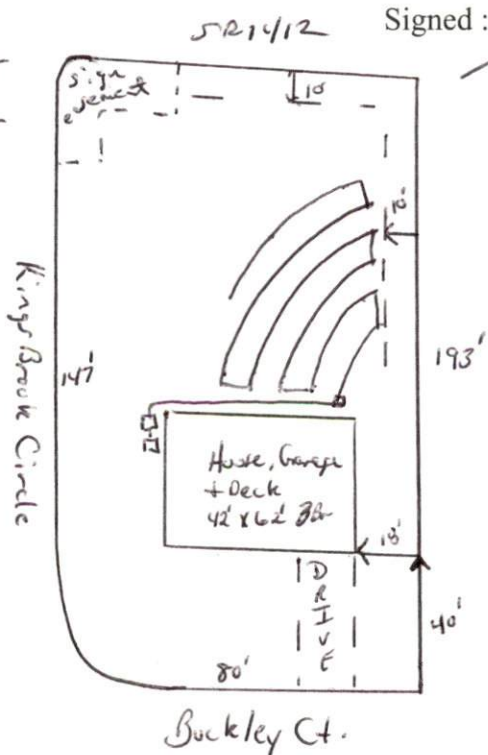

HARNETT COUNTY DEPARTMENT OF PUBLIC HEALTH  
AUTHORIZATION TO CONSTRUCT

Authorization is hereby given to construct a wastewater system to the specifications described by Harnett County Department of Public Health, Improvement Permit # 22286. This authorization shall be valid for a period not to exceed five (5) years from the date of issuance. *This authorization will be invalid if ownership, site plans, or intended use change.*

Comfort Home Fnc Name 919-553-3242 Telephone #

P.O. Box 369 Clayton, N.C. 27528 Address

1412 Property Location SR# Christian Light Road Name

Forest Trails Subdivision 1 Lot # 3 (360 sq ft) # Bedrooms Proposed .469 Ac Lot Size

**TYPE OF SYSTEM**

New Installation  Repair  Septic Tank  Nitrification Lines

Conventional  Other Pump to 25% reduction system

Basement  With Plumbing  Without Plumbing

Water Supply:  Well  Public Water Supply Minimum Well Setback: 50 Ft.

Septic Tank 1000 gal Pump Chamber 1000 gal

**NITRIFICATION FIELD SPECIFICATIONS**

Number of fields 1 # of lines per field 1 Length of lines 300 Ft.

Width of ditches 3 ft. Depth of ditches 18-20 inches

French Drain: Linear feet required \_\_\_\_\_ Depth of gravel \_\_\_\_\_

No wastewater system shall be covered or placed into use by any person until an inspection by the Harnett County Health Department has determined that the system has been installed according to the conditions of the Improvement Permit and that a valid Operations Permit has been issued.

[Signature]  
Signature of Authorized Agent for Harnett County

1/9/2006  
Date