

**SOIL/SITE EVALUATION
 for ON-SITE WASTEWATER SYSTEM**

Owner: _____ Applicant: _____
 Address: _____ Date Evaluated: _____
 Proposed Facility: _____ Design Flow (.1949): _____ Property Size: _____
 Location of Site: _____ Property Recorded: _____
 Water Supply: Public Individual Well Spring Other
 Evaluation Method: Auger Boring Pit Cut
 Type of Wastewater: Sewage Industrial Process Mixed

Profile #	1940 Landscape Position/Slope%	Horizon Depth (IN.)	SOIL MORPHOLOGY 1941		OTHER PROFILE FACTORS				Profile Class & LTAR
			1941 Structure/Texture	1941 Consistence Mineralogy	1942 Soil Wetness/Color	1943 Soil Depth (IN.)	1956 Sapro Class	1944 Restr Horiz	
1	L 2%	0-12	SL	ML GR NSNP					3
		12-32	SC-CL	ML GR NSNP					
		32"+	SAP	ML GR NSNP			GPI		
2	L 3%	0-8	SL	ML GR NSNP					3
		8-30	SC-CL	ML GR NSNP					
		30"+	SAP	ML GR NSNP			GPI		
3	L 3 1/2%	0-5	SL	ML GR NSNP					3
		5-28	CLAY	ML GR NSNP					
		28"+	SAP	ML GR NSNP			GPI		
3 BROW					360 GPD				

Description	Initial System	Repair System
Available Space (.1945)		
System Type(s)	150/10	UPP
Site LTAR	.3	.3 → .15

Other Factors (.1946): _____
 Site Classification (.1948): _____
 Evaluated By: _____
 Others Present: _____

COMMENTS: _____

<u>LANDSCAPE POSITIONS</u>	<u>GROUP</u>	<u>TEXTURES</u>	<u>.1955 LTAR</u>	<u>CONSISTENCE MOIST</u>	<u>WET</u>
R-RIDGE	I	S-SAND	1.2 - 0.8	VFR-VERY FRIABLE	NS-NON-STICKY
S-SHOULDER SLOPE		LS-LOAMY SAND			
L-LINEAR SLOPE	II	SL-SANDY LOAM	0.8 - 0.6	FR-FRIABLE	SS-SLIGHTLY STICKY
FS-FOOT SLOPE		L-LOAM		FI-FIRM	S-STICKY
N-NOSE SLOPE					VFI-VERY FIRM
H-HEAD SLOPE	III	SI-SILT-	0.6 - 0.3	EFI-EXTREMELY FIRM	NP-NON-PLASTIC
CC-CONCLAVE SLOPE		SIL-SILT LOAM			SP-SLIGHTLY STICKY
CV-CONVEX SLOPE		CL-CLAY LOAM			P-PLASTIC
T-TERRACE		SCL-SANDY CLAY LOAM			VP-VERY PLASTIC
FP-FLOOD PLAN		SICL-SILTY CLAY LOAM			
	IV	SIC-SILTY CLAY	0.4 - 0.1		
		C-CLAY			
		SC-SANDY CLAY			

- | | |
|-----------------------|--------------------|
| <u>STRUCTURE</u> | <u>MINERALOGY</u> |
| SG-SINGLE GRAIN | SLIGHTLY EXPANSIVE |
| M-MASSIVE | |
| CR-CRUMB | EXPANSIVE |
| GR-GRANULAR | |
| SBK-SUBANGULAR BLOCKY | |
| ABK-ANGULAR BLOCKY | |
| PL-PLATY | |
| PR-PRISMATIC | |

Show profile locations and other site features (dimensions, reference or benchmark, and North).

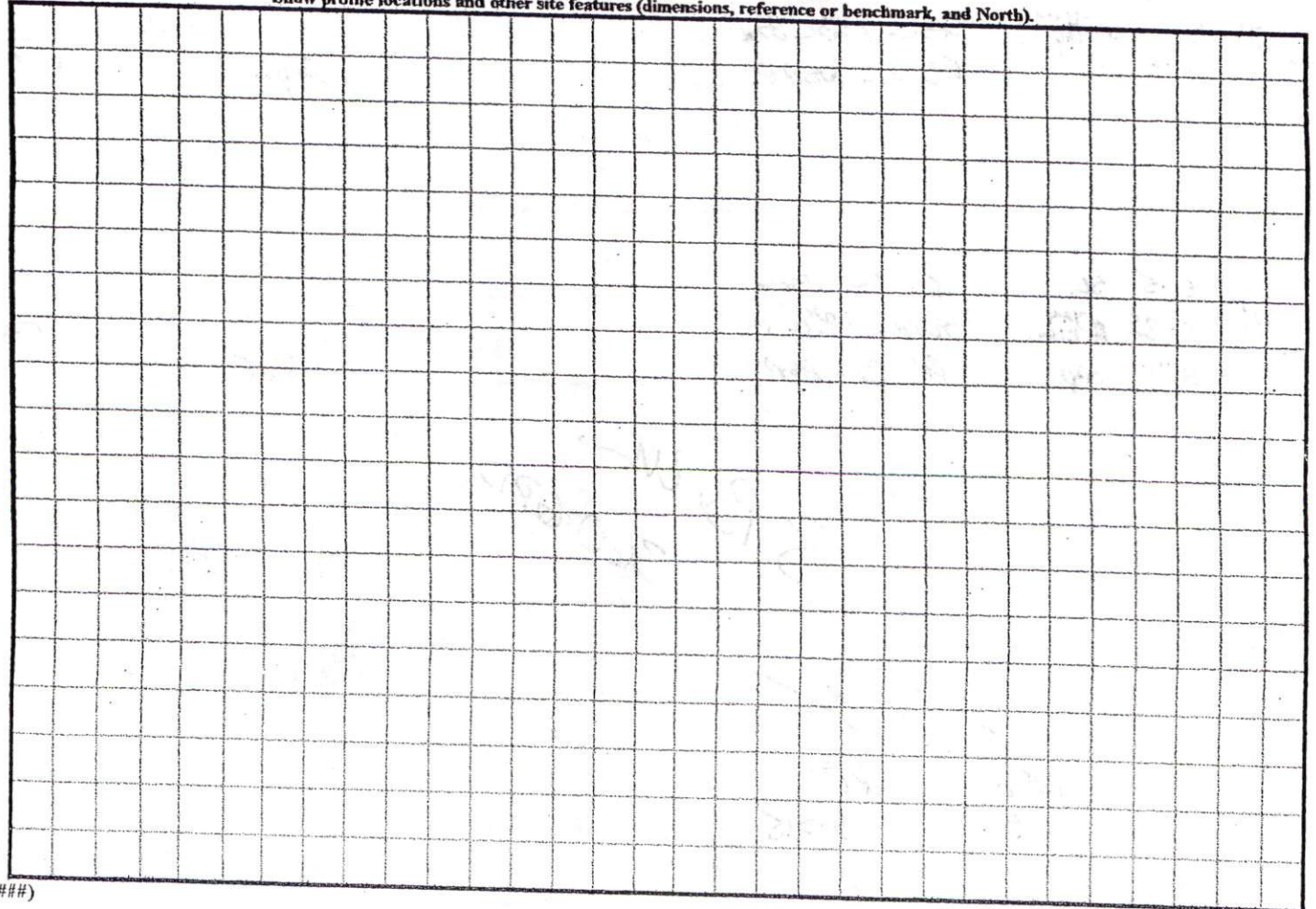

(#####)

1" = 20'

135.0x'

184.58'

41

Porch 25% open

37,000 25% red 24-5/8

50

49

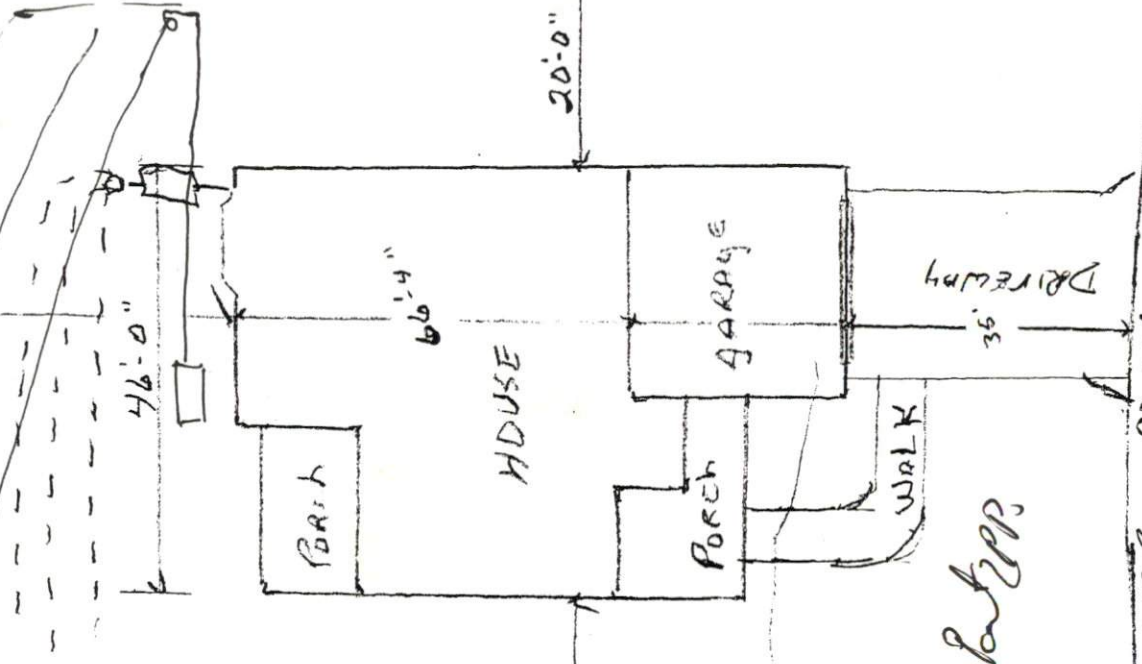

C18R - 80.00'

Scuppernon Lane

18'6"

SITE PLAN APPROVAL
 DISTRICT RA40 USE SED
 #BEDROOMS 3
 10/24/2005
 Zoning Administrator
 W. Bk