

**SOIL/SITE EVALUATION
 for ON-SITE WASTEWATER SYSTEM**

Owner: 05-50013047

Applicant:

Address:

Date Evaluated: 9.20

Proposed Facility: Home

Design Flow (.1949): 300

Property Size: .53A

Location of Site: SR1141

Property Recorded: unlk

Water Supply: Public Individual Well Spring Other

Evaluation Method: Auger Boring Pit Cut

Type of Wastewater: Sewage Industrial Process Mixed

1940 Landscape Position/ Slope%	Horizon Depth (IN.)	SOIL MORPHOLOGY 1941		OTHER PROFILE FACTORS				Profile Class & LTAR
		1941 Structure/ Texture	1941 Consistence Mineralogy	1942 Soil Wetness/ Color	1943 Soil Depth (IN.)	1956 Sapro Class	1944 Restr. Horiz	
	0-12	GR SL	VHR JR					.5
	12-14	SBK SCL	FR JR		48			
	0-30	GR SL	VHR JR					.5
	30-42	SBK SCL	FR JR		48			
	0-30	GR SL	VHR JR					.5
	30-42	SBK SCL	FR JR		48			
	0-30	GR SL	VHR JR					.5
	30-48	SBK SCL	FR JR		48			
	0-36	GR SL	VHR JR					.5
	36-48	SBK SCL	FR JR		48			
	0-36	GR SL	VHR JR					.5
	36-48	SBK SCL	FR JR		48			
	0-30	GR SL	VHR JR					.5
	30-42	SBK SCL	FR JR		48			

Description	Initial System	Repair System
Available Space (.1945)	✓	✓
System Type(s)	Gravel	Gravel
Site LTAR	.5	.4

Other Factors (.1946): _____
 Site Classification (.1948): _____
 Evaluated By: *[Signature]*
 Others Present: _____

COMMENTS: _____

<u>LANDSCAPE POSITIONS</u>	<u>GROUP</u>	<u>TEXTURES</u>	<u>.1955 LTAR</u>	<u>CONSISTENCE MOIST</u>	<u>WET</u>
R-RIDGE	I	S-SAND	1.2 - 0.8	VFR-VERY FRIABLE	NS-NON-STICKY
S-SHOULDER SLOPE		LS-LOAMY SAND			
L-LINEAR SLOPE	II	SL-SANDY LOAM	0.8 - 0.6	FR-FRIABLE	SS-SLIGHTLY STICKY
FS-FOOT SLOPE		L-LOAM			
N-NOSE SLOPE	III	SI-SILT-	0.6 - 0.3	FI-FIRM	S-STICKY
H-HEAD SLOPE		SIL-SILT LOAM			
CC-CONCLAVE SLOPE		CL-CLAY LOAM			
CV-CONVEX SLOPE		SCL-SANDY CLAY LOAM			
T-TERRACE	IV	SIC-SILTY CLAY	0.4 - 0.1	VFI-VERY FIRM	VS-VERY STICKY
FP-FLOOD PLAN		C-CLAY			
		SC-SANDY CLAY		EFI-EXTREMELY FIRM	NP-NON-PLASTIC
					SP-SLIGHTLY STICKY
					P-PLASTIC
					VP-VERY PLASTIC

STRUCTURE
 SG-SINGLE GRAIN
 M-MASSIVE
 CR-CRUMB
 GR-GRANULAR
 SBK-SUBANGULAR BLOCKY
 ABK-ANGULAR BLOCKY
 PL-PLATY
 PR-PRISMATIC

MINERALOGY
 SLIGHTLY EXPANSIVE
 EXPANSIVE

Show profile locations and other site features (dimensions, reference or benchmark, and North).

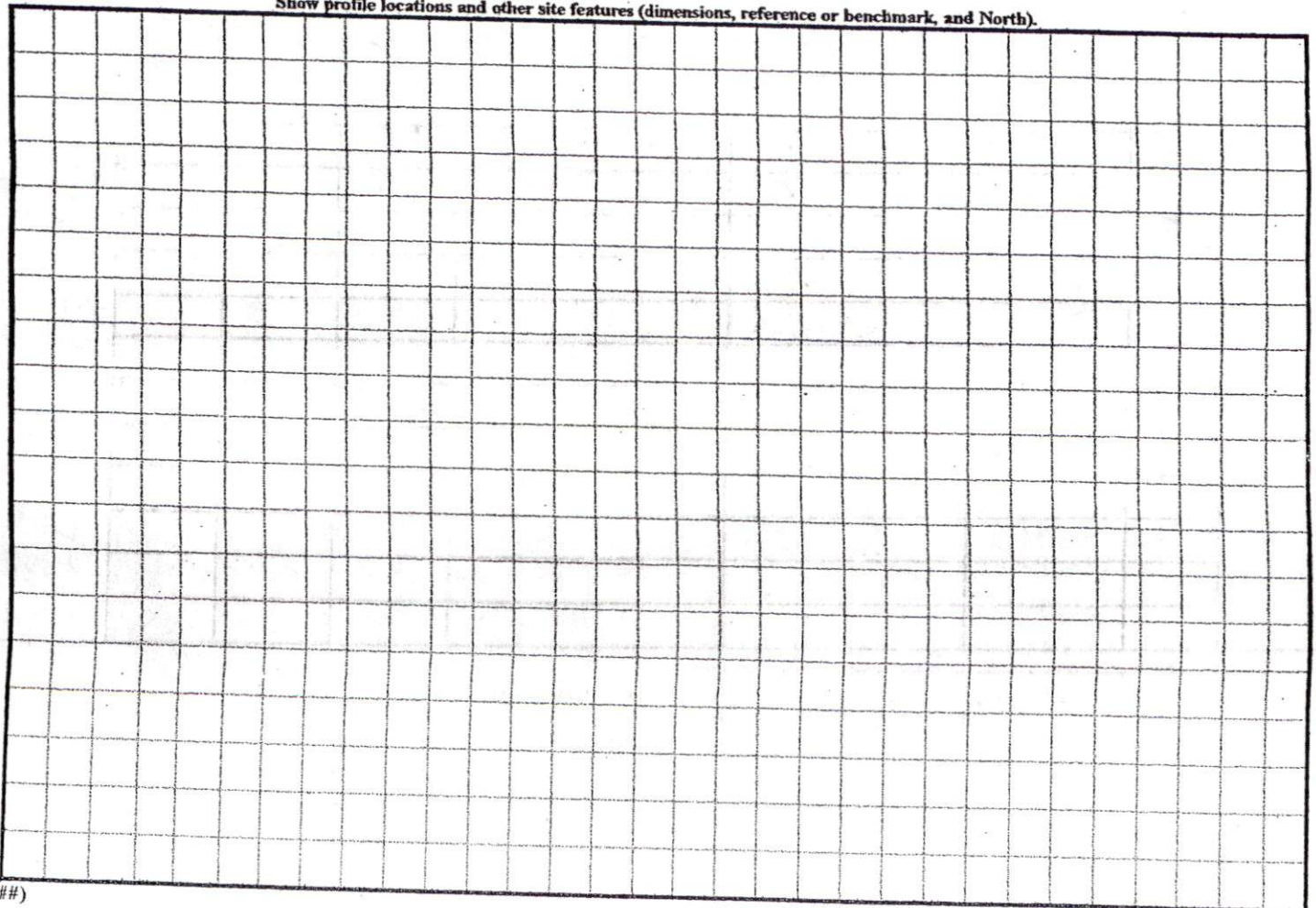

nva4

N 80°28'54"E 151.25'

1181
CHXJ

51

0.50 AC.

Handwritten scribbles

50

N 26°08'00"W 195.56'

S 07°24'00"E 176.02'

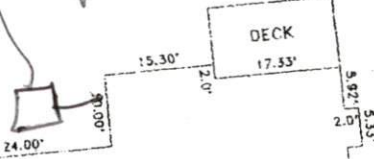

PROPOSED HOUSE LOCATION

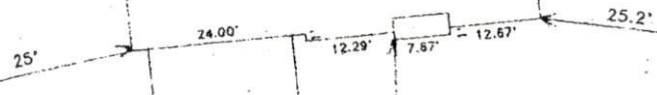

PROPOSED DRIVE

A=90.00' R=275.26'
S 73°14'03"W 89.60'

SITE PLAN APPROVAL
 DISTRICT RAZOR USE SFD
 #BEDROOMS 3
9/16/05 PR
 Zoning Admin. ...ator

"TIMBERLINE DRIVE" 50' R/W

1=20