

HTE# 15-5-12885

# IMPROVEMENT PERMIT 22778

Be it ordained by the Harnett County Board of Health as follows: Section III, Item B. "No person shall begin construction of any building at which a septic tank system is to be used for disposal of sewage without first obtaining a written permit from the Harnett County Health Department."

Name: (owner) EVANS FINE Homes INC New Installation  Septic Tank  Repair

Property Location: SR# 1443 LAFAYETTE RD Nitrification Line  Expansion

Subdivision V.H. Lot # 137

Tax ID# \_\_\_\_\_ Quadrant # \_\_\_\_\_

Number of Bedrooms Proposed: 3 3600 Lot Size: 25,000 sq ft

Basement with Plumbing:  Garage:

Water Supply:  Well  Public  Community

Distance From Well: 50' ft.

**Following is the minimum specifications for sewage disposal system on above captioned property. Subject to final approval.**

Type of system:  Conventional  Other 25% reduction system

Size of tank: Septic Tank: 1000 gallons Pump Tank: \_\_\_\_\_ gallons

Subsurface Drainage Field No. of ditches 2 ft. exact length of each ditch 160 ft. width of ditches 3 ft. depth of ditches 24 in.

French Drain Required: - Linear feet

Date: 11-8-05

PERMIT EXPIRES 5 YEARS FROM ABOVE DATE

**This permit is subject to revocation if site plans or intended use change.**

Signed: James E. Markant  
Environmental Health Specialist

\*  
STEPDOWNS  
WILL BE  
NEEDED.

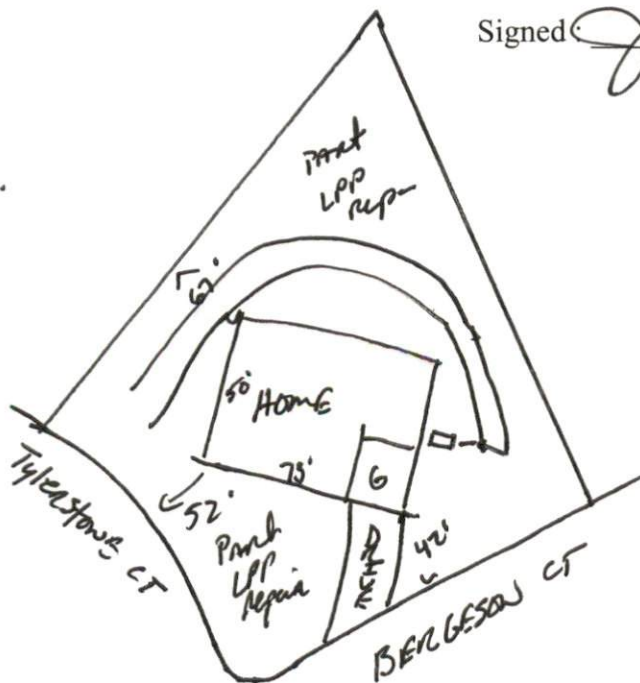

# HARNETT COUNTY DEPARTMENT OF PUBLIC HEALTH AUTHORIZATION TO CONSTRUCT

Authorization is hereby given to construct a wastewater system to the specifications described by Harnett County Department of Public Health, Improvement Permit # 22778. This authorization shall be valid for a period not to exceed five (5) years from the date of issuance. *This authorization will be invalid if ownership, site plans, or intended use change.*

Name EVANS FINE Homes INC Telephone # 552-1378

Address 201 MISTYWOOD DR F.V. N.C. 27526

Property Location SR# 1443 Road Name LATIMER RD

Subdivision V.H. Lot # 137 # Bedrooms Proposed 3 3606PD Lot Size 25,000 sq ft

### TYPE OF SYSTEM

New Installation    Repair    Septic Tank    Nitrification Lines  
 Conventional    Other 75% Reduction Syst  
 Basement    With Plumbing    Without Plumbing  
Water Supply:  Well    Public Water Supply Minimum Well Setback: \_\_\_\_\_ Ft.  
Septic Tank 1000 gal   Pump Chamber \_\_\_\_\_ gal

### NITRIFICATION FIELD SPECIFICATIONS

Number of fields 2 # of lines per field 2 Length of lines 160 Ft.  
Width of ditches 3 ft. Depth of ditches 24 inches  
French Drain: Linear feet required - Depth of gravel -

No wastewater system shall be covered or placed into use by any person until an inspection by the Harnett County Health Department has determined that the system has been installed according to the conditions of the Improvement Permit and that a valid Operations Permit has been issued.

Signature of Authorized Agent for Harnett County [Signature] Date 11-8-05