

HTE# 05-5-12840

IMPROVEMENT PERMIT 22260

Be it ordained by the Harnett County Board of Health as follows: Section III, Item B. "No person shall begin construction of any building at which a septic tank system is to be used for disposal of sewage without first obtaining a written permit from the Harnett County Health Department"

Name: (owner) Duncan Development (Riverstone) New Installation Septic Tank Repair

Property Location: SR# 1403 Cokesbury Rd. Nitrification Line Expansion

Subdivision Cokesbury Park Lot # 32

Tax ID# _____ Quadrant # _____

Number of Bedrooms Proposed : 3 (360 sq ft) Lot Size: .374c

Basement with Plumbing: Garage:

Water Supply: Well Public Community

Distance From Well: 50 ft.

Following is the minimum specifications for sewage disposal system on above captioned property. Subject to final approval.

Type of system: Conventional Other _____

Size of tank: Septic Tank: 1000 gallons Pump Tank: _____ gallons

Subsurface Drainage Field No. of ditches 3 ft. exact length of each ditch 50 ft. width of ditches 3 ft. depth of ditches 18-27 in.

French Drain Required: _____ Linear feet

Date: 10/11/2005

PERMIT EXPIRES 5 YEARS FROM ABOVE DATE

This permit is subject to revocation if site plans or intended use change.

Signed: Bryan McLaughlin
Environmental Health Specialist

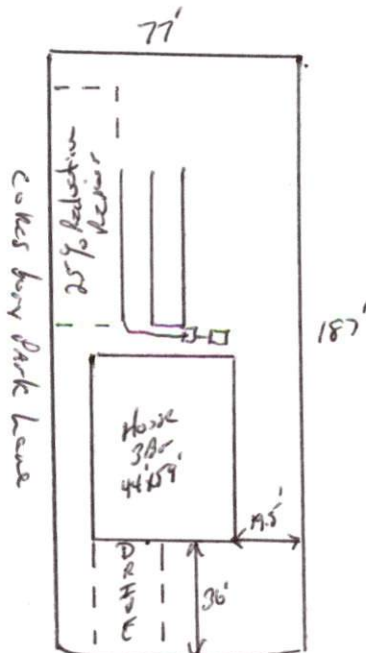

* Maintain all setbacks
 * Ditches to start out at 18" inches
 + down to NO DEEPER than
27 inches

HARNETT COUNTY DEPARTMENT OF PUBLIC HEALTH
AUTHORIZATION TO CONSTRUCT

Authorization is hereby given to construct a wastewater system to the specifications described by Harnett County Department of Public Health, Improvement Permit # 22260. This authorization shall be valid for a period not to exceed five (5) years from the date of issuance. *This authorization will be invalid if ownership, site plans, or intended use change.*

Donce Development Name 919 844 7884 Telephone #

1100 Meadow Wood Dr. Fuquay Varina, N.C. 27526 Address

1403 Property Location SR# Cokerbury Road Name

Cokerbury Park Subdivision 32 Lot # 3 (360 gpd) # Bedrooms Proposed .37 Ac Lot Size

TYPE OF SYSTEM

New Installation Repair Septic Tank Nitrification Lines

Conventional Other _____

Basement With Plumbing Without Plumbing

Water Supply: Well Public Water Supply Minimum Well Setback: 50 Ft.

Septic Tank 1000 gal Pump Chamber _____ gal

NITRIFICATION FIELD SPECIFICATIONS

Number of fields 1 # of lines per field 3 Length of lines 50 Ft.

Width of ditches 3 ft. Depth of ditches 18-27 inches

French Drain: Linear feet required _____ Depth of gravel _____

No wastewater system shall be covered or placed into use by any person until an inspection by the Harnett County Health Department has determined that the system has been installed according to the conditions of the Improvement Permit and that a valid Operations Permit has been issued.

Bryan McSwain, P.E.
Signature of Authorized Agent for Harnett County

10/11/2005
Date