

HARNETT COUNTY HEALTH DEPARTMENT

IMPROVEMENT PERMIT

21996

HTE 05-5-12811

Be it ordained by the Harnett County Board of Health as follows: Section III, Item B. "No Person shall begin construction of any building at which a septic tank system is to be used for disposal of sewage without first obtaining a written permit from the Harnett County Health Department."

Name: (owner) Paul + Tammy Heredia  New Installation  Septic Tank  
 Property Location: SR# 1425 Heredia Rd.  Repairs  Nitrification Line

Subdivision RA McLamb Lot # 3

Tax ID # \_\_\_\_\_ Quadrant # \_\_\_\_\_

Number of Bedrooms Proposed: 4 (480 sq. ft.) Lot Size: 1.324c

Basement with Plumbing:  Garage:

Water Supply:  Well  Public  Community

Distance From Well: 50 min ft.

Following is the minimum specifications for sewage disposal system on above captioned property. Subject to final approval.

Type of system:  Conventional  Other 25% Reduction System

Size of tank: Septic Tank: 1250 gallons Pump Tank: \_\_\_\_\_ gallons

Subsurface Drainage Field No. of ditches 4 exact length of each ditch 100 ft. width of ditches 3 ft. depth of ditches 18-20 in.

French Drain Required: \_\_\_\_\_ Linear feet

Date: 9/7/2005

This permit is subject to revocation if site plans or intended use change.

Signed: Bryan McSwain, P.E.  
 Environmental Health Specialist

- \* Maintain all setbacks
- \* Ditches to run on contour
- \* Contractor to meet on site prior to installing system
- \* System layout may differ from drawing depending on contour

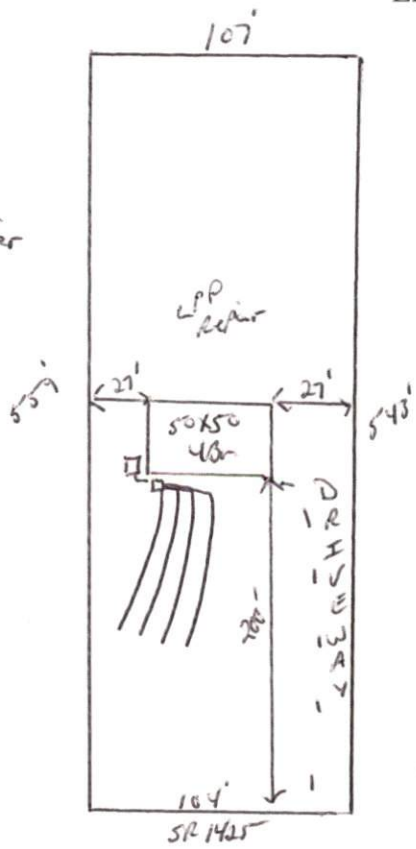

\* Not to scale

HARNETT COUNTY DEPARTMENT OF PUBLIC HEALTH  
AUTHORIZATION TO CONSTRUCT

Authorization is hereby given to construct a wastewater system to the specifications described by Harnett County Department of Public Health, Improvement Permit # 21996. This authorization shall be valid for a period not to exceed five (5) years from the date of issuance. *This authorization will be invalid if ownership, site plans, or intended use change.*

Name Paul + Tammy Heredia Telephone # 764-242-6564

Address \_\_\_\_\_

Property Location SR# 1425 Road Name Hardee

Subdivision RA McLamb Lot # 3 # Bedrooms Proposed 4 (450 gpd) Lot Size 1.33 ac

**TYPE OF SYSTEM**

New Installation    Repair    Septic Tank    Nitrification Lines

Conventional    Other 25% Reduction System

Basement    With Plumbing    Without Plumbing

Water Supply:  Well    Public Water Supply Minimum Well Setback: 50 Ft.

Septic Tank 1250 gal   Pump Chamber \_\_\_\_\_ gal

**NITRIFICATION FIELD SPECIFICATIONS**

Number of fields 1 # of lines per field 4 Length of lines 100 Ft.

Width of ditches 3 ft. Depth of ditches 18-20 inches

French Drain: Linear feet required \_\_\_\_\_ Depth of gravel \_\_\_\_\_

No wastewater system shall be covered or placed into use by any person until an inspection by the Harnett County Health Department has determined that the system has been installed according to the conditions of the Improvement Permit and that a valid Operations Permit has been issued.

Bryan McSwain P.E.  
Signature of Authorized Agent for Harnett County

9/7/2005  
Date