

HTE # 05-5-12747

HARNETT COUNTY HEALTH DEPARTMENT
ENVIRONMENTAL HEALTH SECTION

18440

OPERATIONS PERMIT

Name: (owner) A. L. Champion New Installation Septic Tank Repair

Property Location: SR# 1006 Nitrification Line Expansion

Subdivision William B. Ray Lot # 2 Tax ID # _____ Quadrant # _____

Contractor: Sarefact Septic Registration # _____

Basement with Plumbing: Garage:

Water Supply: Well Public Community

Distance From Well: 50 m ft.

Following are the specifications for the sewage disposal system on above captioned property.

Type of system: Conventional Other Quick 4 Chamber

Size of tank: Septic Tank: 1000 gallons Pump Tank: 1000 gallons

Subsurface Drainage Field No. of ditches 4 exact length of each ditch 75 ft. width of ditches 3 ft. depth of ditches 18 in.

French Drain Required: _____ Linear feet

Date: ~~21991~~ 9/15/2006

PERMIT NO. 21981

Inspected by: Bruce McLaughlin, R.S.

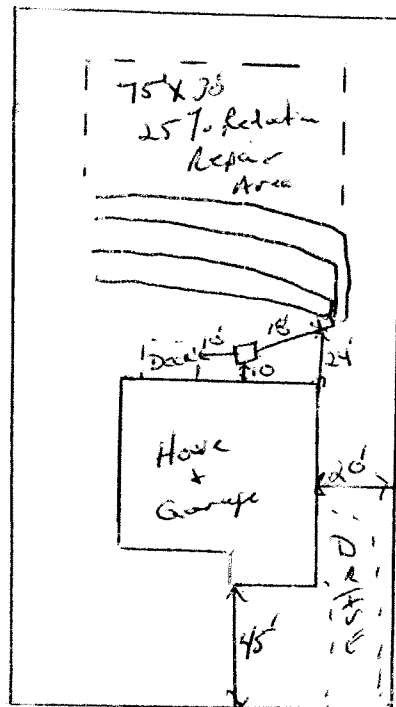

SR 1006