

Initial Application Date: 07/14/2005

Application # 05 50012000
1001800

COUNTY OF HARNETT LAND USE APPLICATION

Central Permitting 102 E. Front Street, Lillington, NC 27546

Phone: (910) 893-4759

Fax: (910) 893-2793

LANDOWNER: LESTER 3 ERIC E. BLAND Mailing Address: P.O. Box 1008
City: BROADWAY State: NC Zip: 27505 Phone #: (919) 499-6739
APPLICANT: ERIC E. BLAND Mailing Address: _____
City: _____ State: _____ Zip: _____ Phone #: _____

PROPERTY LOCATION: SR #: 1215 SR Name: NC SR OFF X ROSSER-PITTMAN RD
Address: 1215 NC SR OFF X
Parcel: 039588 0001 15 PIN: 9680-72-8437.000
Zoning: RA-20R Subdivision: RIVER BEND Lot #: 15 Lot Size: 13.88 A
Flood Plain: A Panel: 0015 Watershed: N/A Deed Book/Page: 1152/0563 Plat Book/Page: CITS

DIRECTIONS TO THE PROPERTY FROM LILLINGTON: GO NORTH ON HWY 421 TO TRAFFIC LIGHT AT SEMINOLE - TURN LEFT ON MACARTHUR - TURN RIGHT ON ROSSER-PITTMAN - APPROX. 3 MILES TURN LEFT ON LOWER RIVER ROAD - FOLLOW TO LOT 15.

PROPOSED USE:

- Sg. Family Dwelling (Size ___ x ___) # of Bedrooms ___ # Baths ___ Basement (w/wo bath) ___ Garage ___ Deck ___
- Multi-Family Dwelling No. Units ___ No. Bedrooms/Unit ___
- Manufactured Home (Size 14 x 80) # of Bedrooms 3 Garage N/A Deck N/A
- Number of persons per household 2
- Business Sq. Ft. Retail Space ___ Type ___
- Industry Sq. Ft. ___ Type ___
- Church Seating Capacity ___ Kitchen ___
- Home Occupation (Size ___ x ___) # Rooms ___ Use ___
- Additional Information: _____
- Accessory Building (Size ___ x ___) Use ___
- Addition to Existing Building (Size ___ x ___) Use ___
- Other _____

Additional Information: _____

Water Supply: County Well (No. dwellings 1) Other Environmental Health Site Visit Date: _____

Sewage Supply: New Septic Tank Existing Septic Tank County Sewer Other

Erosion & Sedimentation Control Plan Required? YES NO *see file for notes*

Property owner of this tract of land own land that contains a manufactured home w/in five hundred feet (500') of tract listed above? YES NO

Structures on this tract of land: Single family dwellings ___ Manufactured homes ___ Other (specify) proposed porch

Required Residential Property Line Setbacks:	Minimum	Actual
Front	35	<u>50'</u>
Rear	25	<u>1500 - 150'</u>
Side	10	<u>60.52'</u>
Corner	20	<u>/</u>
Nearest Building	10	<u>150</u>

If permits are granted I agree to conform to all ordinances and the laws of the State of North Carolina regulating such work and the specifications or plans submitted. I hereby swear that the foregoing statements are accurate and correct to the best of my knowledge.

Eric E. Bland
Signature of Owner or Owner's Agent

07/12/05
Date

This application expires 6 months from the initial date if no permits have been issued

A RECORDED SURVEY PLAT AND RECORDED DEED ARE REQUIRED WHEN APPLYING FOR A LAND USE APPLICATION

06/04
7/26 S

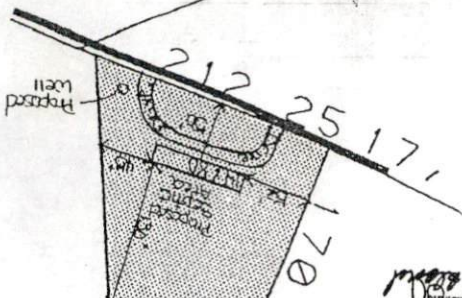

SITE PLAN APPROVAL
 DISTRICT R3302 USE SU11F
 #BEDROOMS 3
 DILLIBON, A. THOMAS
 Date 7-14-2005 OKW/14 19 2005

(1590)

(1405A)

(1225)

(1220)

Box 100
18.81

now low
2/12

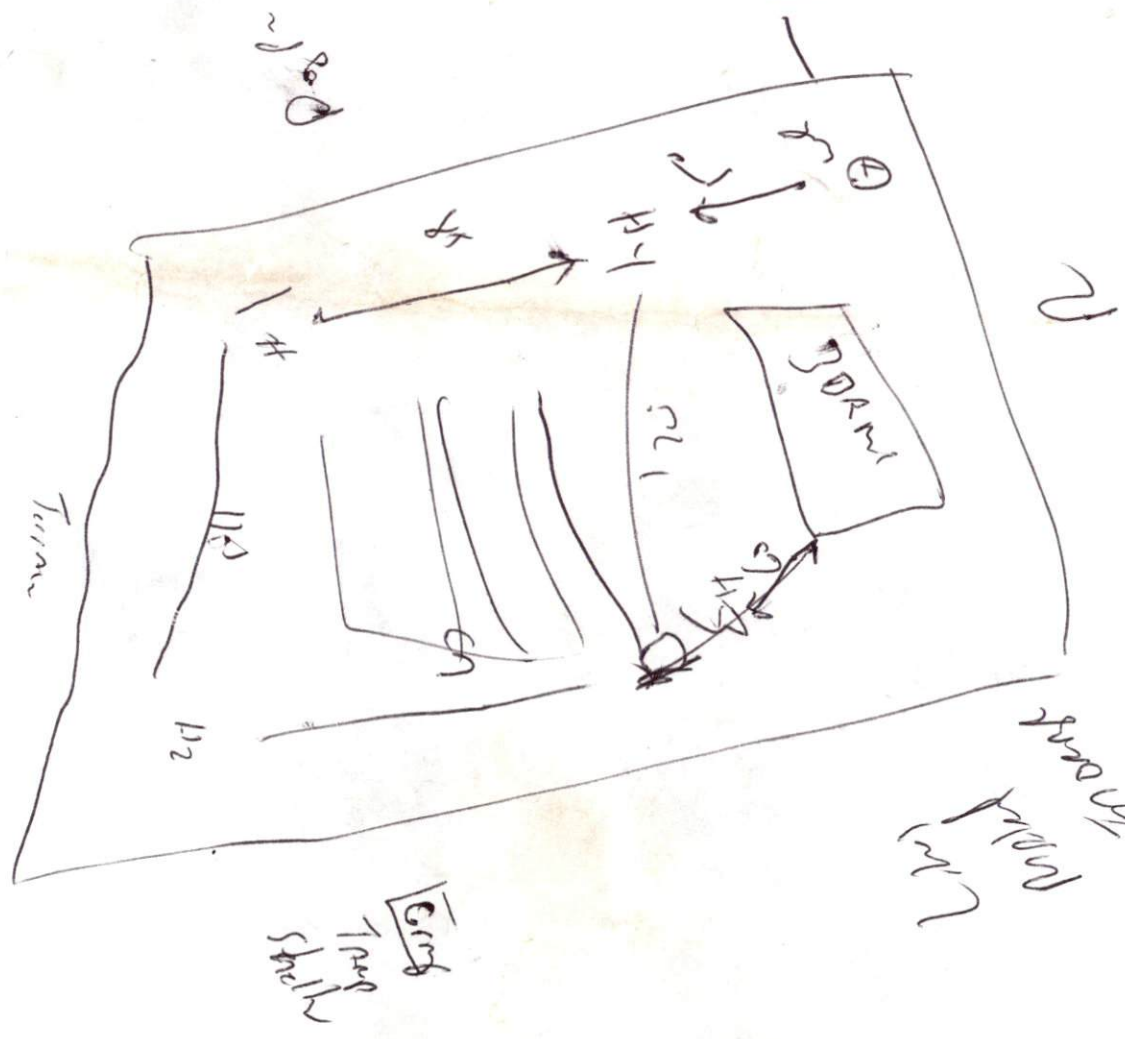

Grid
Top
Sheet

now low
2/12

2

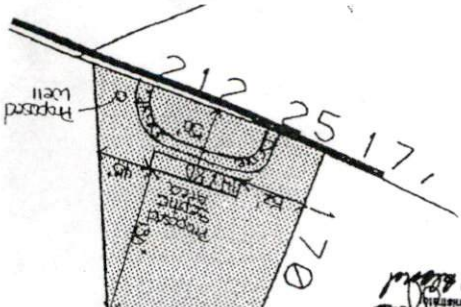

SITE PLAN APPROVAL

DISTRICT: RESOR USE SLIGHT

#BEDROOMS: 3

City of Chicago
 Planning Department
 Date: 7-14-2005 - 09:00 AM 19 8/2005

(1590)

(14 05A)

(1225)

(1220)

212
C
U
I
L
I
N
E
S
R
E
C
O
R
D
E
D

FILED
BOOK 1152 PAGE 563-565
'96 MAY 29 PM 2 42
GAYLE P. HOLDER
REGISTER OF DEEDS
HARNETT COUNTY, NC

HARNETT COUNTY NC
05/30/96
\$34.00
34.00
Real Estate
Excise Tax

9607165
SST-00
Excise Tax

Recording Time, Book and Page

Tax Lot No. Parcel Identifier No. 039588-0001-15
Verified by County on the day of 19
by

Mail after recording to Lester E. Bland and Eric C. Bland
P. O. Box 1008, Broadway, NC 27505-1008

This instrument was prepared by Paul J. Adcock (Staton, Perkinson, Doster et al)
Brief description for the index Lot 15 River Bend

NORTH CAROLINA GENERAL WARRANTY DEED

THIS DEED made this 28th day of May, 1996, by and between

GRANTOR GRANTEE

PAUL J. WALEN and wife,
NANCY J. WALEN
P O Box 332
Fayetteville NC 28302

LESTER E. BLAND AND
ERIC. E. BLAND
Jointly with rights of survivorship

Enter in appropriate block for each party: name, address, and, if appropriate, character of entity, e.g. corporation or partnership.
The designation Grantor and Grantee as used herein shall include said parties, their heirs, successors, and assigns, and shall include singular, plural, masculine, feminine or neuter as required by context.
WITNESSETH, that the Grantor, for a valuable consideration paid by the Grantee, the receipt of which is hereby acknowledged, has and by these presents does grant, bargain, sell and convey unto the Grantee in fee simple, all that certain lot or parcel of land situated in the City of Barbecue Township, Harnett County, North Carolina and more particularly described as follows:

BEING all of Lot No. 15 as shown on map entitled "River Bend", dated June 8, 1987, prepared by Thomas J. Matthews, RLS, and recorded in Plat Cabinet C, Slide 171-C, Harnett County. Reference to said map is hereby made for a more particular description.

HARNETT COUNTY TAX 109
03-9588-0001-15
BY AKL

Harnett County Planning Department

PO Box 65, Lillington, NC 27546

910-893-7527

Environmental Health New Septic Systems Test

Environmental Health Code 800

- Place "property flags" in each corner of lot. All property lines must be clearly flagged approximately every 50 feet between corners.
- Place "house corner flags" at each corner of where the house/manufactured home will sit. Use additional flagging to outline driveways, garages, decks, out buildings, swimming pools, etc.
- Place flags at locations as developed on site plan by Customer Service Technician and you.
- Place Environmental Health "orange" card in location that is easily viewed from road.
- If property is thickly wooded, Environmental Health requires that you clean out the undergrowth to allow the soil evaluation to be performed. Inspectors should be able to walk freely around site. *No grading of property should be done.*
- After preparing proposed site call the voice permitting system at 910-893-7527 and give code 800 for Environmental Health confirmation. Please note confirmation number given at end of recording for proof of request.
- To hear results, call IVR again. Once approved, proceed to Central Permitting for permits

Environmental Health Existing Tank Inspections

Environmental Health Code 800

- Place Environmental Health "orange" card in location that is easily viewed from road.
- Prepare for inspection by removing soil over door as diagram indicates. Loosen trap door cover. (Unless inspection is for a septic tank in a mobile home park)
- After preparing trapdoor call the voice permitting system at 910-893-7527 and give code **800** for Environmental Health confirmation. Please note confirmation number given at end of recording for proof of request.
- To hear results, call IVR again. Once approved, proceed to Central Permitting for permits

Health and Sanitation Inspections

Health and Sanitation Plan Review 826

- After submitting plans for food and lodging, call the voice permitting system at 910-893-7527 and give code **826** for Health and Sanitation confirmation. Please note confirmation number given at end of recording for proof of request.
- To hear results, call IVR again. Once approved, proceed to Central Permitting for permits

Fire Marshal Inspections

Fire Marshall Plan Review Code 804

- Call the voice permitting system at 910-893-7527 and give code **804** for plan review. Please note confirmation number given at end of recording for proof of request.
- To hear results, call IVR again. Once approved, proceed to Central Permitting for permits
- Pick up Fire Marshal's letter and place on job site until work is completed.

Public Utilities

- Place stake with "orange" tape/name thirty feet (30) from the center of the road at the location you wish to have water tap installed.
- Allow four to six weeks after application for water/sewer taps. Call Utilities at 893-7575 for technical assistance.

Building Inspections

- Call the voice permitting system at 910-893-7527 to schedule inspections. Please note confirmation number given at end of recording for proof of request.
- For new housing/set up permits must meet E 911 / Addressing guidelines prior to calling for final inspection.
- To hear results of inspections, call IVR again.

E911 Addressing

Addressing Confirmation Code 814

- Address numbers shall be mounted on the house, 3 inches high (5" for commercial).
- Numbers must be a contrasting color from house, must be clearly visible night and day at entrance of driveway if home is 100 ft or more from road, or if mailbox is on opposite side of road.
- Once you purchase permits and footing inspection has been approved call the voice permitting system at 910-893-7527 and give code **814** for address confirmation. This must be called in even if you have contacted E911 for verbal confirmation

Applicant Signature: [Signature]

Date: 7-14-05