

Initial Application Date: 6-15-05

Application # 05-50012401

Drive = Holly Oak Circle

COUNTY OF HARNETT LAND USE APPLICATION

Central Permitting 102 E. Front Street, Lillington, NC 27546 Phone: (910) 893-4759 Fax: (910) 893-2793

LANDOWNER: Woodshire Partners, LLC Mailing Address: 2929 Breezewood Ave., Ste. 5
City: Fayetteville State: NC Zip: 28303 Phone #: 910-486-4864

APPLICANT: Hilt Constructors, Inc. Mailing Address: 2929 Breezewood Ave. Ste. 20
City: Fayetteville State: NC Zip: 28303 Phone #: 910-486-4864

PROPERTY LOCATION: SR #: 1125 SR Name: Lemuel Black Rd.
Parcel: 9/6 01 0536 0028 51 PIN: _____
Zoning: HA200 Subdivision: Forest Oaks Lot #: 51 Lot Size: 0.53 AC
Flood Plain: X Panel: C155 Watershed: NA Deed Book/Page: 894/852 Plat Book/Page: Map 2005-401

DIRECTIONS TO THE PROPERTY FROM LILLINGTON: Hwy 27W to Nursery Rd. (SR 1117). Turn Left on Nursery Rd, left on Lemuel Black Rd. (SR 1125); Left on Valley Oak into Forest Oaks Subdivision.

PROPOSED USE:

Sg. Family Dwelling (Size 48x47) # of Bedrooms 3 # Baths 2 Basement (w/wo bath) NO Garage DBL Deck yes
 Multi-Family Dwelling No. Units _____ No. Bedrooms/Unit _____
 Manufactured Home (Size _____ x _____) # of Bedrooms _____ Garage _____ Deck _____
Comments: _____

Number of persons per household Spec.
 Business Sq. Ft. Retail Space _____ Type _____
 Industry Sq. Ft. _____ Type _____
 Home Occupation (Size _____ x _____) # Rooms _____ Use _____
 Accessory Building (Size _____ x _____) Use _____
 Addition to Existing Building (Size _____ x _____) Use _____
 Other _____

Water Supply: County Well (No. dwellings _____) Other _____

Sewage Supply: New Septic Tank Existing Septic Tank County Sewer Other _____

Erosion & Sedimentation Control Plan Required? YES NO

Structures on this tract of land: Single family dwellings 1 Manufactured homes _____ Other (specify) _____

Property owner of this tract of land own land that contains a manufactured home w/in five hundred feet (500') of tract listed above? YES NO

Required Property Line Setbacks:	Minimum	Actual	Minimum	Actual
Front	<u>35'</u>	<u>36.5'</u>	Rear	<u>25'</u>
Side	<u>10'</u>	<u>47.6'; 44.5'</u>	Corner	<u>20'</u>
Nearest Building	<u>1</u>	<u>1</u>		<u>6:30</u>

If permits are granted I agree to conform to all ordinances and the laws of the State of North Carolina regulating such work and the specifications or plans submitted. I hereby swear that the foregoing statements are accurate and correct to the best of my knowledge.

Signature of Applicant D. Ralph Huff, III

Date 6-10-05

This application expires 6 months from the date issued if no permits have been issued

A RECORDED SURVEY PLAT AND RECORDED DEED ARE REQUIRED WHEN APPLYING FOR A LAND USE PERMIT

6/21/05(S)

N 23°26'34"E 150.00'

S 00°35'55"W

Do not Disturb

LPP

repair

Do not Disturb

SE

51

UNSUITABLE SOIL

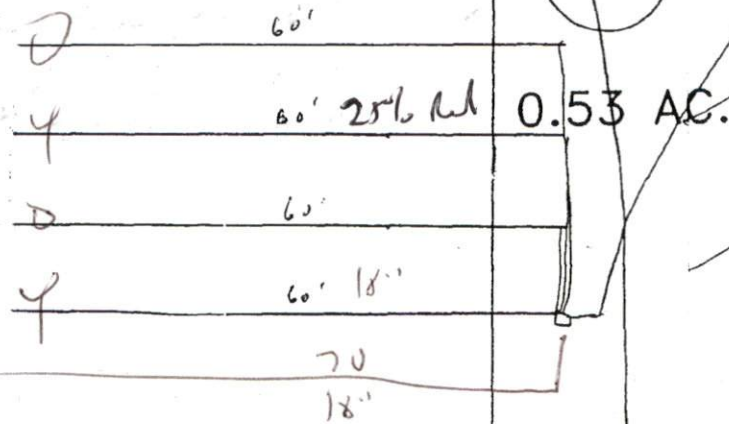

N 66°33'26"W 186.49'

240

4x5x

.4

255
x 20

SITE PLAN APPROVAL
 DISTRICT RAZOR USE SFD
 #BEDROOMS 3
Le 15-05
 ZONING ADMINISTRATOR

"LEMUEL BLACK RD." 60' R/W

Harnett County Planning Department

PO Box 65, Lillington, NC 27546
910-893-7527

Environmental Health New Septic Systems Test

Environmental Health Code 800

- Place "property flags" in each corner of lot. All property lines must be clearly flagged approximately every 50 feet between corners.
- Place "house corner flags" at each corner of where the house/manufactured home will sit. Use additional flagging to outline driveways, garages, decks, out buildings, swimming pools, etc.
- Place flags at locations as developed on site plan by Customer Service Technician and you.
- Place Environmental Health "orange" card in location that is easily viewed from road.
- If property is thickly wooded, Environmental Health requires that you clean out the undergrowth to allow the soil evaluation to be performed. Inspectors should be able to walk freely around site. *No grading of property should be done.*
- After preparing proposed site call the voice permitting system at 910-893-7527 and give code **800** for Environmental Health confirmation. Please note confirmation number given at end of recording for proof of request.
- To hear results, call IVR again. Once approved, proceed to Central Permitting for permits

Environmental Health Existing Tank Inspections

Environmental Health Code 800

- Place Environmental Health "orange" card in location that is easily viewed from road.
- Prepare for inspection by removing soil over door as diagram indicates. Loosen trap door cover. (Unless inspection is for a septic tank in a mobile home park)
- After preparing trapdoor call the voice permitting system at 910-893-7527 and give code **800** for Environmental Health confirmation. Please note confirmation number given at end of recording for proof of request.
- To hear results, call IVR again. Once approved, proceed to Central Permitting for permits

Health and Sanitation Inspections

Health and Sanitation Plan Review 826

- After submitting plans for food and lodging, call the voice permitting system at 910-893-7527 and give code **826** for Health and Sanitation confirmation. Please note confirmation number given at end of recording for proof of request.
- To hear results, call IVR again. Once approved, proceed to Central Permitting for permits

Fire Marshal Inspections

Fire Marshall Plan Review Code 804

- Call the voice permitting system at 910-893-7527 and give code **804** for plan review. Please note confirmation number given at end of recording for proof of request.
- To hear results, call IVR again. Once approved, proceed to Central Permitting for permits
- Pick up Fire Marshal's letter and place on job site until work is completed.

Public Utilities

- Place stake with "orange" tape/name thirty feet (30) from the center of the road at the location you wish to have water tap installed.
- Allow four to six weeks after application for water/sewer taps. Call Utilities at 893-7575 for technical assistance.

Building Inspections

- Call the voice permitting system at 910-893-7527 to schedule inspections. Please note confirmation number given at end of recording for proof of request.
- For new housing/set up permits must meet E 911 / Addressing guidelines prior to calling for final inspection.
- To hear results of inspections, call IVR again.

E911 Addressing

Addressing Confirmation Code 814

- Address numbers shall be mounted on the house, 3 inches high (5" for commercial).
- Numbers must be a contrasting color from house, must be clearly visible night and day at entrance of driveway if home is 100 ft or more from road, or if mailbox is on opposite side of road.
- Once you purchase permits and footing inspection has been approved call the voice permitting system at 910-893-7527 and give code **814** for address confirmation. This must be called in even if you have contacted E911 for verbal confirmation

Applicant Signature: Top Off Date: 6-15-05