

HTE # 05-5001232

RNETT COUNTY HEALTH DEPARTMENT
ENVIRONMENTAL HEALTH SECTION

18041

OPERATIONS PERMIT

Name: (owner) CAWHER New Installation Septic Tank Repair

Property Location: SR# 1125 Nitrification Line Expansion
Subdivision FORESTPARK Lot # 17 Tax ID # _____ Quadrant # _____

Contractor: D.C. CARTER Registration # _____

Basement with Plumbing: Garage:

Water Supply: Well Public Community
Distance From Well: 50 ft.

Following are the specifications for the sewage disposal system on above captioned property.

Type of system: Conventional Other Tire Chips

Size of tank: Septic Tank: 1000 gallons Pump Tank: _____ gallons

Subsurface Drainage Field No. of ditches 2 exact length of each ditch 10 ft. width of ditches 7 ft. depth of ditches 18-24 in.

French Drain Required: _____ Linear feet Date: 11-1-05

PERMIT NO. 22127 Inspected by: J. W. [Signature]

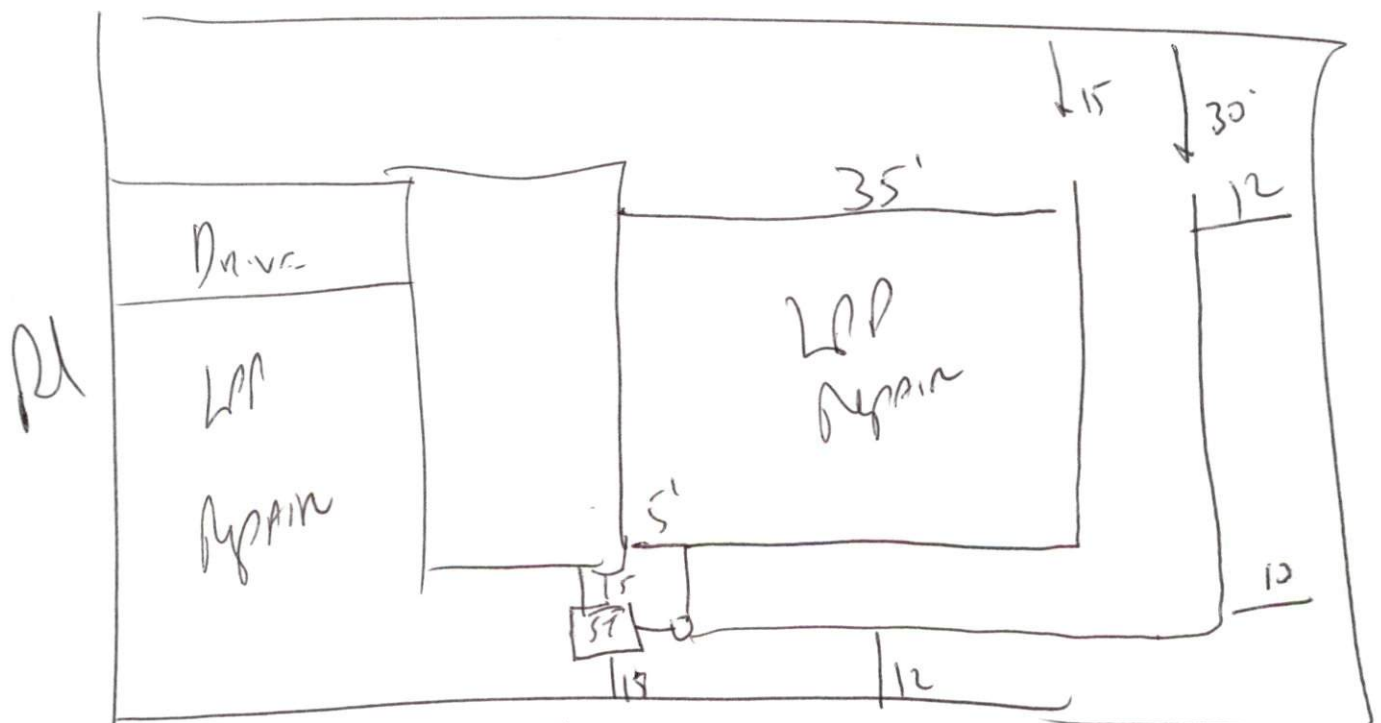

DC
SD-1000
510-833
9-24-05