

HARNETT COUNTY HEALTH DEPARTMENT

HTE 05-50012329

**IMPROVEMENT PERMIT**

**22126**

Be it ordained by the Harnett County Board of Health as follows: Section III, Item B. "No Person shall begin construction of any building at which a septic tank system is to be used for disposal of sewage without first obtaining a written permit from the Harnett County Health Department."

Name: (owner) CAVINESI Land Dev.  New Installation  Septic Tank  
Property Location: SR# 1125  Repairs  Nitrification Line

Subdivision FOREST OAKS Lot # 16

Tax ID # \_\_\_\_\_ Quadrant # \_\_\_\_\_

Number of Bedrooms Proposed: 3 (48x60) Lot Size: .38 AC

Basement with Plumbing:  Garage:

Water Supply:  Well  Public  Community

Distance From Well: 50 ft.

**Following is the minimum specifications for sewage disposal system on above captioned property. Subject to final approval.**

Type of system:  Conventional  Other \_\_\_\_\_

Size of tank: Septic Tank: 100 gallons Pump Tank: \_\_\_\_\_ gallons

Subsurface Drainage Field No. of ditches 2 exact length of each ditch 100 ft. width of ditches 3 ft. depth of ditches 18.00 in.

French Drain Required: \_\_\_\_\_ Linear feet

Date: 6-23-05

Signed: Joe Warr

Environmental Health Specialist

**This permit is subject to revocation if site plans or intended use change.**

*STUB Out Plumbing shallow - Ground level or higher MAINTAIN ALL SET BACKS*

*Turkey oak Circle*

*WPA REPAIR 240 LF*

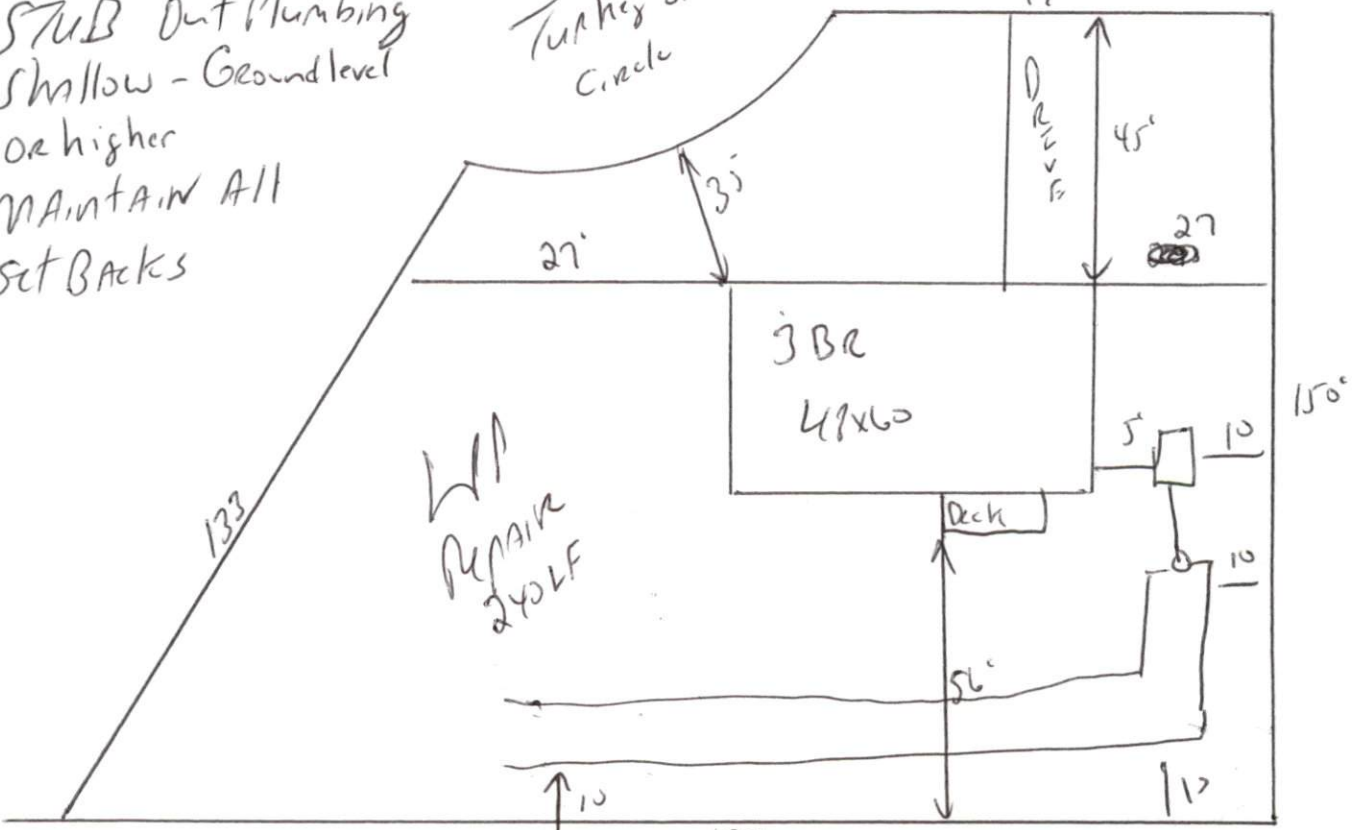

137

HARNETT COUNTY DEPARTMENT OF PUBLIC HEALTH  
AUTHORIZATION TO CONSTRUCT

Authorization is hereby given to construct a wastewater system to the specifications described by Harnett County Department of Public Health, Improvement Permit # 22126. This authorization shall be valid for a period not to exceed five (5) years from the date of issuance. *This authorization will be invalid if ownership, site plans, or intended use change.*

Caviness Land Dev.

Name

Telephone #

Address

1125

Property Location SR#

Forest Oak

Subdivision

16

Lot #

3 (48x60)

# Bedrooms Proposed

Road Name

38 AC

Lot Size

**TYPE OF SYSTEM**

New Installation [ ] Repair  Septic Tank  Nitrification Lines

Conventional [ ] Other \_\_\_\_\_

[ ] Basement [ ] With Plumbing [ ] Without Plumbing

Water Supply: [ ] Well  Public Water Supply Minimum Well Setback: 50 Ft.

Septic Tank 1000 gal Pump Chamber \_\_\_\_\_ gal

**NITRIFICATION FIELD SPECIFICATIONS**

Number of fields 1 # of lines per field 2 Length of lines 120 Ft.

Width of ditches 3 ft. Depth of ditches 18-20 inches

French Drain: Linear feet required \_\_\_\_\_ Depth of gravel \_\_\_\_\_

No wastewater system shall be covered or placed into use by any person until an inspection by the Harnett County Health Department has determined that the system has been installed according to the conditions of the Improvement Permit and that a valid Operations Permit has been issued.

Joe West RJ

Signature of Authorized Agent for Harnett County

6-23-05

Date