

HTE# 05-500 12237RR

# IMPROVEMENT PERMIT 22744

Be it ordained by the Harnett County Board of Health as follows: Section III, Item B. "No person shall begin construction of any building at which a septic tank system is to be used for disposal of sewage without first obtaining a written permit from the Harnett County Health Department."

Name: (owner) Regency Home New Installation  Septic Tank  Repair

Property Location: SR# 1115 Nitrification Line  Expansion

Subdivision Crestview Lot # 176

Tax ID# 53 x 43 <sup>10-25-05</sup> 716 Quadrant # \_\_\_\_\_

Number of Bedrooms Proposed: 3 (0 x 0) 360 sqd Lot Size: 75

Basement with Plumbing:  Garage:

Water Supply:  Well  Public  Community

Distance From Well: 50 ft.

Following is the minimum specifications for sewage disposal system on above captioned property. Subject to final approval.

Type of system:  Conventional  Other Pump to 2' wide chamber

Size of tank: Septic Tank: 1000 gallons Pump Tank: 1000 gallons

Subsurface Drainage Field No. of ditches 1 ft. exact length of each ditch 400 ft. width of ditches 3 ft. depth of ditches 18 in. <sup>MAX</sup>

French Drain Required: \_\_\_\_\_ Linear feet of 2' wide Chamber Revised

Date: 09-08-05 10-05-05

This permit is subject to revocation if site plans or intended use change. PERMIT EXPIRES 5 YEARS FROM ABOVE DATE

Signed: [Signature]  
Environmental Health Specialist

Meet on site for Final layout SYSTEMS Flagged off NOW - Try to prevent Flags Being Removed.

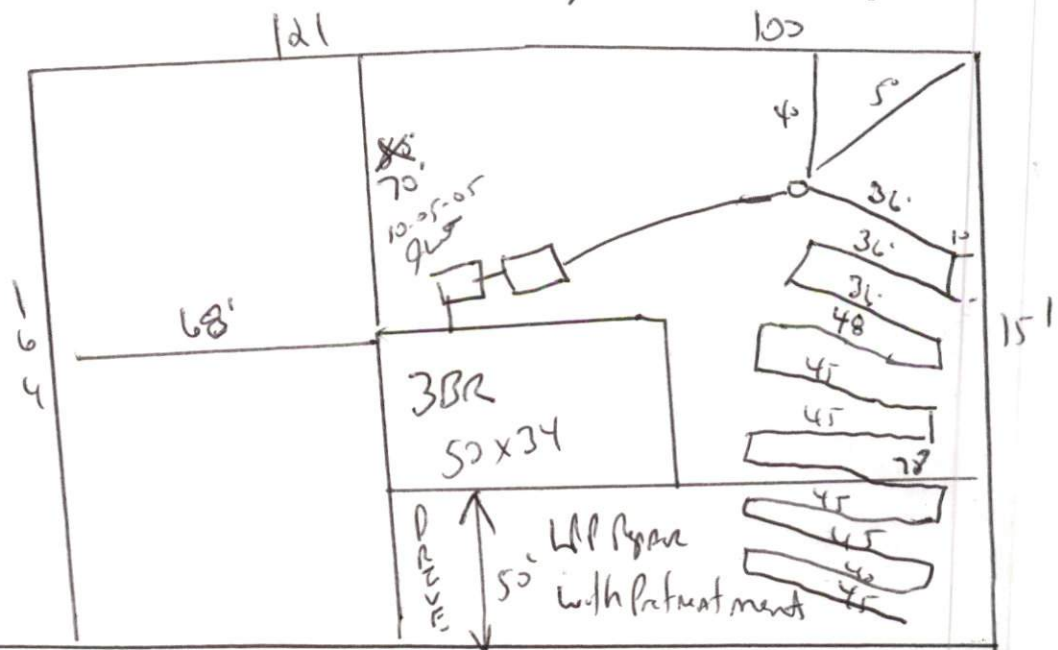

CRYSTAL Sprays Dance 123

HARNETT COUNTY DEPARTMENT OF PUBLIC HEALTH  
AUTHORIZATION TO CONSTRUCT

Authorization is hereby given to construct a wastewater system to the specifications described by Harnett County Department of Public Health, Improvement Permit # 22744. This authorization shall be valid for a period not to exceed five (5) years from the date of issuance. *This authorization will be invalid if ownership, site plans, or intended use change.*

Name Regency Home Telephone # \_\_\_\_\_

Address \_\_\_\_\_

Property Location SR# \_\_\_\_\_ Road Name \_\_\_\_\_

Subdivision Crestview Lot # 171 # Bedrooms Proposed 3 (50x74) 360 sqft Lot Size .75

**TYPE OF SYSTEM**

New Installation [ ] Repair  Septic Tank  Nitrification Lines

[ ] Conventional  Other Pump To 2' wide Chamber

[ ] Basement [ ] With Plumbing [ ] Without Plumbing

Water Supply: [ ] Well  Public Water Supply Minimum Well Setback: 50 Ft.

Septic Tank 1000 gal Pump Chamber 1000 gal

**NITRIFICATION FIELD SPECIFICATIONS**

Number of fields 1 # of lines per field 1 Length of lines 400 Ft.

Width of ditches 3 ft. Depth of ditches 18 inches 12' wide chamber

French Drain: Linear feet required \_\_\_\_\_ Depth of gravel \_\_\_\_\_

No wastewater system shall be covered or placed into use by any person until an inspection by the Harnett County Health Department has determined that the system has been installed according to the conditions of the Improvement Permit and that a valid Operations Permit has been issued.

Signature of Authorized Agent for Harnett County Joe West RS

Date 05-08-05