



Harnett County Government Complex
307 Cornelius Harnett Boulevard
Lillington, NC 27546

ph: 910-893-7550
fax: 910-893-9429

July 8, 2005

Regency Homes Inc
6506 Dental Lane
Fayetteville, NC 28314

Re: Status of Improvement Permit Application #05-5-12237- Lt 176 Crestview ~~cont.~~ DA → 967038
#05-5-12240- Lt 216 Crestview DA → 967001
Cont: 34649

Dear To Whom It May Concern,

On July 7, 2005, an Environmental Health Specialist from the Harnett County Health Department attempted to evaluate your property for the purpose of issuing an Improvement Permit. This individual was unable to evaluate your property for one or more of the following reasons.

- 1. Property lines/corners not marked or labeled
- 2. House corners not marked or labeled
- 3. Directions not clear to property
- 4. Property needs brush or vegetation removed
- 5. Backhoe pits required
- 6. Other As per phone call – clear lot and re-mark property and let me know when it is done.

When you have completed this, please call 910-893-7527 to confirm that the items mentioned have been corrected, we will then reschedule your property for evaluation.

Sincerely,

Joe West, R. S.
Environmental Health Specialist
Harnett County Department of Public Health

JW/ss
Copy: Central Permitting



Harnett County Government Complex
307 Cornelius Harnett Boulevard
Lillington, NC 27546

ph: 910-893-7550
fax: 910-893-9429

August 24, 2005

Regency Homes
6506 Dental Lane
Fayetteville, NC 28314

*"DA" HTE
Previously
disapproved -
can't leave
msg -*

Re: Status of Improvement Permit Application #05-5-12237

Dear To Whom It May Concern,

On August 23, 2005, an Environmental Health Specialist from the Harnett County Health Department attempted to evaluate your property for the purpose of issuing an Improvement Permit. This individual was unable to evaluate your property for one or more of the following reasons.

- 1. Property lines/corners not marked or labeled
- 2. House corners not marked or labeled
- 3. Directions not clear to property
- 4. Property needs brush or vegetation removed
- 5. Backhoe pits required
- 6. Other **Must submit new plot plan to Central Permitting and reconfirm through the IVR system. New plot plan must match your consultant's plan. See enclosed map.**

When you have completed this, please call 910-893-7527 to confirm that the items mentioned have been corrected, we will then reschedule your property for evaluation.

Sincerely,

Joe West, R. S.
Environmental Health Specialist
Harnett County Department of Public Health

JW/ss
Copy: Central Permitting

Southeastern Soil & Environmental Associates, Inc.

P.O. Box 9321
Fayetteville, NC 28311
Phone/Fax (910) 822-4540

Crestview
Lot 176

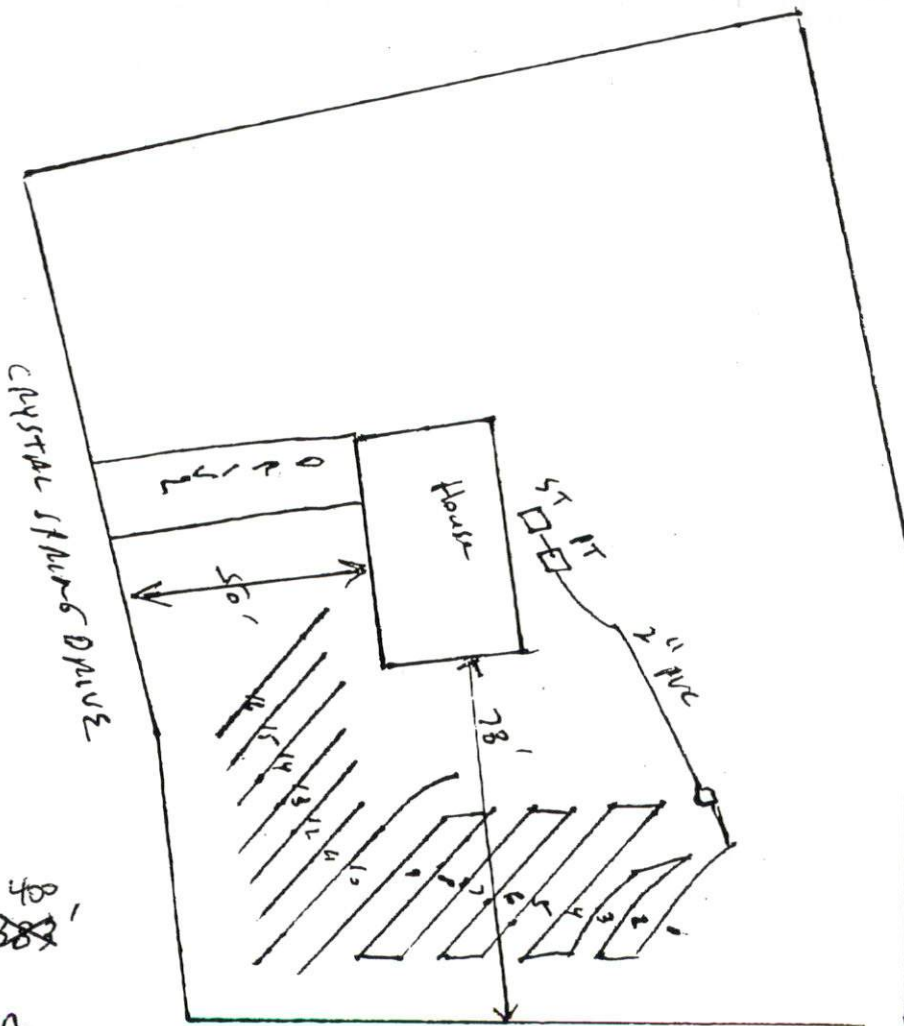

INITIAL 40
PUMP TO 1x ~~30x~~ 30'
2' INFILTRATOR
18'

REPAIR
Pretreatment w/ LPP

1" = 40'