

HTE# 0550012184

IMPROVEMENT PERMIT 22680

Be it ordained by the Harnett County Board of Health as follows: Section III, Item B. "No person shall begin construction of any building at which a septic tank system is to be used for disposal of sewage without first obtaining a written permit from the Harnett County Health Department."

Name: (owner) CAVINESS Land Dev. New Installation Septic Tank Repair
Property Location: SR# 1125 Nitrification Line Expansion
Subdivision FOREST OAKS Lot # 5
Tax ID# _____ Quadrant # _____
Number of Bedrooms Proposed: 3 (48x54) Lot Size: .344 AC

Basement with Plumbing: Garage:
Water Supply: Well Public Community
Distance From Well: 50 ft. Tine chips OK

Following is the minimum specifications for sewage disposal system on above captioned property. Subject to final approval.

Type of system: Conventional Other _____

Size of tank: Septic Tank: 1000 gallons Pump Tank: _____ gallons

Subsurface No. of exact length width of depth of
Drainage Field ditches 2 ft. of each ditch 120 ft. 3 ft. ditches 18-30 in.

French Drain Required: _____ Linear feet

Date: 6-1-05
PERMIT EXPIRES 5 YEARS FROM ABOVE DATE

This permit is subject to revocation if site plans or intended use change.

Signed: [Signature]
Environmental Health Specialist

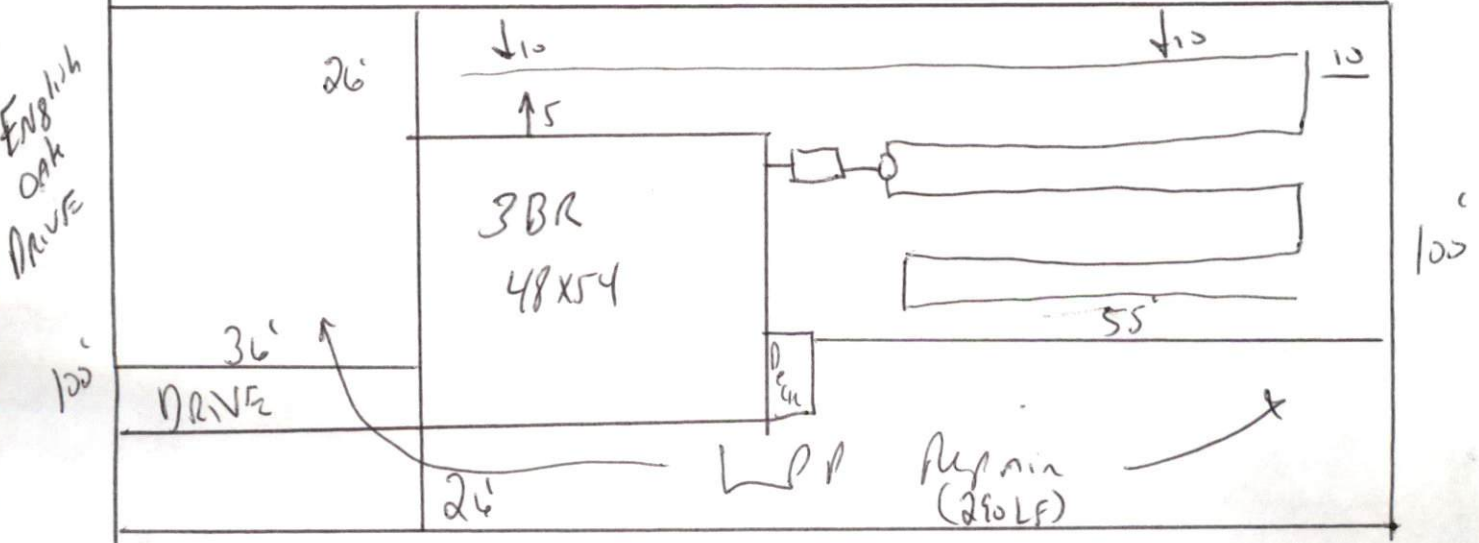

STUD out Plumbing shallow
Maintain 4' set back

HARNETT COUNTY DEPARTMENT OF PUBLIC HEALTH
AUTORIZATION TO CONSTRUCT

Authorization is hereby given to construct a wastewater system to the specifications described by Harnett County Department of Public Health, Improvement Permit # 22680. This authorization shall be valid for a period not to exceed five (5) years from the date of issuance. *This authorization will be invalid if ownership, site plans, or intended use change.*

Caviness Land Dev
Name _____ Telephone # _____

Address _____

1125
Property Location SR# _____ Road Name _____

Forest Oaks 5 3(48x54) 1.344 ac
Subdivision Lot # # Bedrooms Proposed Lot Size

TYPE OF SYSTEM

New Installation [] Repair Septic Tank Nitrification Lines

Conventional [] Other _____

[] Basement [] With Plumbing [] Without Plumbing

Water Supply: [] Well Public Water Supply Minimum Well Setback: 50 Ft.

Septic Tank 1000 gal Pump Chamber _____ gal

NITRIFICATION FIELD SPECIFICATIONS

Number of fields 1 # of lines per field 2 Length of lines 120 Ft.

Width of ditches 3 ft. Depth of ditches 18.30 inches

French Drain: Linear feet required _____ Depth of gravel _____

No wastewater system shall be covered or placed into use by any person until an inspection by the Harnett County Health Department has determined that the system has been installed according to the conditions of the Improvement Permit and that a valid Operations Permit has been issued.

Jon West RJ
Signature of Authorized Agent for Harnett County

6-1-05
Date