

HTE 05-5-12090

IMPROVEMENT PERMIT

22013

Be it ordained by the Harnett County Board of Health as follows: Section III, Item B. "No Person shall begin construction of any building at which a septic tank system is to be used for disposal of sewage without first obtaining a written permit from the Harnett County Health Department."

Name: (owner) James Jackson
Property Location: SR# 1443 Lafayette 120
New Installation, Septic Tank, Repairs, Nitrification Line

Subdivision Victoria Hills Lot # 49

Tax ID # Quadrant #

Number of Bedrooms Proposed: 3 Lot Size: .69

Basement with Plumbing: Garage:
Water Supply: Well, Public, Community

Distance From Well: 50' ft.

Following is the minimum specifications for sewage disposal system on above captioned property. Subject to final approval.

Type of system: Conventional, Other Pump to 25% Reducir System

Size of tank: Septic Tank: 1000 gallons Pump Tank: 1000 gallons

Subsurface Drainage Field No. of ditches 1 exact length of each ditch 240 ft. width of ditches 3 ft. depth of ditches 20-28 in.

French Drain Required: Linear feet

Date: 5-17-05

This permit is subject to revocation if site plans or intended use change. Signed: James E. Montfort Environmental Health Specialist

* Contractor to MEET ON SITE.
* System Type AND layout may CHANGE.

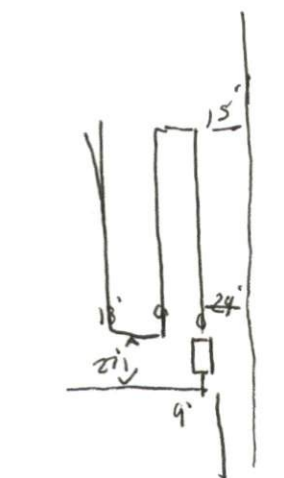

* Hold DRIVE Tight to THIS SIDE OF Home.

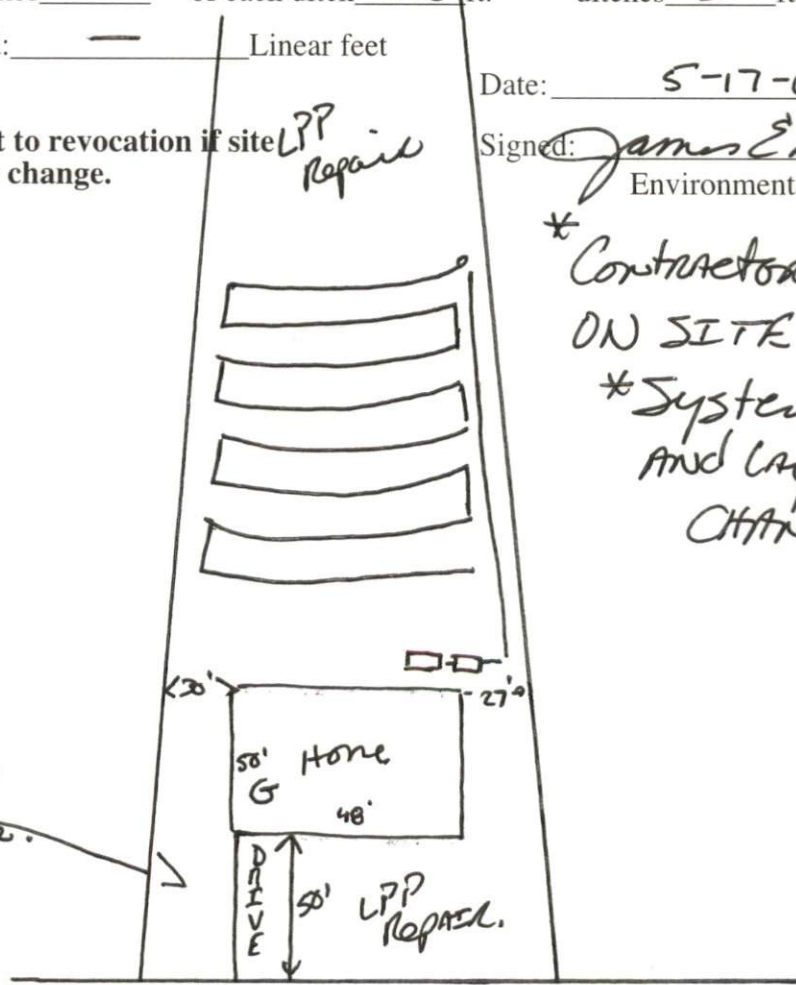

Tylerstone DR

HARNETT COUNTY DEPARTMENT OF PUBLIC HEALTH
AUTHORIZATION TO CONSTRUCT

Authorization is hereby given to construct a wastewater system to the specifications described by Harnett County Department of Public Health, Improvement Permit # 22013. This authorization shall be valid for a period not to exceed five (5) years from the date of issuance. *This authorization will be invalid if ownership, site plans, or intended use change.*

Name James Jackson Telephone # 910-892-6288

Address 9026 West Broad St DUNN N.C. 28334

Property Location SR# 1443 Road Name LAFAYETTE RD

Subdivision V.H. Lot # 49 # Bedrooms Proposed 3 Lot Size .69

TYPE OF SYSTEM

New Installation Repair Septic Tank Nitrification Lines

Conventional Other Pump to 25% Reduction System

Basement With Plumbing Without Plumbing

Water Supply: Well Public Water Supply Minimum Well Setback: _____ Ft.

Septic Tank 1000 gal Pump Chamber 1000 gal

NITRIFICATION FIELD SPECIFICATIONS

Number of fields 2 # of lines per field 1 Length of lines 240 Ft.

Width of ditches 3 ft. Depth of ditches 20-18 inches

French Drain: Linear feet required _____ Depth of gravel _____

No wastewater system shall be covered or placed into use by any person until an inspection by the Harnett County Health Department has determined that the system has been installed according to the conditions of the Improvement Permit and that a valid Operations Permit has been issued.

James E. Markant
Signature of Authorized Agent for Harnett County

5-17-05
Date