

HTE 05-5-12054

IMPROVEMENT PERMIT

22041

Be it ordained by the Harnett County Board of Health as follows: Section III, Item B. "No Person shall begin construction of any building at which a septic tank system is to be used for disposal of sewage without first obtaining a written permit from the Harnett County Health Department."

Name: (owner) STRONG Built Homes
Property Location: SR# 1403 Kipling RD
New Installation, Septic Tank, Repairs, Nitrification Line

Subdivision _____ Lot # 1

Tax ID # _____ Quadrant # _____

Number of Bedrooms Proposed: 3 Lot Size: 1.381

Basement with Plumbing: [] Garage: [x]

Water Supply: [] Well [x] Public [] Community

Distance From Well: 50' ft.

Following is the minimum specifications for sewage disposal system on above captioned property. Subject to final approval.

Type of system: [] Conventional [x] Other MANITEX Pumps 25% Reduction System

Size of tank: Septic Tank: 1000 gallons Pump Tank: 1000 gallons

Subsurface Drainage Field No. of ditches 3 exact length of each ditch 90 ft. width of ditches 3 ft. depth of ditches 18"-20" max in.

French Drain Required: - Linear feet

This permit is subject to revocation if site plans or intended use change.
Signed: James E. Montant, Environmental Health Specialist

*CONTRACTOR TO MEET ON SITE PRIOR TO INSTALLATION

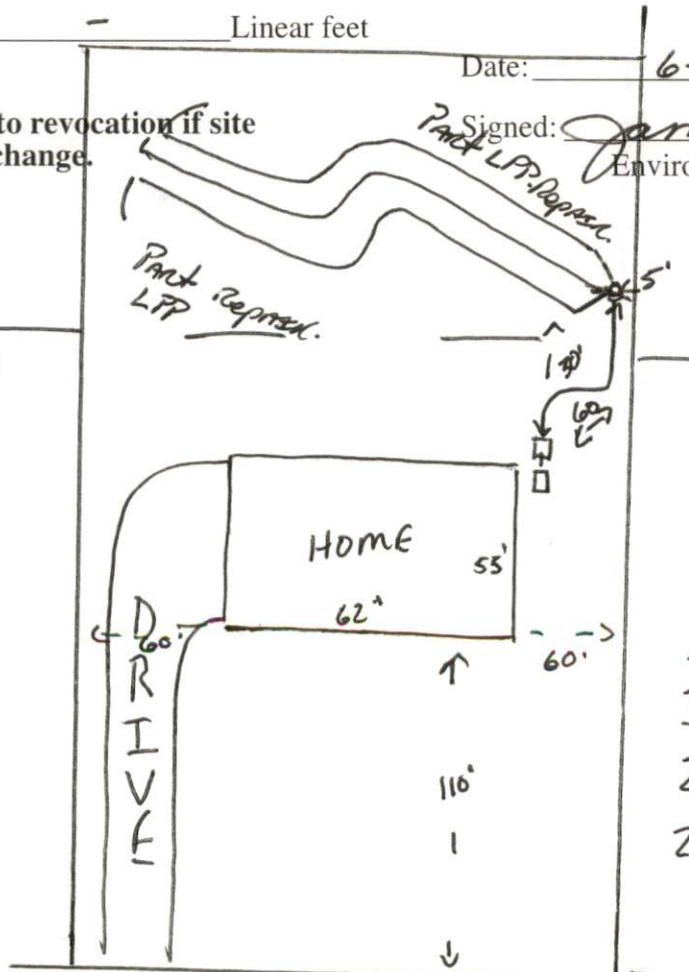

Pump Specs
40 gpm @ 12' TDH
MANITEX Specs
3-3/4" sch 40 Valves
2' Pressure Head
2" sch 40 supply Pipe

SR 1403 Kipling RD

05-5-12054

HARNETT COUNTY DEPARTMENT OF PUBLIC HEALTH
AUTORIZATION TO CONSTRUCT

Authorization is hereby given to construct a wastewater system to the specifications described by Harnett County Department of Public Health, Improvement Permit # 22041. This authorization shall be valid for a period not to exceed five (5) years from the date of issuance. *This authorization will be invalid if ownership, site plans, or intended use change.*

Name STRONG Built Homes Telephone # 919-662-2624

Address 732 Trebor Dr CAROLINA N.C. 27526

Property Location SR# 1403 Road Name Keplig

Subdivision _____ Lot # 1 # Bedrooms Proposed 3 Lot Size 1.392

TYPE OF SYSTEM

New Installation Repair Septic Tank Nitrification Lines

Conventional Other MANITEX Pump to 25% Reduct Sys

Basement With Plumbing Without Plumbing

Water Supply: Well Public Water Supply Minimum Well Setback: _____ Ft.

Septic Tank 1000 gal Pump Chamber 1000 gal

NITRIFICATION FIELD SPECIFICATIONS

Number of fields 2 # of lines per field 3 Length of lines 90 Ft.

Width of ditches 3 ft. Depth of ditches 18-20' inches

French Drain: Linear feet required _____ Depth of gravel _____

No wastewater system shall be covered or placed into use by any person until an inspection by the Harnett County Health Department has determined that the system has been installed according to the conditions of the Improvement Permit and that a valid Operations Permit has been issued.

James C. Mahant
Signature of Authorized Agent for Harnett County

6-22-05
Date