

**SOIL/SITE EVALUATION  
 for ON-SITE WASTEWATER SYSTEM**

Owner:

Applicant:

Address:

Date Evaluated:

Proposed Facility:

Design Flow (.1949):

Property Size:

Location of Site:

Property Recorded:

- Water Supply:  Public  Individual  Well  Spring  Other
- Evaluation Method:  Auger Boring  Pit  Cut
- Type of Wastewater:  Sewage  Industrial Process  Mixed

P R O F I L E #	1940 Landscape Position/ Slope%	Horizon Depth (IN.)	SOIL MORPHOLOGY .1941		OTHER PROFILE FACTORS				Profile Class & LTAR
			1941 Structure/ Texture	1941 Consistence Mineralogy	1942 Soil Wetness/ Color	1943 Soil Depth (IN.)	1956 Sapro Class	1944 Restr Horiz	
1	L 3%	0-12	SL	PR GR NSWP					.4
		12-18	SS clay cov SL	SL PR GR NSWP					
		18-28	SAP GR						
		28-48	SAP GR	PR GR NSWP			I		
2	L	0-36	SL	PR GR NSWP					.4
		36-48	SL	SUB GR NSWP	42				

Description	Initial System	Repair System
Available Space (.1945)		
System Type(s)	25% red	UPP - INNOV
Site LTAR	.4	.4

Other Factors (.1946): \_\_\_\_\_

Site Classification (.1948): \_\_\_\_\_

Evaluated By: \_\_\_\_\_

Others Present: \_\_\_\_\_

COMMENTS: \_\_\_\_\_

\_\_\_\_\_

\_\_\_\_\_

<u>LANDSCAPE POSITIONS</u>	<u>GROUP</u>	<u>TEXTURES</u>	<u>.1955 LTAR</u>	<u>CONSISTENCE MOIST</u>	<u>WET</u>
R-RIDGE	I	S-SAND	1.2 - 0.8	VFR-VERY FRIABLE FR-FRIABLE FI-FIRM VFI-VERY FIRM EFI-EXTREMELY FIRM	NS-NON-STICKY SS-SLIGHTLY STICKY S-STICKY VS-VERY STICKY NP-NON-PLASTIC SP-SLIGHTLY STICKY P-PLASTIC VP-VERY PLASTIC
S-SHOULDER SLOPE		LS-LOAMY SAND			
L-LINEAR SLOPE	II	SL-SANDY LOAM	0.8 - 0.6		
FS-FOOT SLOPE		L-LOAM			
N-NOSE SLOPE	III	SI-SILT-	0.6 - 0.3		
H-HEAD SLOPE		SIL-SILT LOAM			
CC-CONCLAVE SLOPE		CL-CLAY LOAM			
CV-CONVEX SLOPE		SCL-SANDY CLAY LOAM			
T-TERRACE		SICL-SILTY CLAY LOAM			
FP-FLOOD PLAN	IV	SIC-SILTY CLAY	0.4 - 0.1		
		C-CLAY			
		SC-SANDY CLAY			

STRUCTURE

- SG-SINGLE GRAIN
- M-MASSIVE
- CR-CRUMB
- GR-GRANULAR
- SBK-SUBANGULAR BLOCKY
- ABK-ANGULAR BLOCKY
- PL-PLATY
- PR-PRISMATIC

MINERALOGY

- SLIGHTLY EXPANSIVE
- EXPANSIVE

Show profile locations and other site features (dimensions, reference or benchmark, and North).

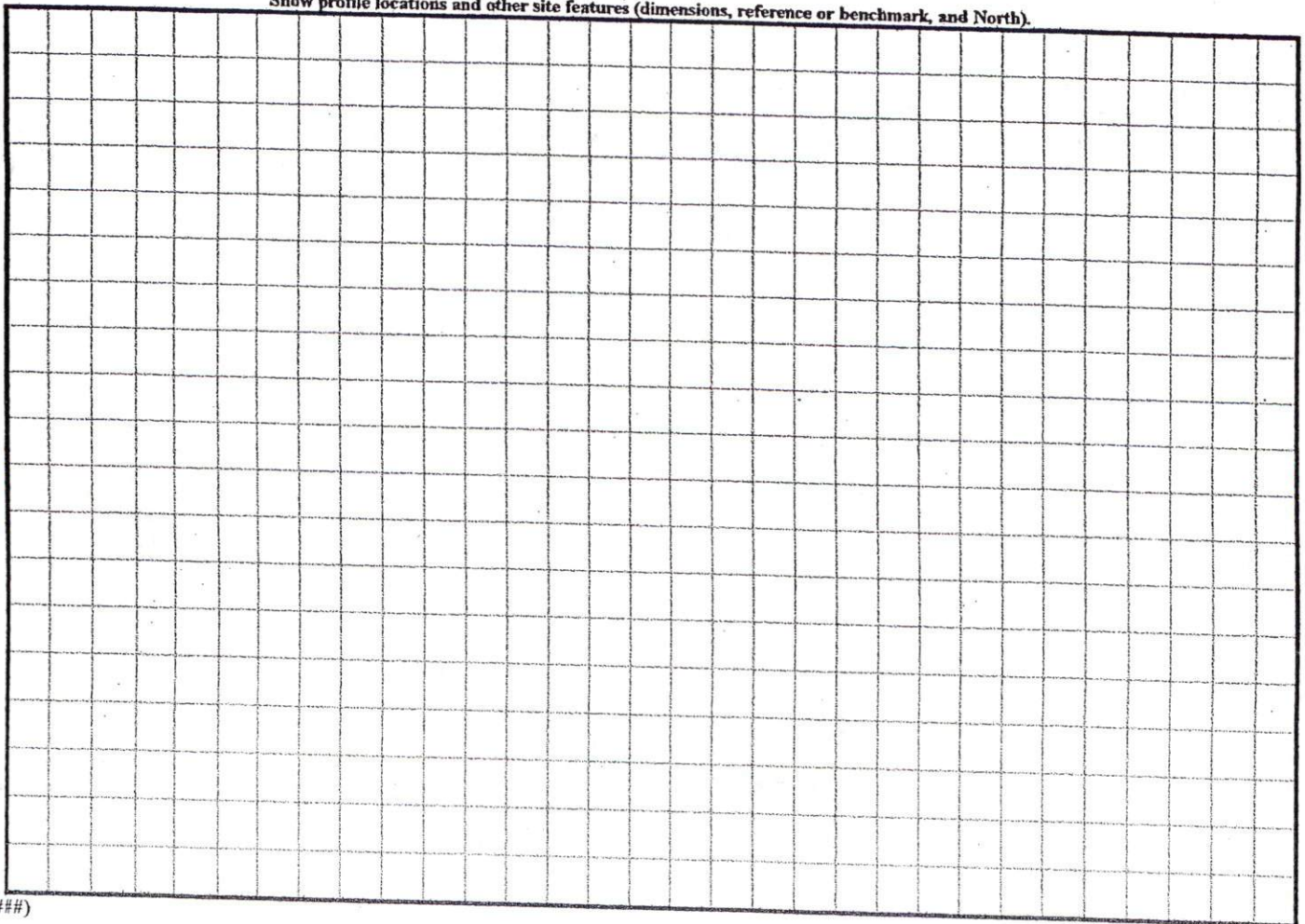



Graham F. Howard, Sr.  
 D.B. 1354, Pg. 449  
 PIN 0664-88-0720

Run of Raccoon Branch  
 is Property Line

MAP NORTH



Map # 2004-458

\*\* A 10' wide Utility Easement centered on each lot line shall extend from the street right of way line onto the lots for a distance of 20' for the installation, maintenance, monitoring and inspection of utility fixtures. No objects such as fences and landscaping which impedes access to such fixtures shall be placed within this easement.

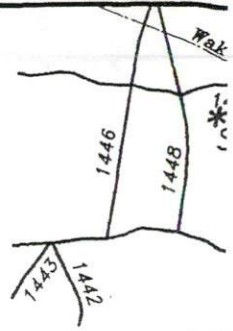

VII

Lot 2, Wyndham Map

Su

Ashwood  
 Home

Black River

Scale: 1" = 50'

Survey

STH

LAND SURVEY

870 N.C. Hwy. 101

910-897-7711

~PRELIMINARY

- Not

This plan represents  
 to a lot of record  
 review and approval  
 and inspections

NOT FINAL

25,267 sq. ft.

PIN 0664-88-6944

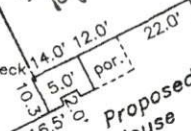

35' MBL  
 Proposed Drive  
 (S 26°59'37"E)  
 R=390.40' L=100.00'

SITE PLAN APPROVAL

DISTRICT RA30 USE SFD

#BEDROOMS 3

5/2/05

ZONING ADMINISTRATOR

\*\* SEE NOTE  
 20' Utility Esmt.

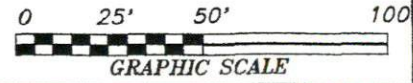

N.C.S.R. 1415 60' R/W  
 "Rawls Church Road"  
 (Public Dedicated)

Wyndham Place Drive 50' R/W

