

HTE # 05-50011875

ARNETT COUNTY HEALTH DEPARTMENT  
ENVIRONMENTAL HEALTH SECTION

18038

# OPERATIONS PERMIT

Name: (owner) Home Works Custom  New Installation  Septic Tank  Repair

Property Location: SR# 1202  Nitrification Line  Expansion  
Subdivision PAT Chalmer Lot # — Tax ID # — Quadrant # —

Contractor: Ted Brown Registration # —

Basement with Plumbing:  Garage:

Water Supply:  Well  Public  Community  
Distance From Well: 50 ft.

Following are the specifications for the sewage disposal system on above captioned property.

Type of system:  Conventional  Other Tire Chips

Size of tank: Septic Tank: 1200 gallons Pump Tank: — gallons

Subsurface Drainage Field No. of ditches 1 exact length of each ditch 320 ft. width of ditches 3 ft. depth of ditches 18-24 in.

French Drain Required: — Linear feet Date: 11-1-05

PERMIT NO. 21832 Inspected by: [Signature]

RL

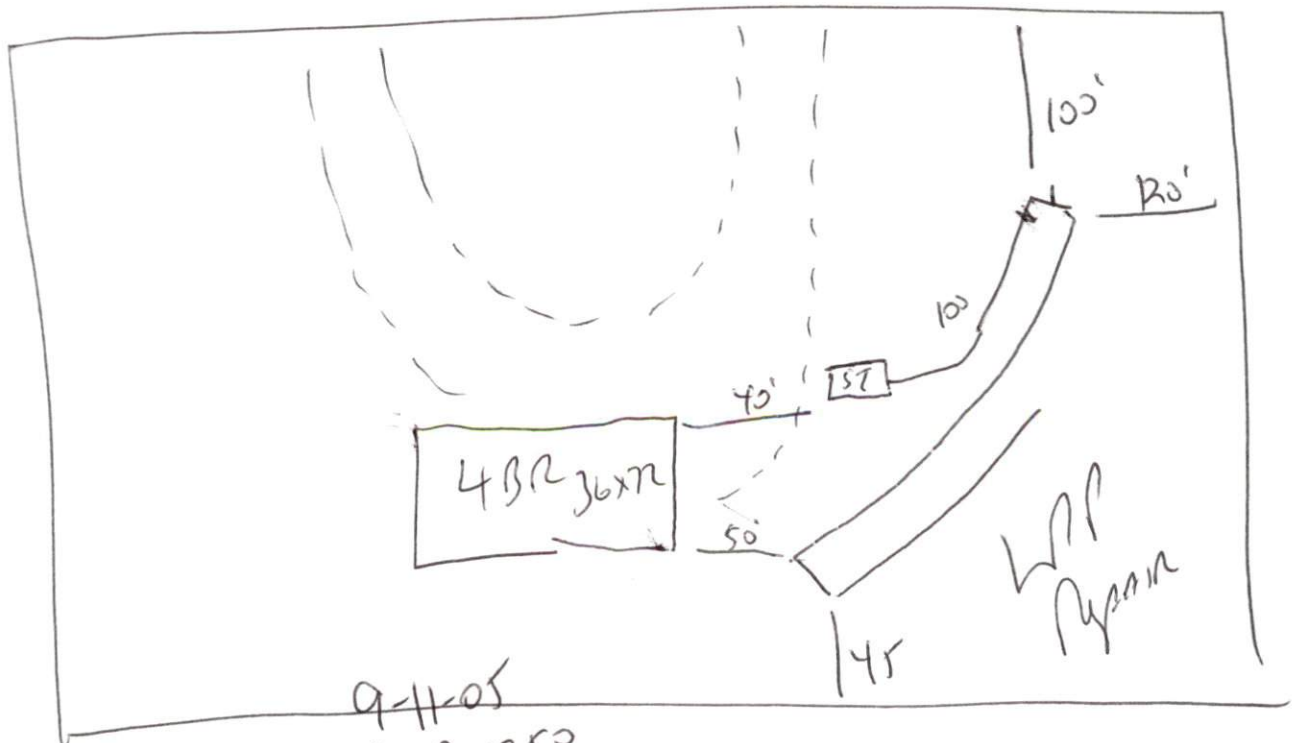

9-11-05  
MCP-1250  
SIB-381