

HARNETT COUNTY HEALTH DEPARTMENT

IMPROVEMENT PERMIT

21747

HTE 05-5-11728

Be it ordained by the Harnett County Board of Health as follows: Section III, Item B. "No Person shall begin construction of any building at which a septic tank system is to be used for disposal of sewage without first obtaining a written permit from the Harnett County Health Department."

Name: (owner) Oak City Homes New Installation Septic Tank
 Property Location: SR# 1567 Ballard Rd. Repairs Nitrification Line

Subdivision Ballard Woods Lot # 31

Tax ID # _____ Quadrant # _____

Number of Bedrooms Proposed: 3 Lot Size: .71 Ac

Basement with Plumbing: Garage:

Water Supply: Well Public Community

Distance From Well: 50 min ft.

Following is the minimum specifications for sewage disposal system on above captioned property. Subject to final approval.

Type of system: Conventional Other 25% reduction system

Size of tank: Septic Tank: 1000 gallons Pump Tank: _____ gallons

Subsurface Drainage Field No. of ditches 1 exact length of each ditch 300 ft. width of ditches 3 ft. depth of ditches 18-24 in.

French Drain Required: _____ Linear feet

Date: 4/14/2005

Signed: [Signature]
 Environmental Health Specialist

This permit is subject to revocation if site plans or intended use change.

- *Maintain all setbacks
- *Land: tiles on contour

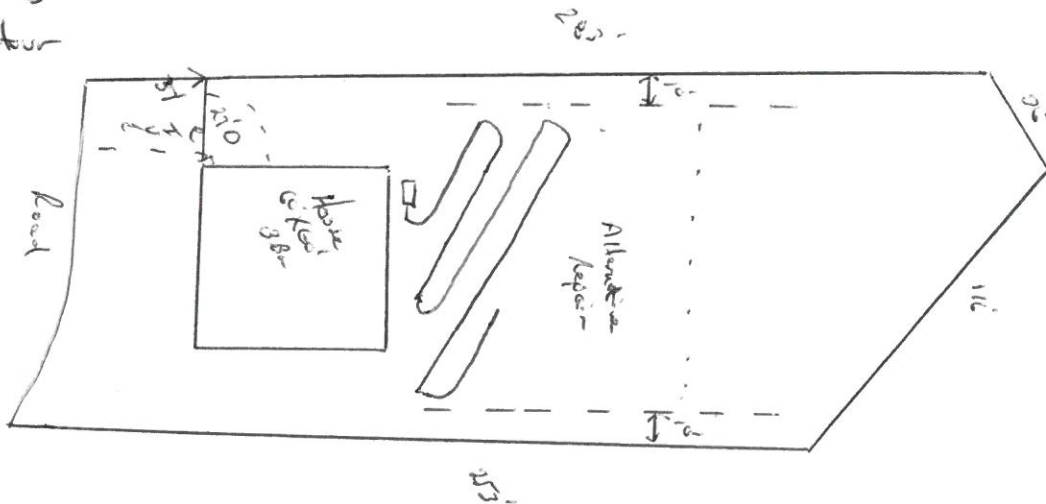

HARNETT COUNTY DEPARTMENT OF PUBLIC HEALTH
AUTHORIZATION TO CONSTRUCT

Authorization is hereby given to construct a wastewater system to the specifications described by Harnett County Department of Public Health, Improvement Permit # 21747. This authorization shall be valid for a period not to exceed five (5) years from the date of issuance. *This authorization will be invalid if ownership, site plans, or intended use change.*

Oak City Home Name 919 4223318 Telephone #

Box 6127 Raleigh, N.C. 27628 Address

1507 Property Location SR# Belland Road Name

Belland Woods Subdivision 31 Lot # 3 # Bedrooms Proposed 71Ac Lot Size

TYPE OF SYSTEM

New Installation Repair Septic Tank Nitrification Lines

Conventional Other 25% Reduct. System

Basement With Plumbing Without Plumbing

Water Supply: Well Public Water Supply Minimum Well Setback: 50 Ft.

Septic Tank 1000 gal Pump Chamber _____ gal

NITRIFICATION FIELD SPECIFICATIONS

Number of fields 1 # of lines per field 1 Length of lines 300 Ft.

Width of ditches 3 ft. Depth of ditches 18-24 inches

French Drain: Linear feet required _____ Depth of gravel _____

No wastewater system shall be covered or placed into use by any person until an inspection by the Harnett County Health Department has determined that the system has been installed according to the conditions of the Improvement Permit and that a valid Operations Permit has been issued.

[Signature]
Signature of Authorized Agent for Harnett County

4/14/2005
Date