

HTE 05-5-11692

IMPROVEMENT PERMIT

21865

Be it ordained by the Harnett County Board of Health as follows: Section III, Item B. "No Person shall begin construction of any building at which a septic tank system is to be used for disposal of sewage without first obtaining a written permit from the Harnett County Health Department."

Name: (owner) Leon Anderson Const New Installation Septic Tank
Property Location: SR# 1415 Rawls Ch RD Repairs Nitrification Line

Subdivision _____ Lot # 2R

Tax ID # _____ Quadrant # _____

Number of Bedrooms Proposed: 4 Lot Size: 28.292

Basement with Plumbing: Garage:

Water Supply: Well Public Community

Distance From Well: 50' ft.

Following is the minimum specifications for sewage disposal system on above captioned property. Subject to final approval.

Type of system: Conventional Other _____

Size of tank: Septic Tank: 1200 gallons Pump Tank: _____ gallons

Subsurface Drainage Field No. of 2 exact length 250 ft. width of 3 ft. depth of 22-28 in.
Ditches 200 ft. of each ditch 100 ft. 16/05/06

French Drain Required: - Linear feet

Date: 4-5-05

This permit is subject to revocation if site plans or intended use change.

Signed: James E. Markant
Environmental Health Specialist

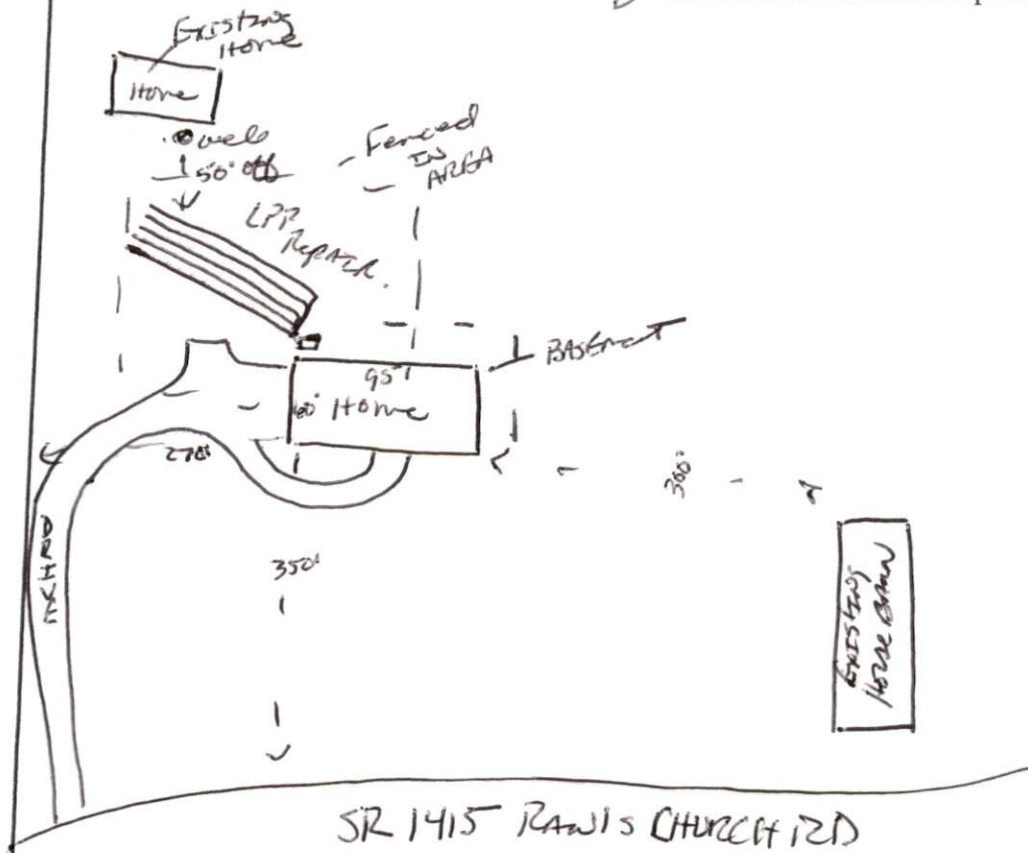

HARNETT COUNTY DEPARTMENT OF PUBLIC HEALTH
AUTHORIZATION TO CONSTRUCT

Authorization is hereby given to construct a wastewater system to the specifications described by Harnett County Department of Public Health, Improvement Permit # 21865. This authorization shall be valid for a period not to exceed five (5) years from the date of issuance. *This authorization will be invalid if ownership, site plans, or intended use change.*

Leon Anderson Construction 919-552-4158
Name Telephone #

6212 Rauls Church RD F.V. N.C. 27526
Address

1415 Rauls Church RD
Property Location SR# Road Name

212 4 28,292
Subdivision Lot # # Bedrooms Proposed Lot Size

TYPE OF SYSTEM

New Installation Repair Septic Tank Nitrification Lines

Conventional Other _____

Basement With Plumbing Without Plumbing

Water Supply: Well Public Water Supply Minimum Well Setback: _____ Ft.

Septic Tank 1200 gal Pump Chamber _____ gal

NITRIFICATION FIELD SPECIFICATIONS

Number of fields 2 # of lines per field 5 Length of lines 100 Ft.

Width of ditches 3 ft. Depth of ditches 22-18 inches

French Drain: Linear feet required - Depth of gravel -

No wastewater system shall be covered or placed into use by any person until an inspection by the Harnett County Health Department has determined that the system has been installed according to the conditions of the Improvement Permit and that a valid Operations Permit has been issued.

James E. Montfort
Signature of Authorized Agent for Harnett County

4-5-05
Date