

HTE 05-5-11691

IMPROVEMENT PERMIT

21746

Be it ordained by the Harnett County Board of Health as follows: Section III, Item B. "No Person shall begin construction of any building at which a septic tank system is to be used for disposal of sewage without first obtaining a written permit from the Harnett County Health Department."

Name: (owner) Showcase Construction New Installation Septic Tank
Property Location: SR# 1124 Lombard Rd. Repairs Nitrification Line

Subdivision Westfield Farm Lot # 28

Tax ID # _____ Quadrant # _____

Number of Bedrooms Proposed: 3 Lot Size: 39 Ac

Basement with Plumbing: Garage:

Water Supply: Well Public Community

Distance From Well: 50 min ft.

Following is the minimum specifications for sewage disposal system on above captioned property. Subject to final approval.

Type of system: Conventional Other Pump to 25% reduction system

Size of tank: Septic Tank: 1000 gallons Pump Tank: 1000 gallons

Subsurface Drainage Field No. of ditches 3 exact length of each ditch 100 ft. width of ditches 7 ft. depth of ditches 18 in. max

French Drain Required: _____ Linear feet

Date: 4/14/2005

This permit is subject to revocation if site plans or intended use change.

Signed: [Signature]
Environmental Health Specialist

* Maintain all setbacks
* Run ditches on contour
* NO DEEPER than 18 in.

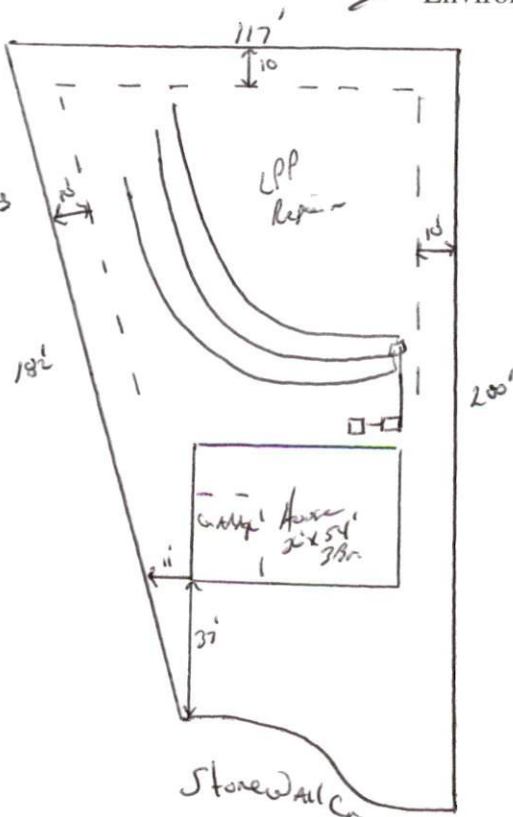

HARNETT COUNTY DEPARTMENT OF PUBLIC HEALTH
AUTHORIZATION TO CONSTRUCT

Authorization is hereby given to construct a wastewater system to the specifications described by Harnett County Department of Public Health, Improvement Permit # 21746. This authorization shall be valid for a period not to exceed five (5) years from the date of issuance. *This authorization will be invalid if ownership, site plans, or intended use change.*

Showcase Construction 864-0900
Name Telephone #

5506 Yacklin Rd. Fayetteville, N.C. 28703
Address

1124 Runkert
Property Location SR# Road Name

Worsterfield 28 3 39Ac
Subdivision Lot # # Bedrooms Proposed Lot Size

TYPE OF SYSTEM

New Installation Repair Septic Tank Nitrification Lines

Conventional Other Pump to 25% Reduction System

Basement With Plumbing Without Plumbing

Water Supply: Well Public Water Supply Minimum Well Setback: 50 Ft.

Septic Tank 1000 gal Pump Chamber 1000 gal

NITRIFICATION FIELD SPECIFICATIONS

Number of fields 1 # of lines per field 3 Length of lines 100 Ft.

Width of ditches 3 ft. Depth of ditches 18 inches max

French Drain: Linear feet required _____ Depth of gravel _____

No wastewater system shall be covered or placed into use by any person until an inspection by the Harnett County Health Department has determined that the system has been installed according to the conditions of the Improvement Permit and that a valid Operations Permit has been issued.

Bryan McSwain, Jr.
Signature of Authorized Agent for Harnett County

4/14/2008
Date