

IMPROVEMENT PERMIT

21734

HTE 05-5-11620

Be it ordained by the Harnett County Board of Health as follows: Section III, Item B. "No Person shall begin construction of any building at which a septic tank system is to be used for disposal of sewage without first obtaining a written permit from the Harnett County Health Department."

Name: (owner) Showcare Construction New Installation Septic Tank
 Property Location: SR# 1124 Ranbeast Rd. Repairs Nitrification Line

Subdivision Westerfield Farms Lot # 29

Tax ID # _____ Quadrant # _____

Number of Bedrooms Proposed: 3 Lot Size: .64 Ac

Basement with Plumbing: Garage:

Water Supply: Well Public Community

Distance From Well: 50 m ft.

Following is the minimum specifications for sewage disposal system on above captioned property. Subject to final approval.

Type of system: Conventional Other 25% Reduct. in System

Size of tank: Septic Tank: 1000 gallons Pump Tank: _____ gallons

Subsurface Drainage Field No. of ditches 3 exact length of each ditch 80 ft. width of ditches 3 ft. depth of ditches 18-24 in.

French Drain Required: _____ Linear feet

Date: 4/8/2005

This permit is subject to revocation if site plans or intended use change.

Signed: Bryan McSwain, D.S.
 Environmental Health Specialist

* Maintain all setbacks
 * Run d. field on contour

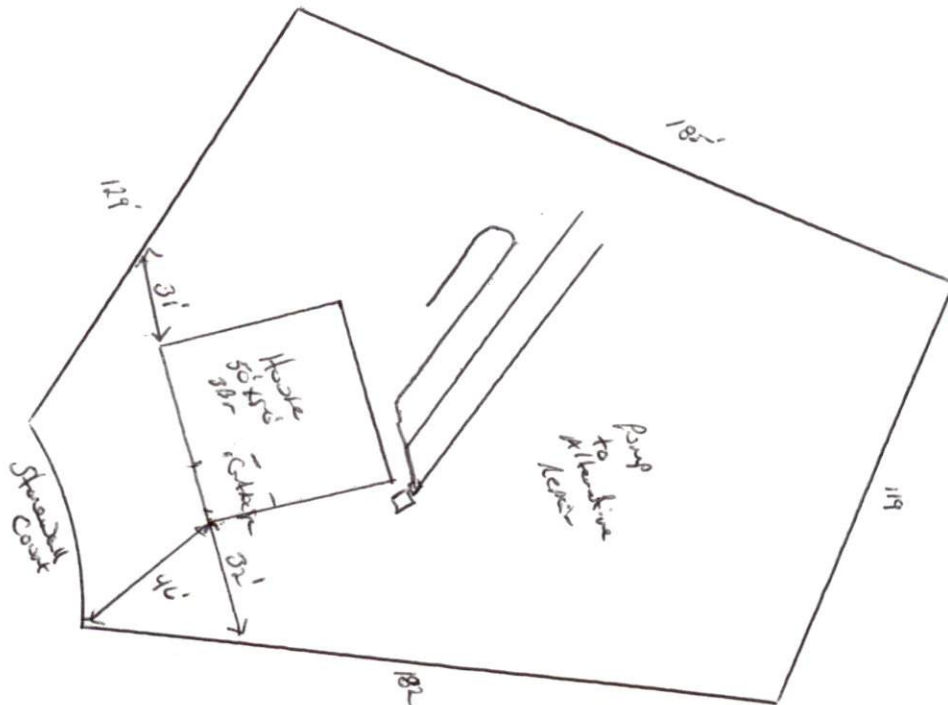

HARNETT COUNTY DEPARTMENT OF PUBLIC HEALTH
AUTHORIZATION TO CONSTRUCT

Authorization is hereby given to construct a wastewater system to the specifications described by Harnett County Department of Public Health, Improvement Permit # 21734. This authorization shall be valid for a period not to exceed five (5) years from the date of issuance. ***This authorization will be invalid if ownership, site plans, or intended use change.***

Showcase Construction Name 864-0900 Telephone #

5506 Yeakins Rd. Fayetteville, N.C. 28707 Address

1124 Property Location SR# Kenbeest. Road Name

Westerfield Farm Subdivision 29 Lot # 3 # Bedrooms Proposed .64Ac Lot Size

TYPE OF SYSTEM

- New Installation Repair Septic Tank Nitrification Lines
- Conventional Other 25% Reduct. System
- Basement With Plumbing Without Plumbing

Water Supply: Well Public Water Supply Minimum Well Setback: 50 Ft.

Septic Tank 1000 gal Pump Chamber _____ gal

NITRIFICATION FIELD SPECIFICATIONS

Number of fields 1 # of lines per field 3 Length of lines 80 Ft.

Width of ditches 3 ft. Depth of ditches 18-24 inches

French Drain: Linear feet required _____ Depth of gravel _____

No wastewater system shall be covered or placed into use by any person until an inspection by the Harnett County Health Department has determined that the system has been installed according to the conditions of the Improvement Permit and that a valid Operations Permit has been issued.

Bryan McSwain R.S.
Signature of Authorized Agent for Harnett County

4/8/05
Date