

HTE 05-5-11594

IMPROVEMENT PERMIT

21955

Be it ordained by the Harnett County Board of Health as follows: Section III, Item B. "No Person shall begin construction of any building at which a septic tank system is to be used for disposal of sewage without first obtaining a written permit from the Harnett County Health Department."

Name: (owner) James Ray New Installation Septic Tank
 Property Location: SR# 1291 off US421 Repairs Nitrification Line

Subdivision Maine Bell Ridge Lot # 22

Tax ID # _____ Quadrant # _____

Number of Bedrooms Proposed: 3 Lot Size: 58 Ac

Basement with Plumbing: Garage:

Water Supply: Well Public Community

Distance From Well: 50 ft.

Following is the minimum specifications for sewage disposal system on above captioned property. Subject to final approval.

Type of system: Conventional Other 25% Reduct. in System

Size of tank: Septic Tank: 1000 gallons Pump Tank: _____ gallons

Subsurface Drainage Field: No. of ditches 1 exact length of each ditch 300 ft. width of ditches 3 ft. depth of ditches 18 in. MAX

French Drain Required: _____ Linear feet

Date: 4/20/2005

This permit is subject to revocation if site plans or intended use change.

Signed: [Signature]
 Environmental Health Specialist

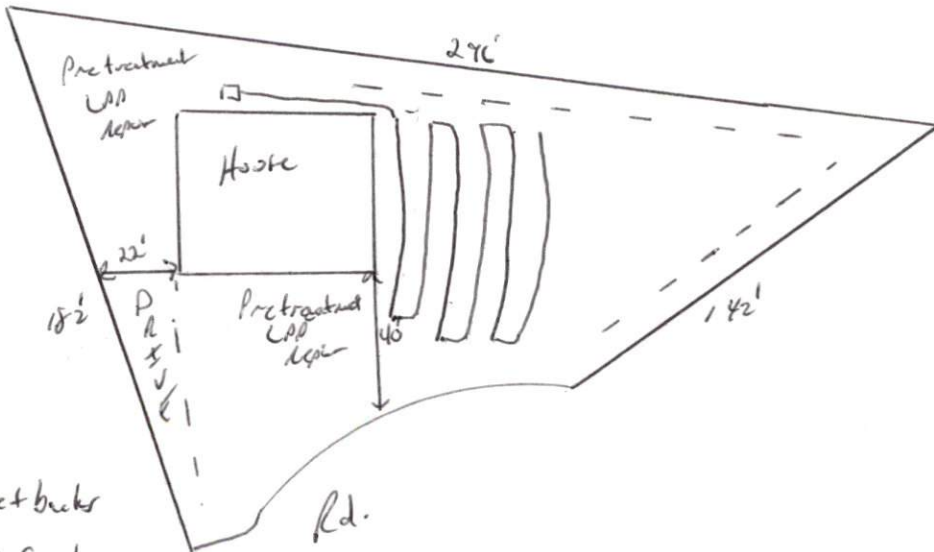

*Maintain at ret backs
 *don't ditch on contour
 *Ditches to be NO DEEPER
 than 18 inches

HARNETT COUNTY DEPARTMENT OF PUBLIC HEALTH
AUTHORIZATION TO CONSTRUCT

Authorization is hereby given to construct a wastewater system to the specifications described by Harnett County Department of Public Health, Improvement Permit # 2195J. This authorization shall be valid for a period not to exceed five (5) years from the date of issuance. *This authorization will be invalid if ownership, site plans, or intended use change.*

Name James Ray Telephone # 984-7371

Address 86 C. Stewart Rd. Lillington, N.C. 27546

Property Location SR# 1291 Road Name Old US 421

Subdivision Mane Bell Edge Lot # 22 # Bedrooms Proposed 3 Lot Size .57 Ac

TYPE OF SYSTEM

- New Installation Repair Septic Tank Nitrification Lines
- Conventional Other 25% Reduct: on System
- Basement With Plumbing Without Plumbing

Water Supply: Well Public Water Supply Minimum Well Setback: 50 Ft.

Septic Tank 1000 gal Pump Chamber _____ gal

NITRIFICATION FIELD SPECIFICATIONS

Number of fields 1 # of lines per field 1 Length of lines 300 Ft.

Width of ditches 3 ft. Depth of ditches 18 inches M4

French Drain: Linear feet required _____ Depth of gravel _____

No wastewater system shall be covered or placed into use by any person until an inspection by the Harnett County Health Department has determined that the system has been installed according to the conditions of the Improvement Permit and that a valid Operations Permit has been issued.

Signature of Authorized Agent for Harnett County [Signature] Date 4/20/2005