

HTE 05 500 11508

# IMPROVEMENT PERMIT

21753

Be it ordained by the Harnett County Board of Health as follows: Section III, Item B. "No Person shall begin construction of any building at which a septic tank system is to be used for disposal of sewage without first obtaining a written permit from the Harnett County Health Department."

Name: (owner) Woodshire - Caviness Land Dev.  New Installation  Septic Tank  
Property Location: SR# 1117  Repairs  Nitrification Line

Subdivision Woodshire Lot # 96

Tax ID # \_\_\_\_\_ Quadrant # \_\_\_\_\_

Number of Bedrooms Proposed: 3 Lot Size: .35 A

Basement with Plumbing:  Garage:

Water Supply:  Well  Public  Community

Distance From Well: 50 ft.

Following is the minimum specifications for sewage disposal system on above captioned property. Subject to final approval.

Type of system:  Conventional  Other 25% Reduction system must be installed

Size of tank: Septic Tank: 1000 gallons Pump Tank: \_\_\_\_\_ gallons

Subsurface No. of exact length width of depth of  
Drainage Field ditches 1 of each ditch 225 ft. ditches 3 ft. ditches 18-30 in.

French Drain Required: \_\_\_\_\_ Linear feet 25% Reduction

Date: 3-16-05

This permit is subject to revocation if site plans or intended use change.

Signed: Heath Cr  
Environmental Health Specialist

- \* Lot 96
- \* Repair can be installed around initial system
- \* 25% reduction necessary
- \*

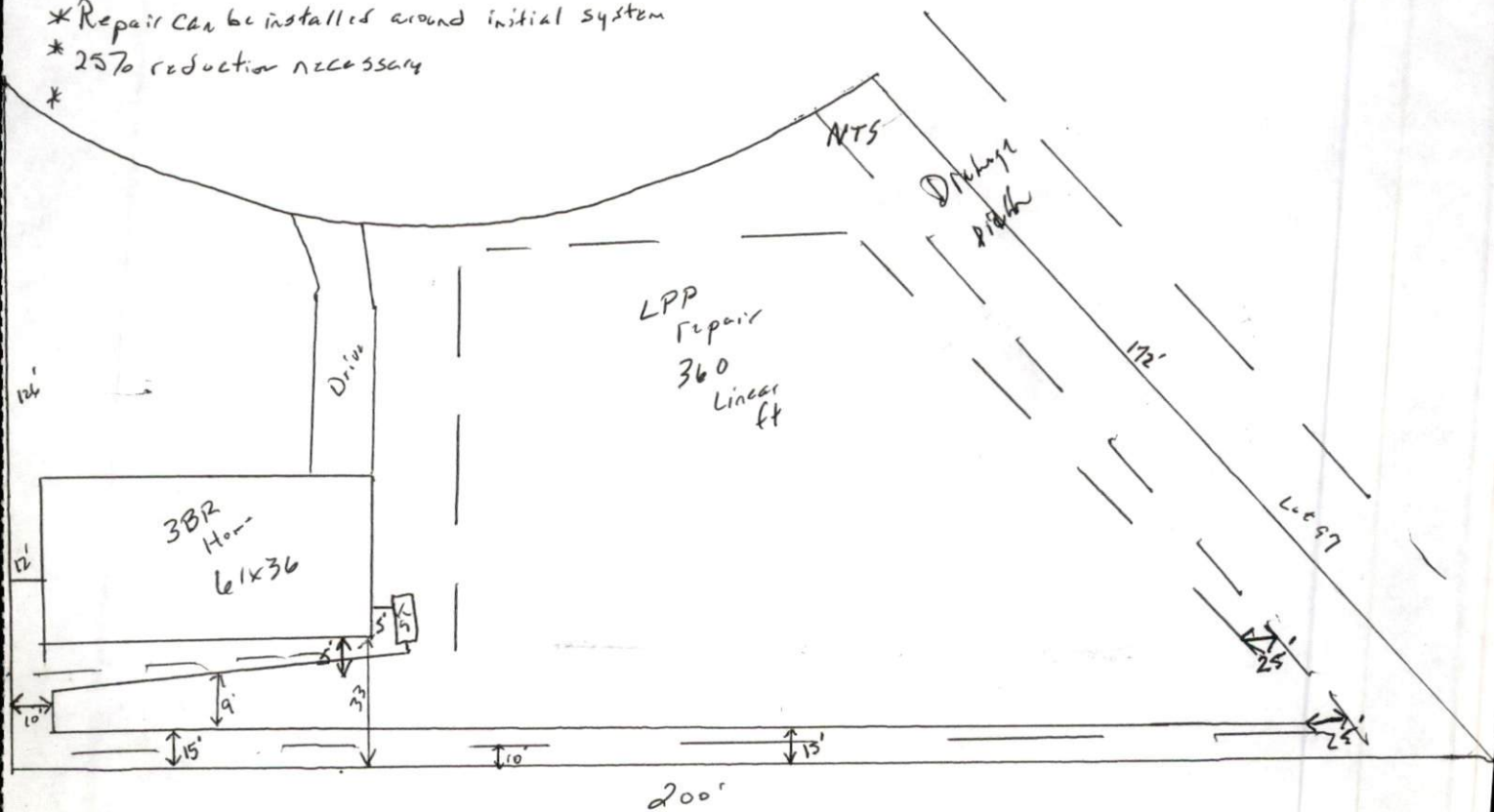

HARNETT COUNTY DEPARTMENT OF PUBLIC HEALTH  
AUTHORIZATION TO CONSTRUCT

Authorization is hereby given to construct a wastewater system to the specifications described by Harnett County Department of Public Health, Improvement Permit # 21755. This authorization shall be valid for a period not to exceed five (5) years from the date of issuance. *This authorization will be invalid if ownership, site plans, or intended use change.*

Name Woodshire - Courtois Telephone # 910 481-0503

Address 2818 Rucker Rd Fayetteville, NC

Property Location SR# 1117 Road Name Red Bud Circle

Subdivision Woodshire Lot # 96 # Bedrooms Proposed 3BR Lot Size .35A

**TYPE OF SYSTEM**

New Installation  Repair  Septic Tank  Nitrification Lines

Conventional  Other 25% reducti

Basement  With Plumbing  Without Plumbing

Water Supply:  Well  Public Water Supply Minimum Well Setback: \_\_\_\_\_ Ft.

Septic Tank 1000 gal Pump Chamber \_\_\_\_\_ gal

**NITRIFICATION FIELD SPECIFICATIONS**

Number of fields 1 # of lines per field 1 Length of lines 225 Ft.

Width of ditches 3 ft. Depth of ditches 18-30 inches

French Drain: Linear feet required \_\_\_\_\_ Depth of gravel \_\_\_\_\_

No wastewater system shall be covered or placed into use by any person until an inspection by the Harnett County Health Department has determined that the system has been installed according to the conditions of the Improvement Permit and that a valid Operations Permit has been issued.

Signature of Authorized Agent for Harnett County Heath C.

Date 3-16-05