

HTE 05-5-11452

# IMPROVEMENT PERMIT

21856

Be it ordained by the Harnett County Board of Health as follows: Section III, Item B. "No Person shall begin construction of any building at which a septic tank system is to be used for disposal of sewage without first obtaining a written permit from the Harnett County Health Department."

Name: (owner) Jerry Hamilton Builders  New Installation  Septic Tank  
Property Location: SR# 1435 Tress RD  Repairs  Nitrification Line

Subdivision Plantations at Verdant Green Lot # 41

Tax ID # \_\_\_\_\_ Quadrant # \_\_\_\_\_

Number of Bedrooms Proposed: 3 Lot Size: .45

Basement with Plumbing:  Garage:

Water Supply:  Well  Public  Community

Distance From Well: 50' ft.

Following is the minimum specifications for sewage disposal system on above captioned property. Subject to final approval.

Type of system:  Conventional  Other 25% Reduction System

Size of tank: Septic Tank: 1000 gallons Pump Tank: \_\_\_\_\_ gallons

Subsurface Drainage Field No. of ditches 1 exact length of each ditch 300 ft. width of ditches 3 ft. depth of ditches 20-18 in.

French Drain Required: - Linear feet

Date: 3-30-05

This permit is subject to revocation if site plans or intended use change.

Signed: Jamex Manhart  
Environmental Health Specialist

\* Contractor to MEET ON SITE.

Pump may be Required.

Layout may change once trees are cleared.

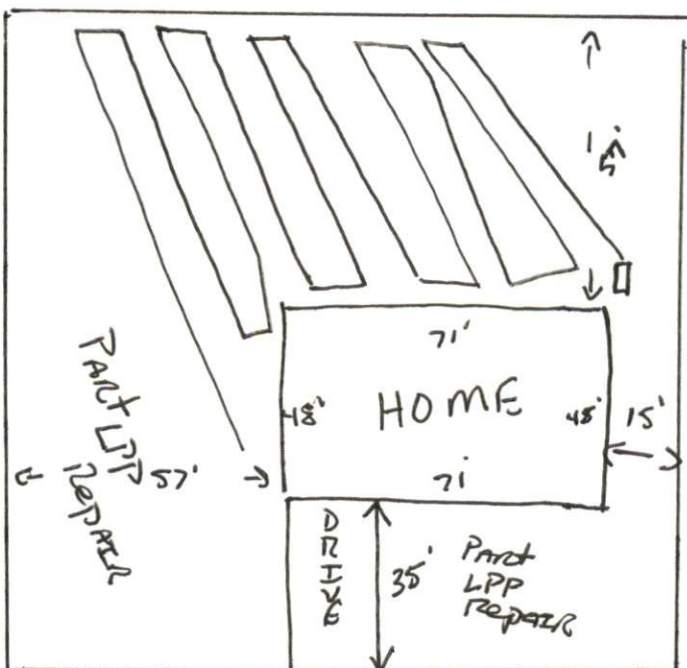

SUPREME DRIVE

HARNETT COUNTY HEALTH DEPARTMENT  
AUTHORIZATION TO CONSTRUCT

05-5-11452

Authorization is hereby given to construct a wastewater system to the specifications described by Harnett County Health Department, Improvement Permit # 21856. This authorization shall be valid for a period not to exceed five (5) years from the date of issuance. This authorization will be invalid if ownership, site plans, or intended use change.

Name Terry Hamilton Builders Telephone# 853-8427

Address 286 E Pine St Wellington N.C. 27546

Property Location SR# 1435 Road Name Tripp

Subdivision Plantation Viewyard Lot # 41 # Bedrooms Proposed 3 Lot Size .45

TYPE OF SYSTEM

New Installation  Repair  Septic Tank  Nitrification Lines

Conventional  Other 25% Reducer

Basement  With Plumbing  Without Plumbing

Water Supply:  Well  Public Water Supply Minimum Well Setback: \_\_\_\_\_ Ft.

Septic Tank 1000 gal Pump Chamber \_\_\_\_\_ gal

NITRIFICATION FIELD SPECIFICATIONS

Number of fields 2 # of lines per field 1 Length of lines 300 Ft.

Width of ditches 3 ft. Depth of ditches 28-18 inches

French Drain: Linear feet required \_\_\_\_\_ Depth of gravel \_\_\_\_\_

No wastewater system shall be covered or placed into use by any person until an inspection by the Harnett County Health Department has determined that the system has been installed according to the conditions of the Improvement Permit and that a valid Operations Permit has been issued.

[Signature]  
Signature of Authorized Agent for Harnett County of Harnett

3-31-05  
Date