

11279 - Home  
HTE 11280 SHOP

HARNETT COUNTY HEALTH DEPARTMENT

IMPROVEMENT PERMIT

21631

Be it ordained by the Harnett County Board of Health as follows: Section III, Item B. "No Person shall begin construction of any building at which a septic tank system is to be used for disposal of sewage without first obtaining a written permit from the Harnett County Health Department."

Name: (owner) Randy C JONES  New Installation  Septic Tank  
Property Location: SR# 1500 Benson Rd  Repairs  Nitrification Line

Subdivision \_\_\_\_\_ Lot # 1

Tax ID # \_\_\_\_\_ Quadrant # \_\_\_\_\_

Number of Bedrooms Proposed: 4 Lot Size: 10.04 acre

Basement with Plumbing:  Garage:

Water Supply:  Well  Public  Community

Distance From Well: 50' ft.

Following is the minimum specifications for sewage disposal system on above captioned property. Subject to final approval.

Type of system:  Conventional  Other \_\_\_\_\_

Size of tank: Septic Tank: 1200 gallons Pump Tank: \_\_\_\_\_ gallons

Subsurface Drainage Field No. of ditches 3 exact length of each ditch 133 ft. width of ditches 3 ft. depth of ditches 24" in.

French Drain Required: - Linear feet

Date: 2-24-05

This permit is subject to revocation if site plans or intended use change.

Signed: James E. Manhart Environmental Health Specialist

SR1500 BENSON RD

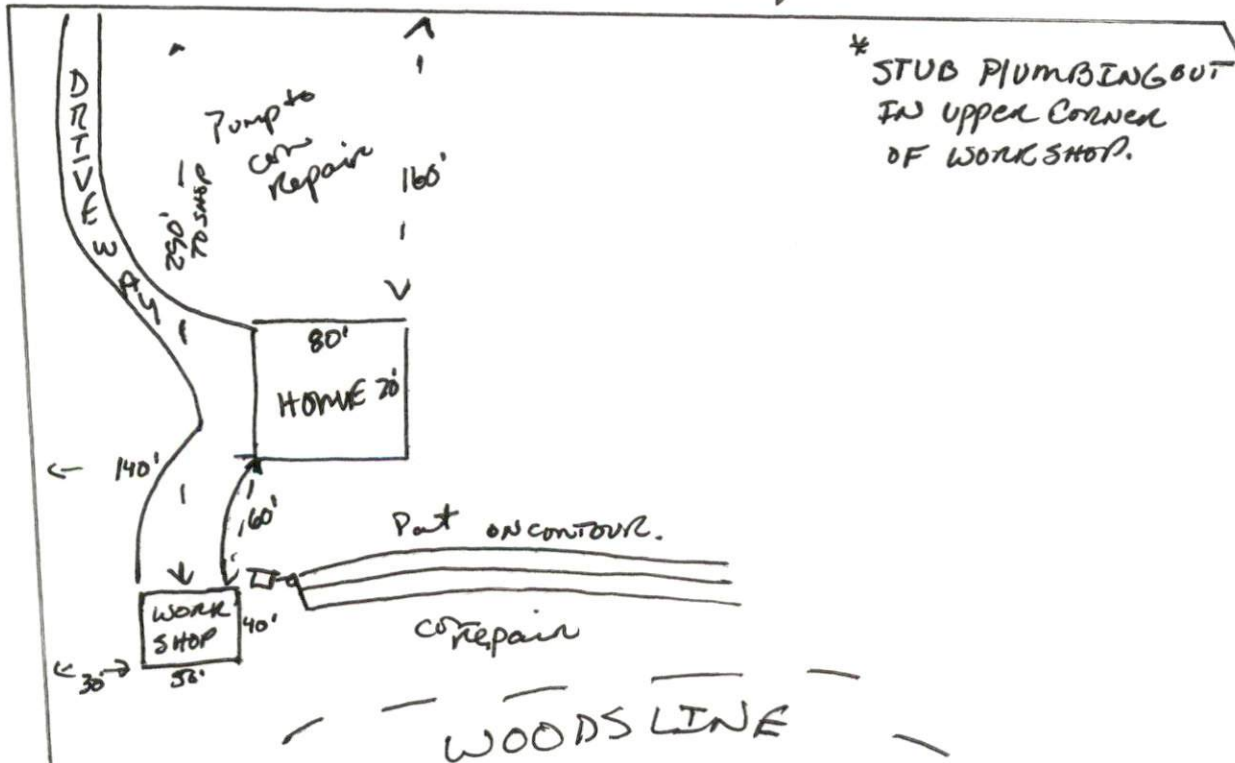

11279 Home  
11280-5A07

HARNETT COUNTY DEPARTMENT OF PUBLIC HEALTH  
AUTHORIZATION TO CONSTRUCT

Authorization is hereby given to construct a wastewater system to the specifications described by Harnett County Department of Public Health, Improvement Permit # 21651. This authorization shall be valid for a period not to exceed five (5) years from the date of issuance. *This authorization will be invalid if ownership, site plans, or intended use change.*

Name Randy C JONES Telephone # 410-265-0279

Address 1236 Tyler Ave Annapoles M.D. 21403

Property Location SR# 1500 Road Name Benson

Subdivision \_\_\_\_\_ Lot # \_\_\_\_\_ # Bedrooms Proposed 4 Lot Size 10.04

**TYPE OF SYSTEM**

New Installation    Repair    Septic Tank    Nitrification Lines

Conventional    Other \_\_\_\_\_

Basement    With Plumbing    Without Plumbing

Water Supply:  Well    Public Water Supply Minimum Well Setback: \_\_\_\_\_ Ft.

Septic Tank 1200 gal   Pump Chamber \_\_\_\_\_ gal

**NITRIFICATION FIELD SPECIFICATIONS**

Number of fields 2 # of lines per field 3 Length of lines 133 Ft.

Width of ditches 3 ft. Depth of ditches 24 inches

French Drain: Linear feet required \_\_\_\_\_ Depth of gravel \_\_\_\_\_

No wastewater system shall be covered or placed into use by any person until an inspection by the Harnett County Health Department has determined that the system has been installed according to the conditions of the Improvement Permit and that a valid Operations Permit has been issued.

James E. Manhart  
Signature of Authorized Agent for Harnett County

2-24-05  
Date