

HTE 04.5 10720

IMPROVEMENT PERMIT

21456

Be it ordained by the Harnett County Board of Health as follows: Section III, Item B. "No Person shall begin construction of any building at which a septic tank system is to be used for disposal of sewage without first obtaining a written permit from the Harnett County Health Department."

Name: (owner) Kent Pieper Inc
Property Location: SR# 1141
New Installation [checked]
Septic Tank [checked]
Repairs [unchecked]
Nitrification Line [checked]

Subdivision Highland Forest Lot # 84

Tax ID # _____ Quadrant # _____

Number of Bedrooms Proposed: 3 (36x50) Lot Size: 0.41

Basement with Plumbing: [unchecked] Garage: [checked]

Water Supply: [unchecked] Well [checked] Public [checked] Community [unchecked]

Distance From Well: 50 ft.

Following is the minimum specifications for sewage disposal system on above captioned property. Subject to final approval.

Type of system: [unchecked] Conventional [checked] Other 25% Reduction SYSTEM

Size of tank: Septic Tank: 1000 gallons Pump Tank: _____ gallons

Subsurface Drainage Field No. of ditches 1 exact length of each ditch 150 ft. width of ditches 3 ft. depth of ditches 18 3/4 in.

French Drain Required: _____ Linear feet of 25% Reduction SYSTEM

Date: 11-08-04

This permit is subject to revocation if site plans or intended use change.

Signed: [Signature] Environmental Health Specialist

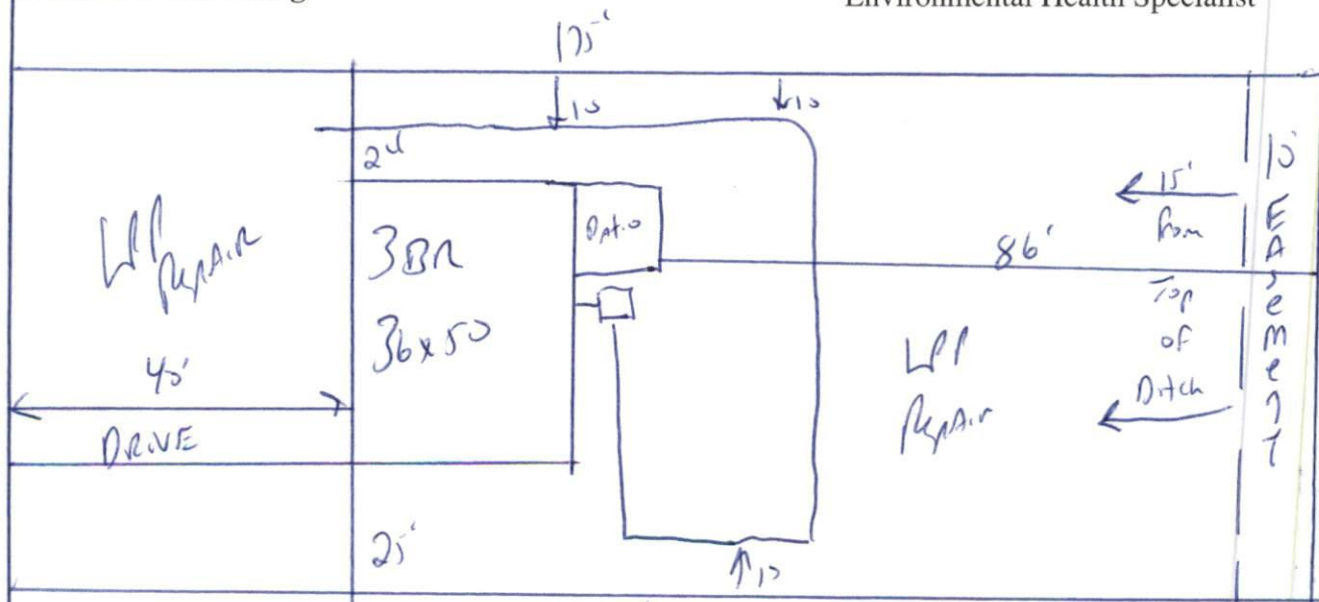

ESSEX CT EAST 105'

105'

MAINTAIN ALL SETBACKS

HARNETT COUNTY DEPARTMENT OF PUBLIC HEALTH
AUTORIZATION TO CONSTRUCT

Authorization is hereby given to construct a wastewater system to the specifications described by Harnett County Department of Public Health, Improvement Permit # 21456. This authorization shall be valid for a period not to exceed five (5) years from the date of issuance. *This authorization will be invalid if ownership, site plans, or intended use change.*

Name Kent Pierce Inc Telephone # _____

Address 1141

Property Location SR# _____ Road Name _____
Subdivision Highland Forest Lot # 84 # Bedrooms Proposed 3(36x50) Lot Size .41

TYPE OF SYSTEM

New Installation [] Repair Septic Tank Nitrification Lines
[] Conventional Other 25% Reduction System
[] Basement [] With Plumbing [] Without Plumbing

Water Supply: [] Well Public Water Supply Minimum Well Setback: 50 Ft.
Septic Tank 1000 gal Pump Chamber _____ gal

NITRIFICATION FIELD SPECIFICATIONS

Number of fields 1 # of lines per field 1 Length of lines 150 Ft.
Width of ditches 3 ft. Depth of ditches 18.30 inches 25% Reduction System
French Drain: Linear feet required _____ Depth of gravel _____

No wastewater system shall be covered or placed into use by any person until an inspection by the Harnett County Health Department has determined that the system has been installed according to the conditions of the Improvement Permit and that a valid Operations Permit has been issued.

Signature of Authorized Agent for Harnett County Joe West RS

Date 11-28-04