

HTE 04-5-10954

**IMPROVEMENT PERMIT**

**21267**

Be it ordained by the Harnett County Board of Health as follows: Section III, Item B. "No Person shall begin construction of any building at which a septic tank system is to be used for disposal of sewage without first obtaining a written permit from the Harnett County Health Department."

Name: (owner) Showcase Construction  New Installation  Septic Tank  
 Property Location: SR# 1124 Rambeaut Rd.  Repairs  Nitrification Line

Subdivision Westfield Farms Lot # 33

Tax ID # \_\_\_\_\_ Quadrant # \_\_\_\_\_

Number of Bedrooms Proposed: 3 Lot Size: .346 ac

Basement with Plumbing:  Garage:   
 Water Supply:  Well  Public  Community  
 Distance From Well: 50 ft.

**Following is the minimum specifications for sewage disposal system on above captioned property. Subject to final approval.**

Type of system:  Conventional  Other 25% Reduction System

Size of tank: Septic Tank: 1000 gallons Pump Tank: \_\_\_\_\_ gallons

Subsurface No. of exact length width of depth of  
 Drainage Field ditches 1 of each ditch 240 ft. ditches 3 ft. ditches 12-18 in.

French Drain Required: \_\_\_\_\_ Linear feet

Date: 10/15/2004

**This permit is subject to revocation if site plans or intended use change.**

Signed: Dwight McSwain R.S.  
 Environmental Health Specialist

- \* Maintain all setbacks
- \* Run ditch on contour
- \* 1st Run to be installed at 12 inches w/ 6 inches of cover brought in
- \* 2nd & 3rd Runs to be installed at 18 inches

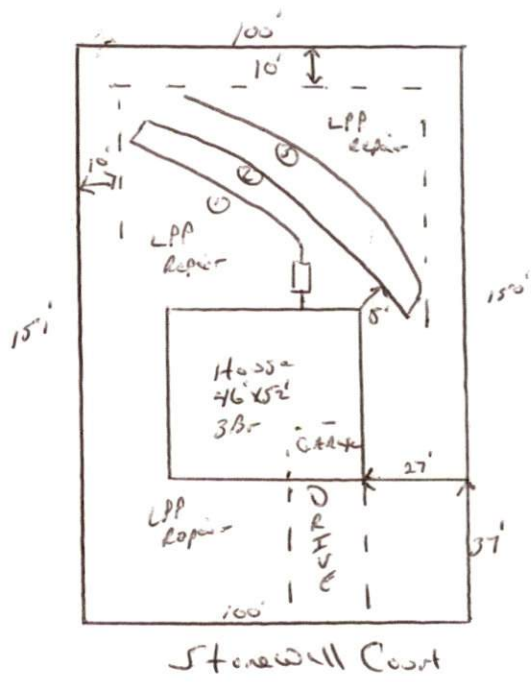

HARNETT COUNTY DEPARTMENT OF PUBLIC HEALTH  
AUTHORIZATION TO CONSTRUCT

Authorization is hereby given to construct a wastewater system to the specifications described by Harnett County Department of Public Health, Improvement Permit # 21267. This authorization shall be valid for a period not to exceed five (5) years from the date of issuance. *This authorization will be invalid if ownership, site plans, or intended use change.*

Name Showcase Construction Telephone # 864-0900

Address 5506 Yedkin Rd. Fayetteville, NC 28303

Property Location SR# 1124 Road Name Rambert

Subdivision Wester Field Farms Lot # 33 # Bedrooms Proposed 3 Lot Size .346 AC

**TYPE OF SYSTEM**

- New Installation     Repair     Septic Tank     Nitrification Lines
- Conventional     Other 25% Reduction System
- Basement     With Plumbing     Without Plumbing

Water Supply:  Well     Public Water Supply Minimum Well Setback: 50 Ft.

Septic Tank 1000 gal    Pump Chamber \_\_\_\_\_ gal

**NITRIFICATION FIELD SPECIFICATIONS**

Number of fields 1 # of lines per field 1 Length of lines 240 Ft.

Width of ditches 3 ft. Depth of ditches 12-18 inches

French Drain: Linear feet required \_\_\_\_\_ Depth of gravel \_\_\_\_\_  
*6 inches of cover*

No wastewater system shall be covered or placed into use by any person until an inspection by the Harnett County Health Department has determined that the system has been installed according to the conditions of the Improvement Permit and that a valid Operations Permit has been issued.

Bryan McLean R.S.  
Signature of Authorized Agent for Harnett County

10/15/2004  
Date