

Initial Application Date: 09/07/04

Applicati 4-5-10482

COUNTY OF HARNETT LAND USE APPLICATION

Central Permitting

102 E. Front Street, Lillington, NC 27546

Phone: (910) 893-4759

Fax: (910) 893-2793

LANDOWNER: Omega VIII Investments Mailing Address: PO Box 11104
City: Fayetteville State: NC Zip: 28303 Phone #: 910-864-0247

APPLICANT: Showcase Construction Mailing Address: 5506 Yarkin Road
City: Fayetteville State: NC Zip: 28303 Phone #: 910-864-0900

PROPERTY LOCATION: SR #: _____ SR Name: Bambeaut Road
Parcel: 01-0513-0004-02 PIN: 0513-79-5428,000
Zoning: BA-zom Subdivision: Westerfield Farms Lot #: 31 Lot Size: .35 ac
Flood Plain: X Panel: 37085c0165D Watershed: N/A Deed Book/Page: 01870/0468 Plat Book/Page: _____

DIRECTIONS TO THE PROPERTY FROM LILLINGTON: Take Hwy 210 towards Spring Lake.
Turn right onto Bambeaut Road. Subdivision on Left.

PROPOSED USE:

- Sg. Family Dwelling (Size 60 x 39) # of Bedrooms 3 # Baths 2 Basement (w/wo bath) _____ Garage 525 Deck _____
- Multi-Family Dwelling No. Units _____ No. Bedrooms/Unit _____
- Manufactured Home (Size _____ x _____) # of Bedrooms _____ Garage _____ Deck _____
- Comments: included in total size
- Number of persons per household _____
- Business Sq. Ft. Retail Space _____ Type _____
- Industry Sq. Ft. _____ Type _____
- Home Occupation (Size _____ x _____) # Rooms _____ Use _____
- Accessory Building (Size _____ x _____) Use _____
- Addition to Existing Building (Size _____ x _____) Use _____
- Other _____

Water Supply: (County) (Well (No. dwellings _____)) (Other _____)
Sewage Supply: (New Septic Tank) (Existing Septic Tank) (County Sewer) (Other _____)
Erosion & Sedimentation Control Plan Required? YES NO

Structures on this tract of land: Single family dwellings Manufactured homes _____ Other (specify) _____

Property owner of this tract of land own land that contains a manufactured home w/in five hundred feet (500') of tract listed above? YES NO

Required Property Line Setbacks:	Minimum	Actual	Minimum	Actual
Front	<u>35'</u>	<u>40'</u>	Rear	<u>25'</u>
Side	<u>10'</u>	<u>15'</u>	Corner	<u>20'</u>
Nearest Building	<u>10'</u>	<u>+</u>		

If permits are granted I agree to conform to all ordinances and the laws of the State of North Carolina regulating such work and the specifications or plans submitted. I hereby swear that the foregoing statements are accurate and correct to the best of my knowledge.

[Signature]
Signature of Owner or Owner's Agent

9/27/04
Date

This application expires 6 months from the date issued if no permits have been issued

A RECORDED SURVEY PLAT AND RECORDED DEED ARE REQUIRED WHEN APPLYING FOR A LAND USE PERMIT

313 9/27 S

1 = 30'

S 83°19'17" E
131.00'

BLDG. LINE

31 0.35 AC.

FARMS

N 06°20'57" E
150.13'

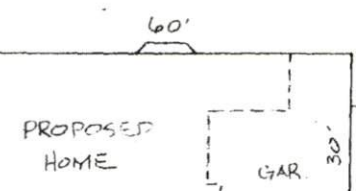

PROPOSED HOME

GAR.

WESTERFIELD FARMS

30

132.05'
S 3°02'38" W

DRIVE

ch = 53.64'
R = 50.00'

S 80°36'06" W

22.80'
N 83°39'03" W

STONEWALL COURT

50' R/W

SITE PLAN APPROVAL

DISTRICT RAZOMUSE S.F.D.

#BEDROOMS 3

A. Duggins 9/28/04
ZONING ADMINISTRATOR

40.5' x 22.2' x 6

-04

BASE CONSTRUCTION CO.

SUBDIVISION

WESTERFIELD FARMS

PRELIMINARY PLAT

PLAT BOOK _____ PAGE _____

DEED BOOK _____ PAGE _____

LOT 31

PN _____

SPRING TALK

HARNETT

CITY

STATE

Harnett County Planning Department

Central Permitting
PO Box 65, Lillington, NC 27546
910-893-4759
www.harnett.org

In order to provide the best customer service, Central Permitting staff compiled a list of procedures that helps to ensure successful permitting processes. Please follow steps necessary to expedite your plans.

Environmental Health New Septic Systems Test

- Place "property flags" in each corner of lot. All property lines must be clearly flagged approximately every 50 feet between corners.
- Place "house corner flags" at each corner of where the house/manufactured home will sit. Use additional flagging to outline driveways, garages, decks, out buildings, swimming pools, etc.
- Place flags at locations as developed on site plan by Customer Service Technician and you.
- Place Environmental Health "orange" card in location that is easily viewed from road.
- If property is thickly wooded, Environmental Health requires that you clean out the undergrowth to allow the soil evaluation to be performed. Inspectors should be able to walk freely around site. *No grading of property should be done.*
- After preparing proposed site telephone Environmental Health @ 893-7547 for questions on soil evaluation and confirmation number. Environmental Health will not begin soil evaluations until you call for confirmation number. Environmental Health is the source for all matters concerning testing and scheduling once application is completed at Central Permitting. Please be prepared to answer the following: applicant name, physical property location, last four digits of application number.

Environmental Health Existing Tank Inspections

- Place Environmental Health "orange" card in location that is easily viewed from road.
- Prepare for inspection by removing soil over door as diagram indicates. Loosen trap door cover.
- After preparing trapdoor call Environmental Health @ 893-7547 for confirmation number. Please be prepared to answer the following: applicant name, physical property location, last four digits of application number.

Fire Marshal Inspections

- Call Fire Marshal's office @ 893-7580 for all inspections.
- Prior to requesting final Building Inspection call Fire Marshal's office @ 893-7580 for inspection.
- Pick up Fire Marshal's letter and place on job site until work is completed.

Public Utilities

- Place stake with "orange" tape/name thirty feet (30) from the center of the road at the location you wish to have water tap installed.
- Allow four to six weeks after application for water/sewer taps. Call Utilities at 893-7575 for technical assistance.

Building Inspections

- Call Building Inspections @ 893-7527 to request any inspection.
- For new housing/set up permits ensure you meet E 911 / Addressing prior to calling for final inspection.

E911 Addressing

- Address numbers must be mounted on the house, 3 inches high (5" for commercial).
- Numbers must be a contrasting color from house, must be clearly visible night and day at entrance of driveway if home is 100 ft or more from road, or if mailbox is on opposite side of road.
- Call E911 Addressing @ 814-2038 for any questions.

Applicant Signature: _____

Date: _____

9/27/04