

HARNETT COUNTY HEALTH DEPARTMENT

HTE 04-5-10426RR

IMPROVEMENT PERMIT

21718

Be it ordained by the Harnett County Board of Health as follows: Section III, Item B. "No Person shall begin construction of any building at which a septic tank system is to be used for disposal of sewage without first obtaining a written permit from the Harnett County Health Department."

Name: (owner) R.L. Properties
Property Location: SR# 1526 Pope Lake Rd.
New Installation, Septic Tank, Repairs, Nitrification Line

Subdivision Pope's Lake Lot # 7

Tax ID # Quadrant #

Number of Bedrooms Proposed: 5 Lot Size: .99Ac

Basement with Plumbing: Garage:
Water Supply: Well, Public, Community

Distance From Well: 50m ft.

Following is the minimum specifications for sewage disposal system on above captioned property. Subject to final approval.

Type of system: Conventional, Other

Size of tank: Septic Tank: 1250 gallons Pump Tank: gallons

Subsurface Drainage Field No. of ditches 5 exact length of each ditch 100 ft. width of ditches 3 ft. depth of ditches 24 in.

French Drain Required: Linear feet

Date: 3/23/2005

This permit is subject to revocation if site plans or intended use change.

Signed: [Signature] Environmental Health Specialist

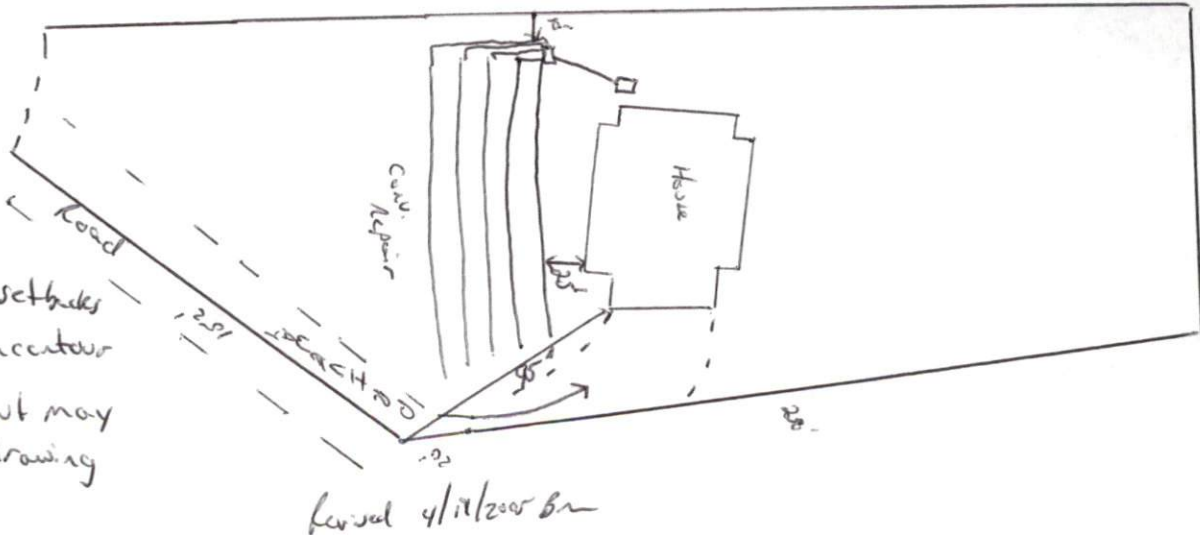

- * Maintain all setbacks
* Run ditches around
* System layout may differ from drawing

Revised 4/17/2005

HARNETT COUNTY DEPARTMENT OF PUBLIC HEALTH
AUTHORIZATION TO CONSTRUCT

Authorization is hereby given to construct a wastewater system to the specifications described by Harnett County Department of Public Health, Improvement Permit # 21718. This authorization shall be valid for a period not to exceed five (5) years from the date of issuance. *This authorization will be invalid if ownership, site plans, or intended use change.*

R.L. Properties Name 639-4295 Telephone #

221 Pope Lake Rd. Angier, N.C. 27501 Address

1566 Property Location SR# Pope Lake Road Name

Pope's Lake Subdivision 7 Lot # 5 # Bedrooms Proposed .99 Ac Lot Size

TYPE OF SYSTEM

New Installation Repair Septic Tank Nitrification Lines

Conventional Other _____

Basement With Plumbing Without Plumbing

Water Supply: Well Public Water Supply Minimum Well Setback: 50 Ft.

Septic Tank 1250 gal Pump Chamber _____ gal

NITRIFICATION FIELD SPECIFICATIONS

Number of fields 1 # of lines per field 5 Length of lines 100 Ft.

Width of ditches 3 ft. Depth of ditches 24 inches

French Drain: Linear feet required _____ Depth of gravel _____

No wastewater system shall be covered or placed into use by any person until an inspection by the Harnett County Health Department has determined that the system has been installed according to the conditions of the Improvement Permit and that a valid Operations Permit has been issued.

Bruce McInnis
Signature of Authorized Agent for Harnett County

3/23/2005
Date
4-19-05