

HTE # 04-50010270

NETT COUNTY HEALTH DEPARTMENT
ENVIRONMENTAL HEALTH SECTION

17740

OPERATIONS PERMIT

Name: (owner) JASON PRICE CONSTRUCTION New Installation Septic Tank Repair

Property Location: SR# 421 Nitrification Line Expansion

Subdivision MYRTLEWOOD Lot # 5+6 Tax ID # _____ Quadrant # _____

Contractor: GERALD TEMPLE Registration # _____

Basement with Plumbing: Garage:

Water Supply: Well Public Community

Distance From Well: 50 ft.

Following are the specifications for the sewage disposal system on above captioned property.

Type of system: Conventional Other PRESSURE MANIFOLD TO POLYSTYRENE AGG. TRENCH

Size of tank: Septic Tank: 1250 gallons Pump Tank: 1230 gallons

Subsurface Drainage Field No. of ditches 6 exact length of each ditch VARIES ft. width of ditches 3 ft. depth of ditches 12-18 in.

French Drain Required: _____ Linear feet

Date: 8/12/05

PERMIT NO. 21418

Inspected by: [Signature]

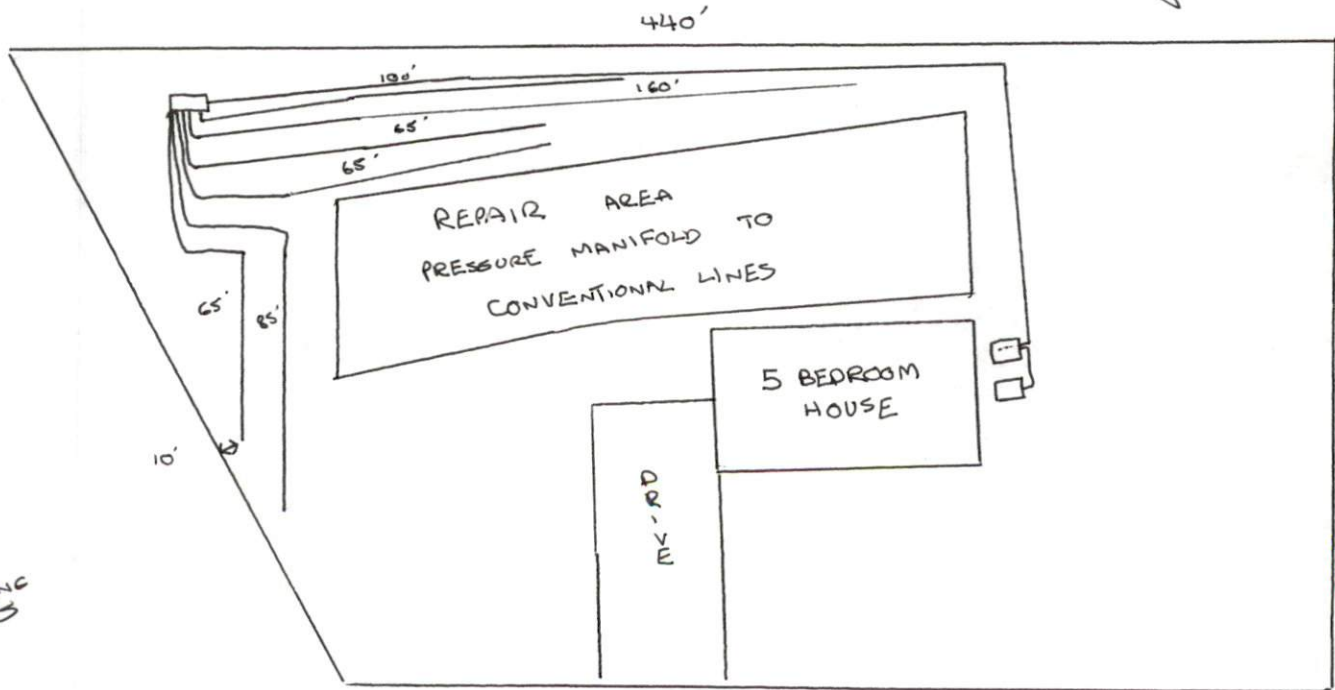

DRAWING
YES