

Replace permit #2320

Improvement Permit

A building permit cannot be issued with only an Improvement Permit

ISSUED TO: BARRY & Cindy PattersonPROPERTY LOCATION: LAWRENCE ROAD
SUBDIVISION BARRY PATTERSONNEW ☒ REPAIR ☐ EXPANSION ☐Site Improvements required prior to Construction Authorization
When permit was issued in 6Type of Structure: SFD-60x40-3BRProposed Wastewater System Type: ConventionalProjected Daily Flow: 360 GPDWater was not available. CdrNumber of bedrooms: 3 max Number of Occupants: 6 maxis now available.Basement ☐ Yes ☒ NoPump Required: ☐ Yes ☐ No ☒ May be required based on final location and elevations of facilitiesType of Water Supply: ☐ Community ☐ Public ☒ Well Distance from well 100' feet

Permit valid for:

Permit conditions: MUST meet on site for Final Layout - If well is used MUST obtain well permit from this dept. #2320 at Plumbing challenge at go or higher where shown maintain all set backAuthorized State Agent: J. W. WilesDate: 08-14-09

SEE ATTACHE

The issuance of this permit by the Health Department in no way guarantees the issuance of other permits. The permit holder is responsible for checking with appropriate governing bodies in meet site is subject to revocation if the site plan, plat, or the intended use changes. The Improvement Permit shall not be affected by a change in ownership of the site. This permit is subject to comp the Laws and Rules for Sewage Treatment and Disposal and to conditions of this permit.

Construction Authorization

(Required for Building Permit)

The construction and installation requirements of Rules .1950, .1952, .1954, .1955, .1956, .1957, .1958, and .1959 are incorporated by references into this permit and shall be met. Systems shall with the attached system layout.

ISSUED TO: BARRY & Cindy PattersonPROPERTY LOCATION: LAWRENCE RD
SUBDIVISION BARRY PATTERSONFacility Type: SFD-60x40-3BR ☒ New☐ Expansion ☐ RepairBasement? ☐ Yes ☒ No Basement Fixtures? ☐ Yes ☒ NoType of Wastewater System** Conventional(Initial) Wastewater Flow: 3(See note below, if applicable ☒ LPP

(Repair)

Installation Requirements/ConditionsSeptic Tank Size 1000 gallonsNumber of trenches 4

Pump Tank Size _____ gallons

Exact length of each trench 100 feetTrench Spacing: 9 feet

Trenches shall be installed on contour at a

Soil Cover: 6 inchesMaximum Trench Depth of: 18 inches

(Maximum soil cover shall not

(Trench bottoms shall be level to $\pm 1/4"$

36" above the trench bottom)

in all directions)

Pump Requirements: _____ ft. TDH vs. _____ GPM

Aggregate Depth: 6Conditions: MAY install AS 1 Line 400 long at 18"2Keep Septic System 60' from well12

**If applicable: I understand the system type specified is different from the type specified on the application. I accept the specifications of this,

Owner/Legal Representative Signature: _____

Date: _____

This Construction Authorization is subject to revocation if the site plan, plat, or the intended use changes. The Construction Authorization shall not be transferred when there is a change in owners

Construction Authorization is subject to compliance with the provisions of the Laws and Rules for Sewage Treatment and Disposal and to the conditions of this permit.

SEE ATTA

Authorized State Agent: J. W. WilesDate: 08-14-09Construction Authorization Expiration Date: 08-14-2013

HTE# 04-5-10227RR

Permit # 25510

Harnett County Department of Public Health Site Sketch

ISSUED TO: BARRY J. Cindy Patterson PROPERTY LOCATION: LAWRENCE RD
SUBDIVISION: BARRY PATTERSON LO
Authorized State Agent: J. L. LARS Date: 08-14-09

Authorized State Agent:

Date: 08-14-09

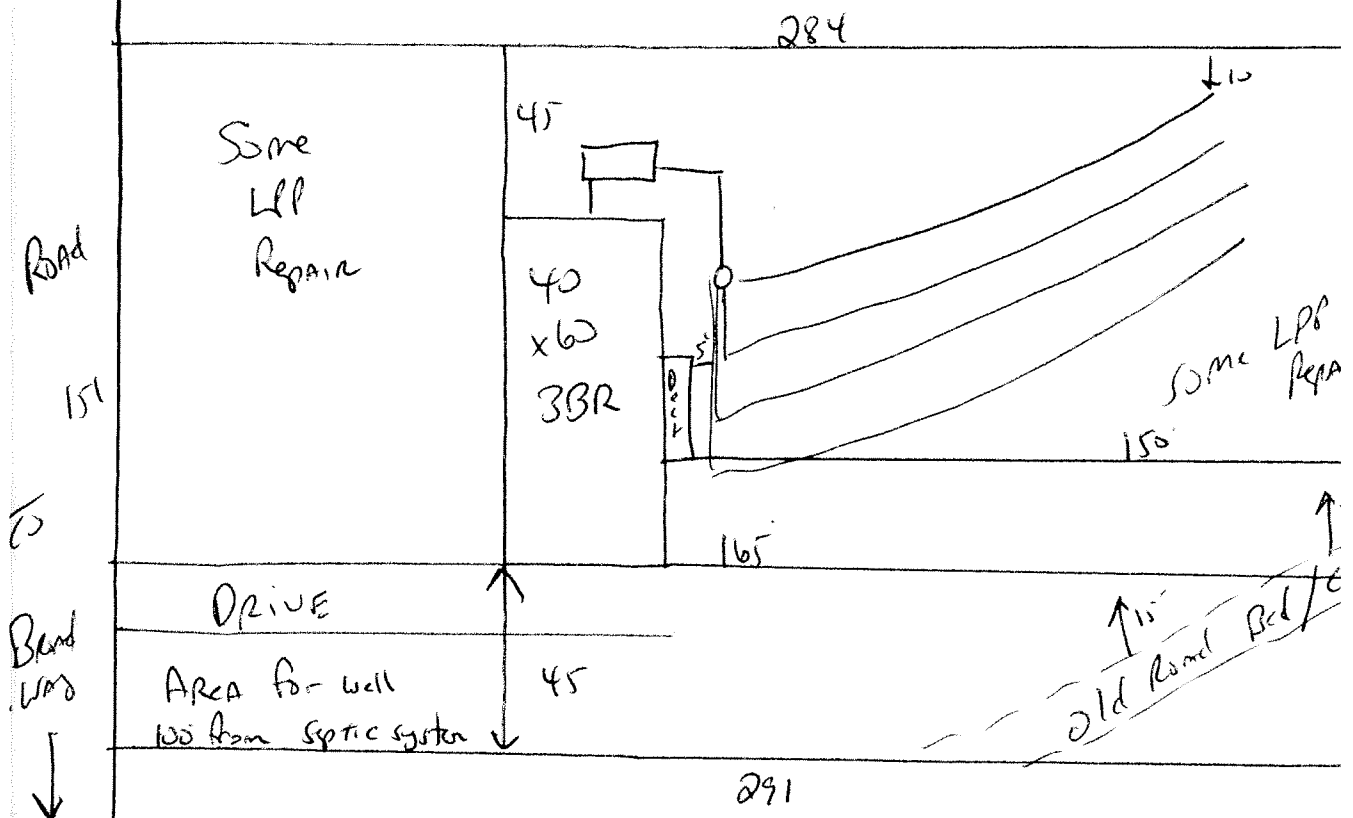

Meet onsite for Final Layout

maintain All set JALs

STUB out Plumbing shallow AT ground level or high
Where shown.

Install 4^{3P} 100 At 18" or 1 Line of 400 At 18"

Keep well & syptic system 100' apart.