

STORAGE - 10209

HARNETT COUNTY HEALTH DEPARTMENT

20978

HTE 04-5-10208

IMPROVEMENT PERMIT

Be it ordained by the Harnett County Board of Health as follows: Section III, Item B. "No Person shall begin construction of any building at which a septic tank system is to be used for disposal of sewage without first obtaining a written permit from the Harnett County Health Department."

Name: (owner) Whitton Builders New Installation Septic Tank
Property Location: SR# 1705 OLD CARRIAGE ROAD Repairs Nitrification Line

Subdivision Deigh Laurel Lot # 6

Tax ID # _____ Quadrant # _____

Number of Bedrooms Proposed: 4 Lot Size: 1.62 acres

Basement with Plumbing: Garage:

Water Supply: Well Public Community

Distance From Well: 50' ft.

Following is the minimum specifications for sewage disposal system on above captioned property. Subject to final approval.

Type of system: Conventional Other _____

Size of tank: Septic Tank: 1200 gallons Pump Tank: _____ gallons

Subsurface Drainage Field No. of ditches 4 exact length of each ditch 100 ft. width of ditches 3 ft. depth of ditches 22 in.

French Drain Required: _____ Linear feet

Date: 9-7-04

This permit is subject to revocation if site plans or intended use change.

Signed: James E. Mankin
Environmental Health Specialist

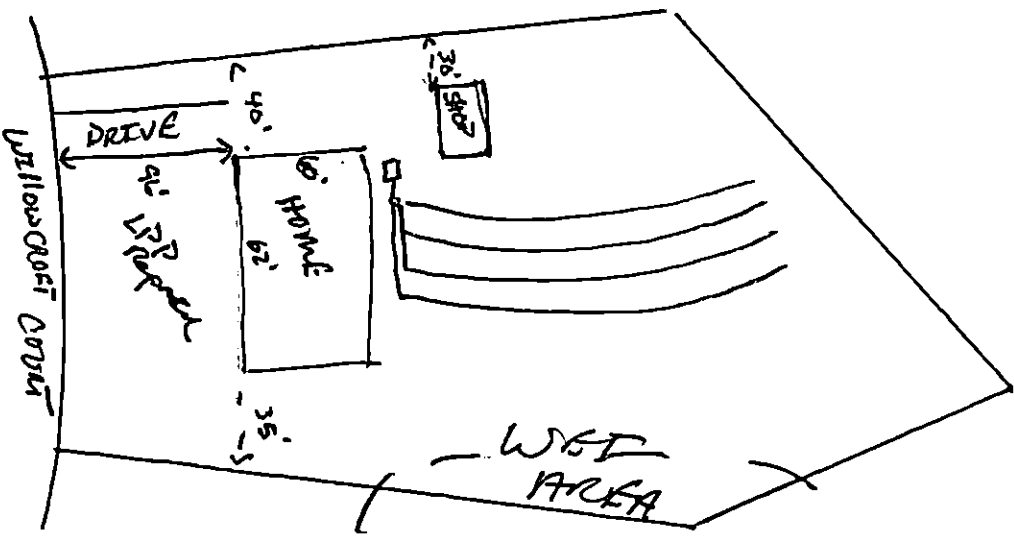

04-5-10208
5408 10209

HARNETT COUNTY DEPARTMENT OF PUBLIC HEALTH
AUTORIZATION TO CONSTRUCT

Authorization is hereby given to construct a wastewater system to the specifications described by Harnett County Department of Public Health, Improvement Permit # 20978. This authorization shall be valid for a period not to exceed five (5) years from the date of issuance. *This authorization will be invalid if ownership, site plans, or intended use change.*

Whittenton Builders 919-427 8468
Name Telephone #

1055 Tighman RD DUNN N.C. 28334
Address

1705 010 FALGOWND
Property Location SR# Road Name

Leigh Laurel 6 4 1.62 ac
Subdivision Lot # # Bedrooms Proposed Lot Size

TYPE OF SYSTEM

New Installation Repair Septic Tank Nitrification Lines

Conventional Other _____

Basement With Plumbing Without Plumbing

Water Supply: Well Public Water Supply Minimum Well Setback: _____ Ft.

Septic Tank 1200 gal Pump Chamber _____ gal

NITRIFICATION FIELD SPECIFICATIONS

Number of fields 2 # of lines per field 4 Length of lines 100 Ft.

Width of ditches 3 ft. Depth of ditches 22 inches

French Drain: Linear feet required _____ Depth of gravel _____

No wastewater system shall be covered or placed into use by any person until an inspection by the Harnett County Health Department has determined that the system has been installed according to the conditions of the Improvement Permit and that a valid Operations Permit has been issued.

James E. Markant
Signature of Authorized Agent for Harnett County

9-7-04
Date