

HTE 04-5-9934

IMPROVEMENT PERMIT

Be it ordained by the Harnett County Board of Health as follows: Section III, Item B. "No Person shall begin construction of any building at which a septic tank system is to be used for disposal of sewage without first obtaining a written permit from the Harnett County Health Department."

Name: (owner) Michael Anderson Homes INC
Property Location: SR# 1443 Lafayette RD
New Installation, Septic Tank, Repairs, Nitrification Line

Subdivision Victoria Hills Ph 7 Lot # 67
Tax ID # Quadrant #

Number of Bedrooms Proposed: 3 Lot Size: 34,077 sq ft

Basement with Plumbing: Garage:

Water Supply: Well, Public, Community

Distance From Well: 50' ft.

Following is the minimum specifications for sewage disposal system on above captioned property. Subject to final approval.

Type of system: Conventional, Other

Size of tank: Septic Tank: 1000 gallons Pump Tank: gallons

Subsurface Drainage Field: No. of ditches 4, exact length of each ditch 80 ft., width of ditches 3 ft., depth of ditches 18 in.

French Drain Required: Linear feet

Date: 7-30-04

This permit is subject to revocation if site plans or intended use change.

Signed: James E. Markham, Environmental Health Specialist

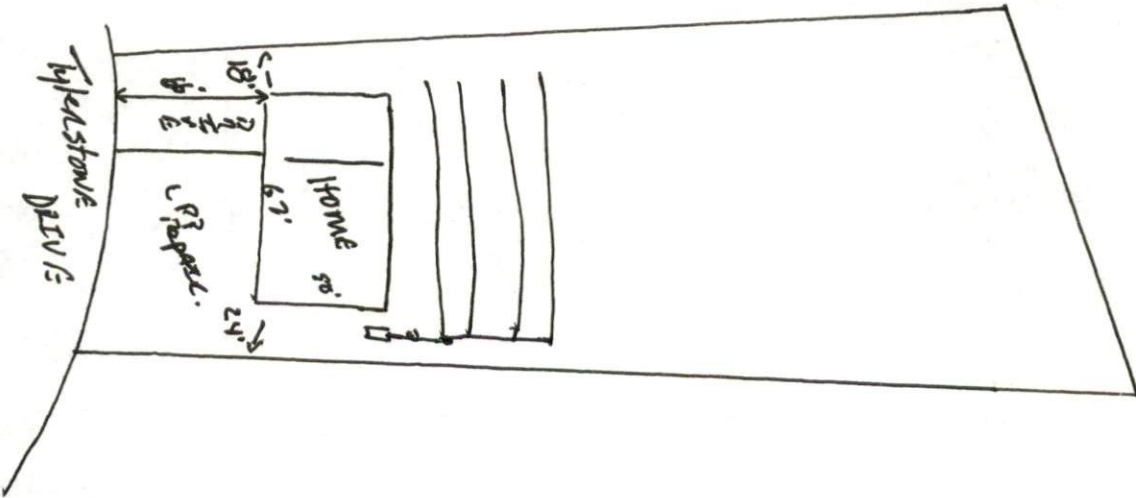

04-5-9834

HARNETT COUNTY DEPARTMENT OF PUBLIC HEALTH
AUTORIZATION TO CONSTRUCT

Authorization is hereby given to construct a wastewater system to the specifications described by Harnett County Department of Public Health, Improvement Permit # 20958. This authorization shall be valid for a period not to exceed five (5) years from the date of issuance. *This authorization will be invalid if ownership, site plans, or intended use change.*

Michael Anderson Homes Inc 919-552-1790
Name Telephone #

180 Woodland Ridge DRIVE F.V. N.C.
Address

1443 Lafayette
Property Location SR# Road Name

V.H. P47 67 3 39,077 sq ft
Subdivision Lot # # Bedrooms Proposed Lot Size

TYPE OF SYSTEM

New Installation Repair Septic Tank Nitrification Lines

Conventional Other _____

Basement With Plumbing Without Plumbing

Water Supply: Well Public Water Supply Minimum Well Setback: _____ Ft.

Septic Tank 1000 gal Pump Chamber _____ gal

NITRIFICATION FIELD SPECIFICATIONS

Number of fields 2 # of lines per field 4 Length of lines 80 Ft.

Width of ditches 3 ft. Depth of ditches 18 inches

French Drain: Linear feet required _____ Depth of gravel _____

No wastewater system shall be covered or placed into use by any person until an inspection by the Harnett County Health Department has determined that the system has been installed according to the conditions of the Improvement Permit and that a valid Operations Permit has been issued.

James E. Mahant 7-30-04
Signature of Authorized Agent for Harnett County Date