

HTE 04-5-9929

IMPROVEMENT PERMIT

Be it ordained by the Harnett County Board of Health as follows: Section III, Item B. "No Person shall begin construction of any building at which a septic tank system is to be used for disposal of sewage without first obtaining a written permit from the Harnett County Health Department."

Name: (owner) Bernard Youngs

New Installation

Septic Tank

Property Location: SR# 1551 Johnston County Rd

Repairs

Nitrification Line

Subdivision BF Estates

Lot # 96

Tax ID # _____ Quadrant # _____

Number of Bedrooms Proposed: 3

Lot Size: .69

Basement with Plumbing:

Garage:

Water Supply: Well Public

Community

Distance From Well: _____ ft.

Following is the minimum specifications for sewage disposal system on above captioned property. Subject to final approval.

Type of system: Conventional Other _____

Size of tank: Septic Tank: 1000 gallons Pump Tank: _____ gallons

Subsurface Drainage Field No. of ditches 3 exact length of each ditch 70 ft. width of ditches 3 ft. depth of ditches 22-18 in.

French Drain Required: _____ Linear feet

Date: 7-28-04

This permit is subject to revocation if site plans or intended use change.

Signed: James E. Markant
Environmental Health Specialist

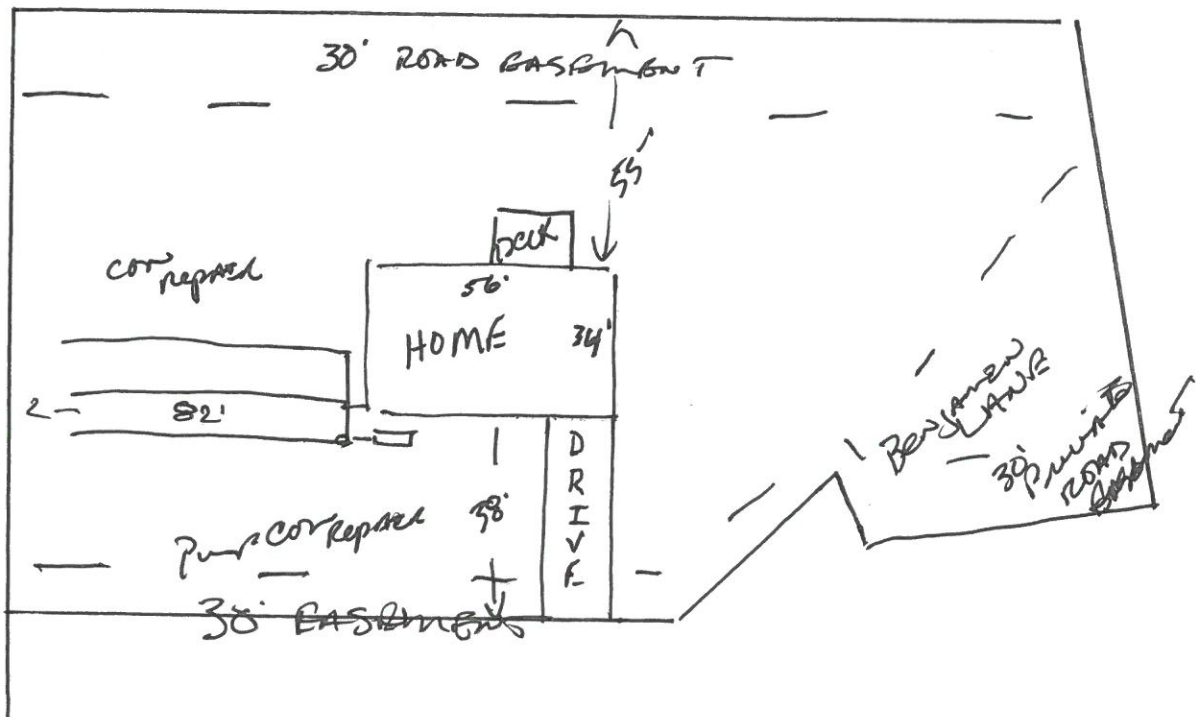

04-5-9929

HARNETT COUNTY DEPARTMENT OF PUBLIC HEALTH AUTHORIZATION TO CONSTRUCT

Authorization is hereby given to construct a wastewater system to the specifications described by Harnett County Department of Public Health, Improvement Permit # 20955. This authorization shall be valid for a period not to exceed five (5) years from the date of issuance. *This authorization will be invalid if ownership, site plans, or intended use change.*

Bernard Young Name 919-638-2934 Telephone #

3485 Johnston County RD Anglen N.C. 27501 Address

1551 Property Location SR# Johnston County Lane RD Road Name

B.F. Estates Subdivision 96 Lot # 3 # Bedrooms Proposed .65 Lot Size

TYPE OF SYSTEM

New Installation Repair Septic Tank Nitrification Lines

Conventional Other _____

Basement With Plumbing Without Plumbing

Water Supply: Well Public Water Supply Minimum Well Setback: _____ Ft.

Septic Tank 1000 gal Pump Chamber _____ gal

NITRIFICATION FIELD SPECIFICATIONS

Number of fields 2 # of lines per field 3 Length of lines 70 Ft.

Width of ditches 3 ft. Depth of ditches 22-18 inches

French Drain: Linear feet required _____ Depth of gravel _____

No wastewater system shall be covered or placed into use by any person until an inspection by the Harnett County Health Department has determined that the system has been installed according to the conditions of the Improvement Permit and that a valid Operations Permit has been issued.

James C. Markant Signature of Authorized Agent for Harnett County 7-27-04 Date