

HTE 04-5-9903R

IMPROVEMENT PERMIT

Be it ordained by the Harnett County Board of Health as follows: Section III, Item B. "No Person shall begin construction of any building at which a septic tank system is to be used for disposal of sewage without first obtaining a written permit from the Harnett County Health Department."

Name: (owner) BILLINGS CONSTRUCTION INC
Property Location: SR# 1443 LAFAYETTE RD
New Installation, Septic Tank, Repairs, Nitrification Line

Subdivision VICTORIA HILLS Lot # 184

Tax ID # Quadrant #

Number of Bedrooms Proposed: 3 Lot Size: .80ac

Basement with Plumbing: Garage:
Water Supply: Well, Public, Community

Distance From Well: 100 ft.

Following is the minimum specifications for sewage disposal system on above captioned property. Subject to final approval.

Type of system: Conventional, Other PUMP TO CONVENTIONAL
Size of tank: Septic Tank: 1000 gallons Pump Tank: 1000 gallons

Subsurface No. of exact length width of depth of
Drainage Field ditches 3 of each ditch 133 ft. ditches 3 ft. ditches 18 in.

French Drain Required: Linear feet

Date: 7/26/04
Signed: OLIVER TOLKSOOF Environmental Health Specialist

This permit is subject to revocation if site plans or intended use change.

- * MAINTAIN ALL SETBACKS
* IF PROPER FALL CAN BE MAINTAINED PUMP TANK MAY BE OMITTED
* CALL WITH ANY QUESTIONS PRIOR TO INSTALLATION

REVISED 8/10/04 OT

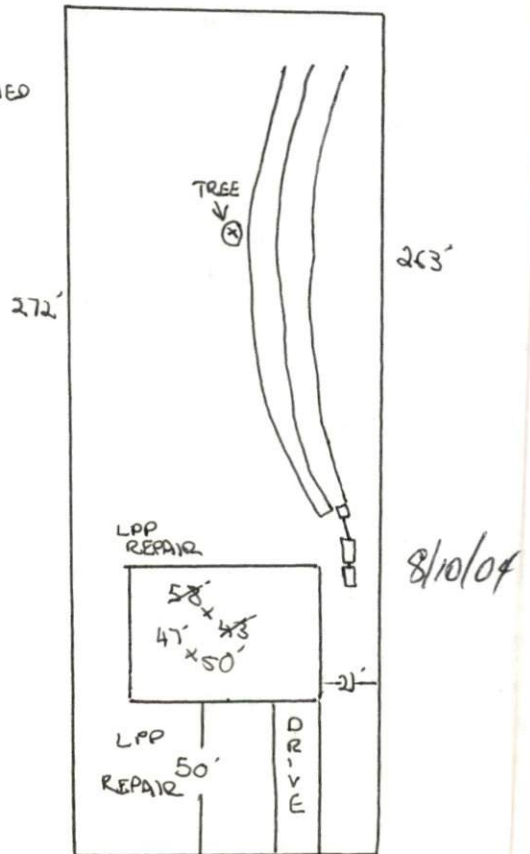

HARNETT COUNTY DEPARTMENT OF PUBLIC HEALTH
AUTHORIZATION TO CONSTRUCT

Authorization is hereby given to construct a wastewater system to the specifications described by Harnett County Department of Public Health, Improvement Permit # 20942. This authorization shall be valid for a period not to exceed five (5) years from the date of issuance. *This authorization will be invalid if ownership, site plans, or intended use change.*

BILLINGS CONST. CO. 919-795-9464
Name Telephone #

10012 CREW CHAPEL HILL, NC 27517
Address

1443 LAFAYETTE RD
Property Location SR# Road Name

VICTORIA HILLS 184 3 .80ac
Subdivision Lot # # Bedrooms Proposed Lot Size

TYPE OF SYSTEM

- New Installation [] Repair Septic Tank Nitrification Lines
[] Conventional Other PUMP TO CONVENTIONAL
[] Basement [] With Plumbing [] Without Plumbing

Water Supply: [] Well Public Water Supply Minimum Well Setback: 100 Ft.

Septic Tank 1000 gal Pump Chamber 1000 gal

NITRIFICATION FIELD SPECIFICATIONS

Number of fields 1 # of lines per field 3 Length of lines 133 Ft.

Width of ditches 3 ft. Depth of ditches 12 inches

French Drain: Linear feet required _____ Depth of gravel _____

No wastewater system shall be covered or placed into use by any person until an inspection by the Harnett County Health Department has determined that the system has been installed according to the conditions of the Improvement Permit and that a valid Operations Permit has been issued.

[Signature]
Signature of Authorized Agent for Harnett County

7/26/04 8/10/04
Date