

8 Camden Court East

Initial Application Date: 6/30/04

Application # 9833

COUNTY OF HARNETT LAND USE APPLICATION

Central Permitting

102 E. Front Street, Lillington, NC 27546

Phone: (910) 893-4759

Fax: (910) 893-2

LANDOWNER: Wm. Kent Puccio For Mailing Address: P.O. Box 42535  
City: Fayetteville State: NC Zip: 28309 Phone #: 910-424-1294

APPLICANT: SAUB Mailing Address: \_\_\_\_\_  
City: \_\_\_\_\_ State: \_\_\_\_\_ Zip: \_\_\_\_\_ Phone #: \_\_\_\_\_

PROPERTY LOCATION: SR #: 1141 SR Name: Alpine Rd.  
Parcel: 03958711 0020 69 PIN: 9596-09-5084.000  
Zoning: RA-11A Subdivision: Highland Forest Lot #: 128 Lot Size: 35  
Flood Plain: X Panel: 0075D Watershed: X Deed Book/Page: 01867/0019 Plat Book/Page: 2003-1165

DIRECTIONS TO THE PROPERTY FROM LILLINGTON: Buttala Lake Rd - Alpine Rd - Highland Forest Dr - Camden Ct East

PROPOSED USE:

- Sg. Family Dwelling (Size 41 x 46) # of Bedrooms 3 # Baths 2 1/2 Basement (w/wo bath) N/A Garage 24x24 Deck N/A
- Multi-Family Dwelling No. Units \_\_\_\_\_ No. Bedrooms/Unit \_\_\_\_\_
- Manufactured Home (Size x) # of Bedrooms \_\_\_\_\_ Garage \_\_\_\_\_ Deck \_\_\_\_\_

Comments: \_\_\_\_\_

- Number of persons per household 3
- Business Sq. Ft. Retail Space \_\_\_\_\_ Type \_\_\_\_\_
- Industry Sq. Ft. \_\_\_\_\_ Type \_\_\_\_\_
- Home Occupation (Size x) # Rooms \_\_\_\_\_ Use \_\_\_\_\_
- Accessory Building (Size x) Use \_\_\_\_\_
- Addition to Existing Building (Size x) Use \_\_\_\_\_
- Other \_\_\_\_\_

Water Supply:  County  Well (No. dwellings \_\_\_\_\_)  Other

Sewage Supply:  New Septic Tank  Existing Septic Tank  County Sewer  Other

Erosion & Sedimentation Control Plan Required? YES  NO

Structures on this tract of land: Single family dwellings 3 Manufactured homes \_\_\_\_\_ Other (specify) \_\_\_\_\_

Property owner of this tract of land own land that contains a manufactured home w/in five hundred feet (500') of tract listed above? YES  NO

| Required Property Line Setbacks: | Minimum    | Actual     | Minimum | Actual     |
|----------------------------------|------------|------------|---------|------------|
| Front                            | <u>35</u>  | <u>40</u>  | Rear    | <u>25</u>  |
| Side                             | <u>10</u>  | <u>22</u>  | Corner  | <u>N/A</u> |
| Nearest Building                 | <u>N/A</u> | <u>N/A</u> |         |            |

If permits are granted I agree to conform to all ordinances and the laws of the State of North Carolina regulating such work and the specifications or plans submitted hereby swear that the foregoing statements are accurate and correct to the best of my knowledge.

[Signature]  
Signature of Applicant

6/30/04  
Date

\*\*This application expires 6 months from the date issued if no permits have been issued\*\*

A RECORDED SURVEY PLAT AND RECORDED DEED ARE REQUIRED WHEN APPLYING FOR A LAND USE PERMIT

203 7/7 S

1" = 30'

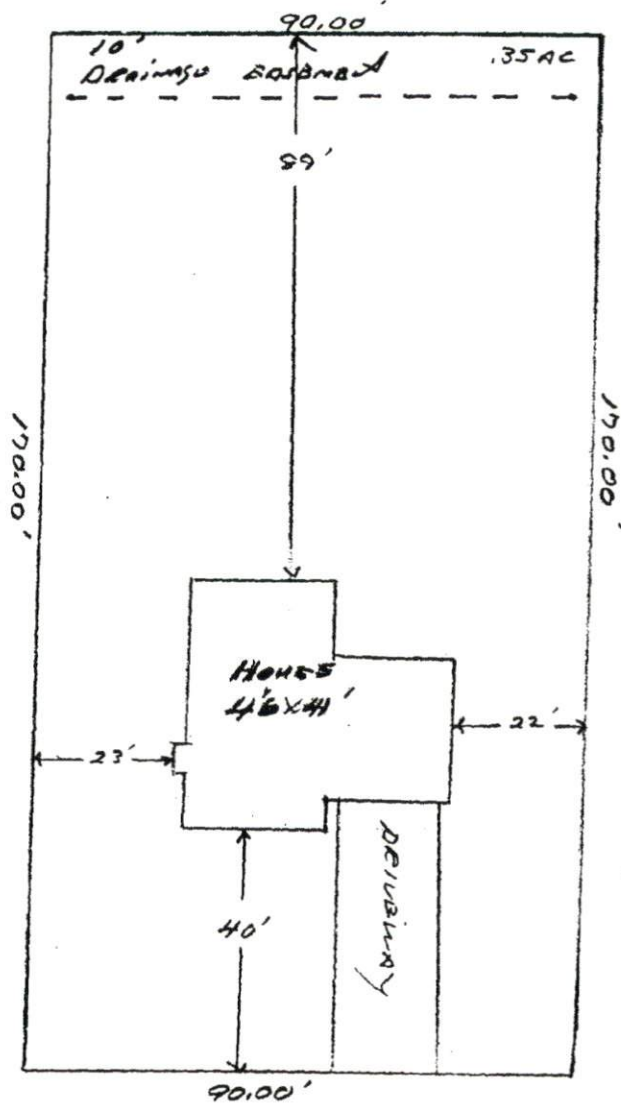

CAMDEN COURT EAST

WM. KENT PIERCE, INC

Lot # 128 Highland Forest

(The Austin - Plan)

SITE PLAN APPROVAL  
DISTRICT AA&R USE SE0  
#BEDROOMS 3  
6-30-04  
ZONING ADMINISTRATOR