

601 DOVER CT EAST

Initial Application Date: 6/29/04

Application # 045009824

COUNTY OF HARNETT LAND USE APPLICATION

Central Permitting

102 E. Front Street, Lillington, NC 27546

Phone: (910) 893-4759

Fax: (910) 893

LANDOWNER: Wm Kent PIERCE JR Mailing Address: P.O. BOX 42535
City: FAYETTEVILLE State: NC Zip: 28309 Phone #: 910 424-1294

APPLICANT: SNMB Mailing Address: _____
City: _____ State: _____ Zip: _____ Phone #: _____

PROPERTY LOCATION: SR #: 1141 SR Name: Alpine Rd.
Parcel: 03958711-0020-61 PIN: 9596-09-4281.000
Zoning: R20R Subdivision: Highland Forest Lot #: 120 Lot Size: 35
Flood Plain: X Parcel: 0025D Watershed: X Deed Book/Page: 01867/009 Plat Book/Page: 2003-1165

DIRECTIONS TO THE PROPERTY FROM LILLINGTON: Buttala Lake Rd - Alpine Rd.
Highland Forest Dr - DOVER CT EAST

PROPOSED USE:

- Sg. Family Dwelling (Size 36x50) # of Bedrooms 3 # Baths 2 1/2 Basement (w/wo bath) n/a Garage 24x24 Deck 2x14
- Multi-Family Dwelling No. Units _____ No. Bedrooms/Unit _____
- Manufactured Home (Size x) # of Bedrooms _____ Garage _____ Deck _____
- Comments: _____
- Number of persons per household _____
- Business Sq. Ft. Retail Space _____ Type _____
- Industry Sq. Ft. _____ Type _____
- Home Occupation (Size x) # Rooms _____ Use _____
- Accessory Building (Size x) Use _____
- Addition to Existing Building (Size x) Use _____
- Other _____

Water Supply: County Well (No. dwellings _____) Other

Sewage Supply: New Septic Tank Existing Septic Tank County Sewer Other

Erosion & Sedimentation Control Plan Required? YES NO

Structures on this tract of land: Single family dwellings 3 Manufactured homes _____ Other (specify) _____

Property owner of this tract of land own land that contains a manufactured home w/in five hundred feet (500') of tract listed above? YES NO

Required Property Line Setbacks:	Minimum	Actual	Minimum	Actual
Front	<u>35</u>	<u>40</u>	Rear	<u>25</u>
Side	<u>10</u>	<u>19</u>	Corner	<u>n/a</u>
Nearest Building	<u>n/a</u>	<u>n/a</u>		

If permits are granted I agree to conform to all ordinances and the laws of the State of North Carolina regulating such work and the specifications or plans submit hereby swear that the foregoing statements are accurate and correct to the best of my knowledge.

Wm Kent Pierce Jr
Signature of Applicant

6/29/04
Date

This application expires 6 months from the date issued if no permits have been issued

A RECORDED SURVEY PLAT AND RECORDED DEED ARE REQUIRED WHEN APPLYING FOR A LAND USE PERMIT

1948/29 5

1" = 30'

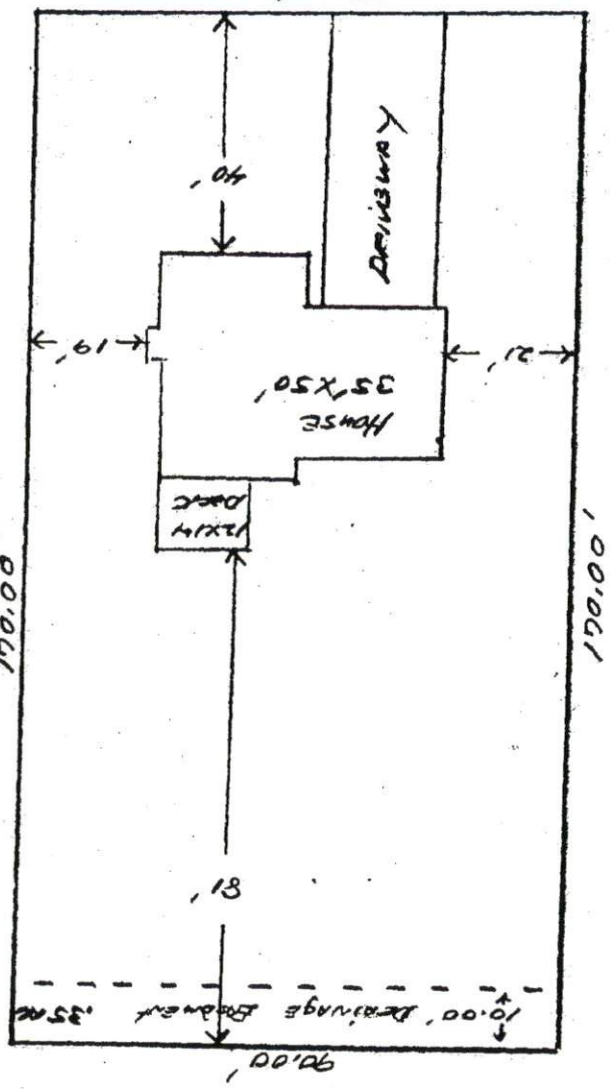

90.00' DOWNE COURT EAST

Wm. Kent Pierce, Inc.
Lot # 120 Highland Forest
(The Oxford - Plan)

SITE PLAN APPROVAL:
DISTRICT RA20B USE SFD
#BEDROOMS 3
02904 [Signature]
ZONING ADMINISTRATOR