

Property ID:  
 Lot #:  
 File #:  
 Code:

### SOIL/SITE EVALUATION for ON-SITE WASTEWATER SYSTEM

Owner: *Kent Pierce*

Applicant: *K.P.*

Address:

Date Evaluated:

Proposed Facility: *3BR*

Design Flow (.1949): *260*

Property Size:

Location of Site: *Highland Park*

Property Recorded:

- Water Supply:  Public     Individual     Well     Spring     Other
- Valuation Method:  Auger Boring     Pit     Cut
- Type of Wastewater:  Sewage     Industrial Process     Mixed

1940 Landscape Position/ Slope%	Horizon Depth (IN.)	SOIL MORPHOLOGY .1941		OTHER PROFILE FACTORS				Profile Class & LTAR
		.1941 Structure/ Texture	.1941 Consistence Mineralogy	.1942 Soil Wetness/ Color	.1943 Soil Depth (IN.)	.1956 Sapro Class	.1944 Restr Horiz	
	<i>024</i>	<i>SL</i>	<i>FR/6R</i>	<i>10YR 8/6</i>	<i>4Y</i>			
	<i>2448</i>	<i>SCL</i>	<i>FR/6R</i>	<i>10YR 6/6</i>				
	<i>024</i>	<i>SL</i>	<i>FR/6R</i>	<i>10YR 8/6</i>	<i>4X</i>			
	<i>2448</i>	<i>SCL</i>	<i>FR/6R</i>	<i>10YR 6/6</i>				
	<i>024</i>	<i>SL</i>	<i>FR/6R</i>	<i>10YR 8/6</i>	<i>4Y</i>			
	<i>2448</i>	<i>SCL</i>	<i>FR/6R</i>	<i>10YR 6/6</i>				
	<i>024</i>	<i>SL</i>	<i>FR/6R</i>	<i>10YR 8/6</i>	<i>4X</i>			
	<i>2448</i>	<i>SCL</i>	<i>FR/6R</i>	<i>10YR 6/6</i>				
	<i>024</i>	<i>SL</i>	<i>FR/6R</i>	<i>10YR 8/6</i>	<i>4Y</i>			
	<i>2448</i>	<i>SCL</i>	<i>FR/6R</i>	<i>10YR 6/6</i>				
	<i>024</i>	<i>SL</i>	<i>FR/6R</i>	<i>10YR 8/6</i>	<i>4Y</i>			
	<i>2448</i>	<i>SCL</i>	<i>FR/6R</i>	<i>10YR 6/6</i>				

Description	Initial System	Repair System
Available Space (.1945)		
System Type(s)	<i>Ceramel</i>	<i>LPP</i>
Site LTAR	<i>.6</i>	<i>.7</i>

Other Factors (.1946): \_\_\_\_\_  
 Site Classification (.1948): \_\_\_\_\_  
 Evaluated By: *Jud*  
 Others Present: \_\_\_\_\_

*Change to 25% Red. System To 25% per*

*Notes by Kent*

COMMENTS: \_\_\_\_\_  
 \_\_\_\_\_  
 \_\_\_\_\_

<u>LANDSCAPE POSITIONS</u>	<u>GROUP</u>	<u>TEXTURES</u>	<u>.1955 LTAR</u>	<u>CONSISTENCE MOIST</u>	<u>WET</u>
R-RIDGE	I	S-SAND	1.2 - 0.8	VFR-VERY FRIABLE FR-FRIABLE FI-FIRM VFI-VERY FIRM EFI-EXTREMELY FIRM	NS-NON-STICKY SS-SLIGHTLY STICKY S-STICKY VS-VERY STICKY NP-NON-PLASTIC SP-SLIGHTLY STICKY P-PLASTIC VP-VERY PLASTIC
S-SHOULDER SLOPE		LS-LOAMY SAND			
L-LINEAR SLOPE	II	SL-SANDY LOAM	0.8 - 0.6		
FS-FOOT SLOPE		L-LOAM			
N-NOSE SLOPE	III	SI-SILT-	0.6 - 0.3		
H-HEAD SLOPE		SIL-SILT LOAM			
CC-CONCLAVE SLOPE		CL-CLAY LOAM			
CV-CONVEX SLOPE		SCL-SANDY CLAY LOAM			
T-TERRACE	IV	SIC-SILTY CLAY	0.4 - 0.1		
FP-FLOOD PLAN		C-CLAY			
		SC-SANDY CLAY			

STRUCTURE  
 SG-SINGLE GRAIN  
 M-MASSIVE  
 CR-CRUMB  
 GR-GRANULAR  
 SBK-SUBANGULAR BLOCKY  
 ABK-ANGULAR BLOCKY  
 PL-PLATY  
 PR-PRISMATIC

MINERALOGY  
 SLIGHTLY EXPANSIVE  
 EXPANSIVE

Show profile locations and other site features (dimensions, reference or benchmark, and North).

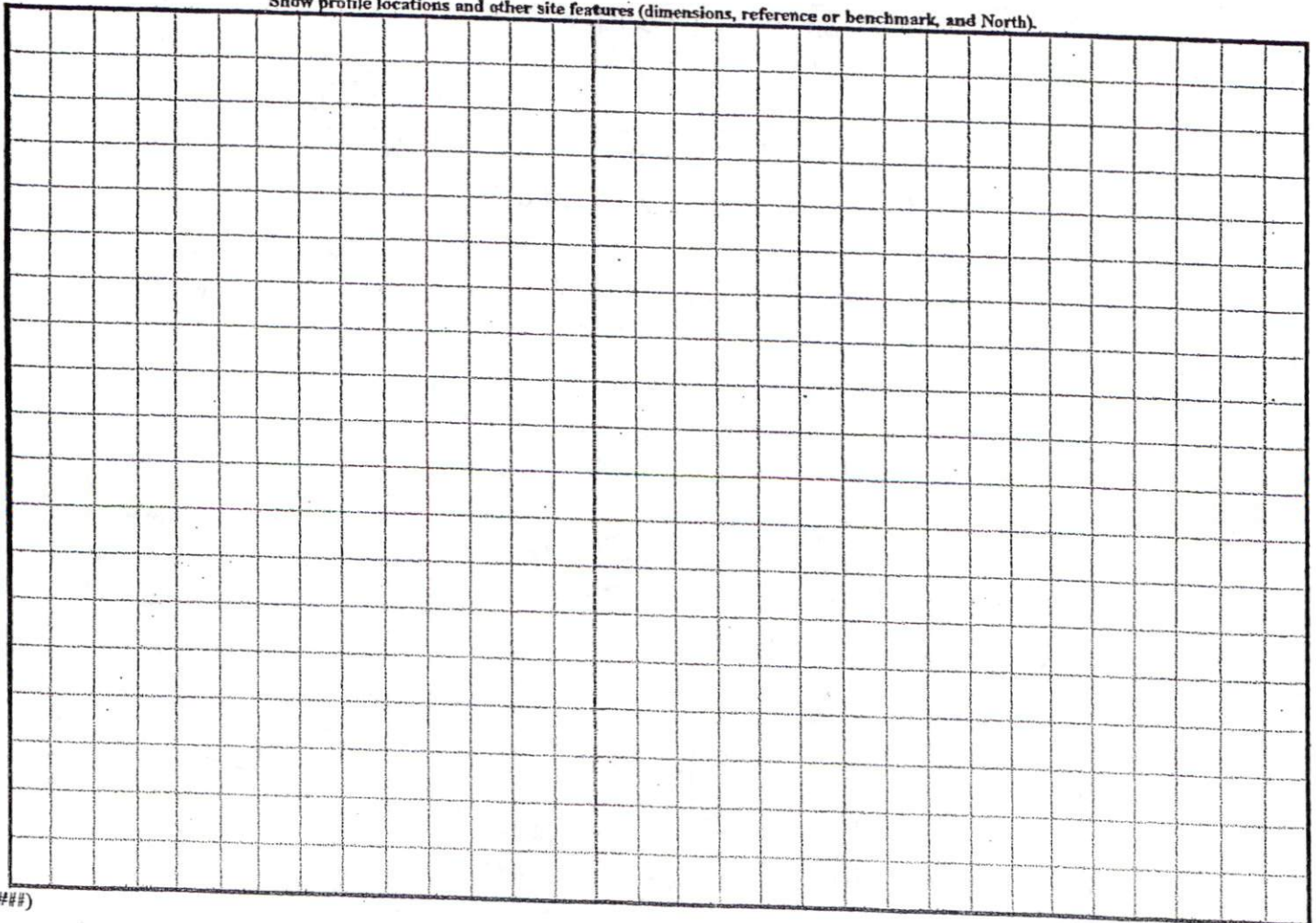

1" = 30'

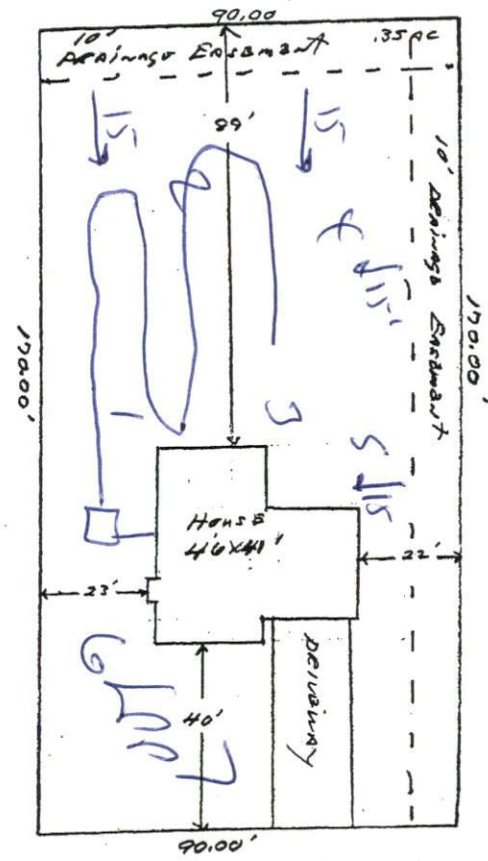

SITE PLAN APPROVAL  
 DISTRICT RAEOR USE SE1  
 #BEDROOMS 3  
[Signature]  
 ZONING ADMINISTRATOR

DOVER COURT EAST

Wm. KENT PIERCE INC.

Lot #121 Highland Forest

(The Austin - Plan)